



15-UP ROAD GLIDE/ULTRA

INSTALLATION INSTRUCTIONS
REV 006



15-UP ROAD GLIDE/ULTRA INSTALLATION INSTRUCTIONS

KIT PARTS	3
BASE KIT PARTS:	3
WITH AMPLIFIER	3
15-18 Misc.	3
PREPARE THE BIKE	4
PREPARING THE SPEAKER ENCLOSURES.....	5
INSTALLATION OF TOUR PACK SPEAKERS.....	8
INSTALLATION OF AMPLIFIER	9
ARC AUDIO AMPLIFIER WIRING AND SETTINGS	10
MOTO720 STOCK HD HEAD UNIT - SINISTER FAIRING KIT NO FLASH	11
MOTO720 STOCK HD HEAD UNIT - SINISTER FAIRING KIT + LIDS NO FLASH	12
MOTO720 STOCK HD HEAD UNIT - SINISTER FAIRING KIT + CRAZY 8's NO FLASH	13
MOTO720 STOCK HD HEAD UNIT - SINISTER FAIRING KIT + ULTRA REARS NO FLASH.....	14
MOTO720 STOCK HD HEAD UNIT - SINISTER FAIRING KIT WITH FLASH	15
MOTO720 STOCK HD HEAD UNIT - SINISTER FAIRING KIT + LIDS WITH FLASH	16
MOTO720 STOCK HD HEAD UNIT - SINISTER FAIRING KIT + CRAZY 8's WITH FLASH	17
MOTO720 STOCK HD HEAD UNIT - SINISTER FAIRING KIT + ULTRA REARS WITH FLASH	18
MOTO720 SOUNDSTREAM HDHU14+ HEAD UNIT - SINISTER FAIRING KIT.....	19
MOTO720 SOUNDSTREAM HDHU14+ HEAD UNIT - SINISTER FAIRING KIT + LIDS	20
MOTO720 SOUNDSTREAM HDHU14+ HEAD UNIT - SINISTER FAIRING KIT + CRAZY 8's.....	21
MOTO720 SOUNDSTREAM HDHU14+ HEAD UNIT - SINISTER FAIRING KIT + ULTRA REARS	22
MOTO720 SOUNDSTREAM HDHU14Si HEAD UNIT - SINISTER FAIRING KIT.....	23
MOTO720 SOUNDSTREAM HDHU14Si HEAD UNIT - SINISTER FAIRING KIT + LIDS	24
MOTO720 SOUNDSTREAM HDHU14Si HEAD UNIT - SINISTER FAIRING KIT + CRAZY 8's	25
MOTO720 SOUNDSTREAM HDHU14Si HEAD UNIT - SINISTER FAIRING KIT + ULTRA REARS	26
TESTING AND TUNING	27
EQUALIZER SETTINGS.....	28
FINISHING THE INSTALLATION	29

KIT PARTS

BASE KIT PARTS:

- 2 - SinisterSound Woofers
- 2 - SinisterSound Tweeter assemblies
- 2 - Woofer/Tweeter leads
- 2 - Ports
- 1 - Set of drill templates and wiring spacers

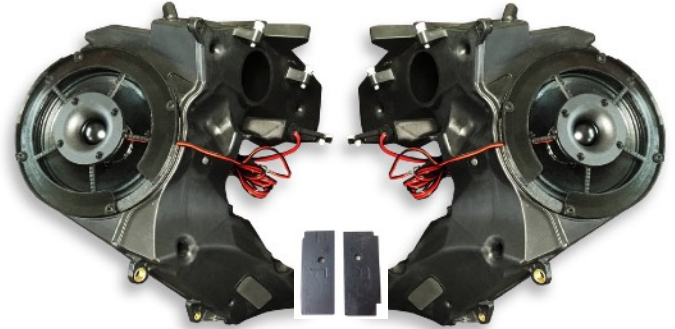

Enclosures for illustration only. Not included.

WITH AMPLIFIER

- 1 - Amplifier
- 1 - SinisterSound power and ground cable



15-18 MISC.

- 1 - SinisterSound Line Level Adapter
- 1 - RCA Cable
- * Not required with 19-UP models or bikes that will be flashed.



PREPARE THE BIKE

1

Remove speaker grills first.



2

Remove the speaker enclosures, radio and any other audio equipment.



3

Remove the old speakers from the enclosures saving the screws and set aside speaker leads with the Molex connectors.

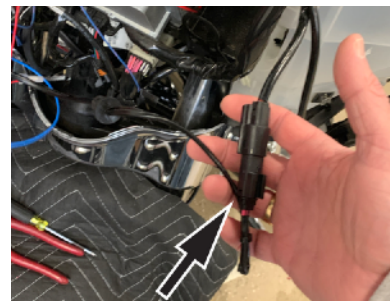

4

Remove the seat to expose the battery.

5

Remove the gas tank to expose the cable channel.



PREPARING THE SPEAKER ENCLOSURES

1

Place the drill templates on the enclosures as shown matching R to R and L to L.



2

Using the drill templates, drill pilot holes in the enclosures.



3

Using a 2-3/8" (60mm) hole saw, drill the port holes in the enclosures. Use your pilot holes to guide you. Run the drill in reverse and go slow.



4

Remove the nub from each of the front surfaces.



5

Glue in the port.



6

You will re-use the wire grommets. Carefully cut *one* side of the grommet to remove them from the old speaker leads.



7

Route the SinisterSound woofer leads through the original grommet hole and into the speaker enclosure. Reuse the grommet and seal with glue.



8

Connect the leads to the woofers paying attention to the positive and negative tabs. Mount the woofers and tweeter bridges to the enclosures as shown. *Final alignment will be as shown with the bridge gap toward radio.*



9

Reinstall the enclosures.



10

Install ARC RG15 bracket. The ARC RG15 bracket is made for the ARC Audio Moto720 amp. The bracket can be used for other amps but may require other mounting solutions, ie. velcro, double sided tape or wire-ties. The amp is mounted upside-down under the head unit.

Place the bracket on the main fairing support bracket as shown with the shorter tab towards the rear of the bike.

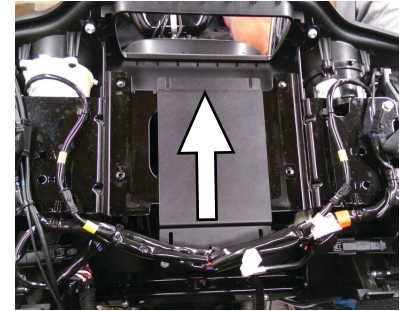

11

Neatly route the wires to the amp and make the speaker connections as shown below per the kit you purchased. Picture shows Channel 1 which is your Clutch Side speaker. Repeat the same for Channel 2 (Brake Side). Make sure to match the positive and negative wires on each side. DO NOT CROSS THE POSITIVES AND NEGATIVES. If your woofers are out of phase, you will have no bass.

Typical Front Fairing Speaker to Amp - CH 1 (Clutch Side)

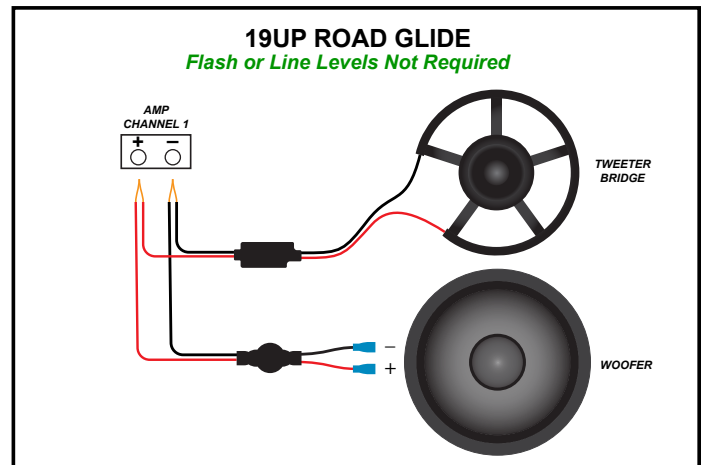
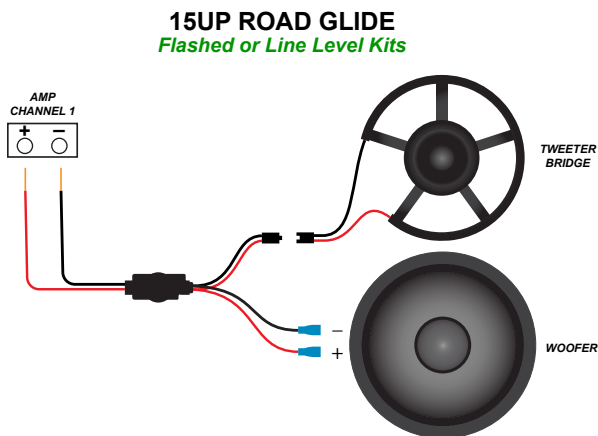

12

You will be making **Temporary** amp connections for testing and tuning as the amp is mounted upside-down under the head unit. Adjustments after final install can not be made.

INSTALLATION OF TOUR PACK SPEAKERS

1

Disconnect and remove the old speakers. Trim back some shrink tube around the speaker wires to allow them to spread. Discard the screws that held the old speakers in place. New larger screws are supplied in the kit.



2

The stack-up will be: Metal Spacer Ring (closest to the pod), Plastic Spacer then Woofer as shown.



3

Connect the speaker leads to the new woofers as shown screws. **DO NOT CROSS THE POSITIVES AND NEGATIVES.** If your woofers are out of phase, you will have no bass.



4

Secure the new Speaker, Spacer and Spacer Ring Assembly with the supplied screws. Drive the NEW supplied screws into new locations in the pods. Do not reuse the existing holes.



x 4 per Speaker



5

Install the supplied grills.

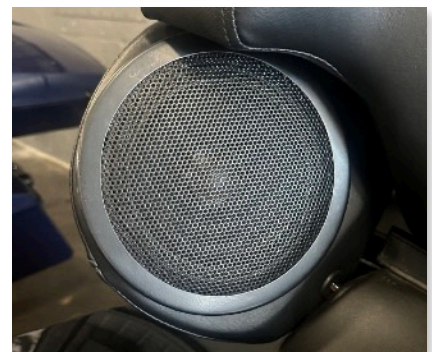

INSTALLATION OF AMPLIFIER

IMAGE BELOW SHOWS TYPICAL WIRING OF A LINE LEVEL ADAPTER
(IF NOT FLASHING THE BIKE)

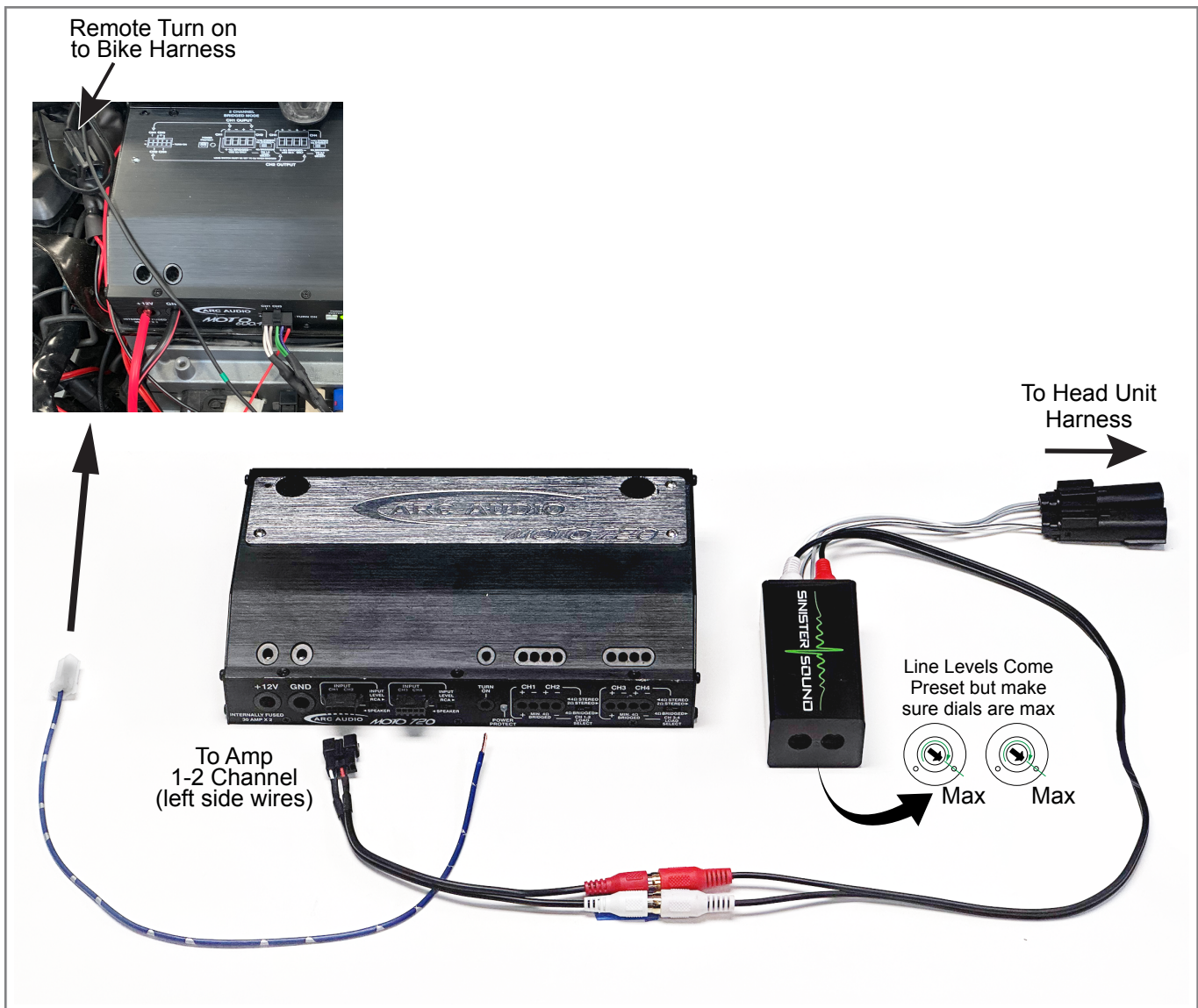

ARC AUDIO AMPLIFIER WIRING AND SETTINGS

ARC AUDIO MOTO720



1. Remove the fuse from the SinisterSound power and ground cable.
2. Connect the SinisterSound power and ground cable to the amplifier and route towards the battery through the cable channel under the tank.

If you are flashing the bike or have a 19UP Kit, continue with Step 3. If you are NOT flashing the bike continue to step 4.

NOTE: For 19-UP bikes, flashing or Line Level Adapters are not required. Continue to Step 3.

3. If you are flashing the bike or you have a 19UP Kit you will not need the Line Level Adapter. Use the Speaker Level In harness to connect to the Molex connector wires (previously removed from the enclosures). Connect the male and female Molex ends. **Skip Step 4.**
4. If you are NOT flashing the bike, connect the Molex connectors of the Line Level Adaptor to Molex connectors from the head unit. Connect the RCA harness from the Line Level Adaptor to the amplifier Input ports. Connect the remote turn on wire to the head unit wiring harness.
5. Make the connections and initial settings per the diagrams on the following pages specific to your application:
 - [Moto720 Stock HD Head Unit - Sinister Fairing Kit No Flash](#)
 - [Moto720 Stock HD Head Unit - Sinister Fairing Kit + Lids No Flash](#)
 - [Moto720 Stock HD Head Unit - Sinister Fairing Kit + Crazy 8's No Flash](#)
 - [Moto720 Stock HD Head Unit - Sinister Fairing Kit + Ultra Rears No Flash](#)
 - [Moto720 Stock HD Head Unit - Sinister Fairing Kit With Flash](#)
 - [Moto720 Stock HD Head Unit - Sinister Fairing Kit + Lids With Flash](#)
 - [Moto720 Stock HD Head Unit - Sinister Fairing Kit + Crazy 8's With Flash](#)
 - [Moto720 Stock HD Head Unit - Sinister Fairing Kit + Ultra Rears With Flash](#)
 - [Moto720 SoundStream Head Unit - Sinister Fairing Kit](#)
 - [Moto720 SoundStream Head Unit - Sinister Fairing Kit + Lids](#)
 - [Moto720 SoundStream Head Unit - Sinister Fairing Kit + Crazy 8's](#)
 - [Moto720 SoundStream Head Unit - Sinister Fairing Kit + Ultra Rears](#)

MOTO720 STOCK HD HEAD UNIT - SINISTER FAIRING KIT NO FLASH

!! Leave 5 bars open on volume
!! Set Bass and Treble to zero
!! Turn Speed Volume OFF

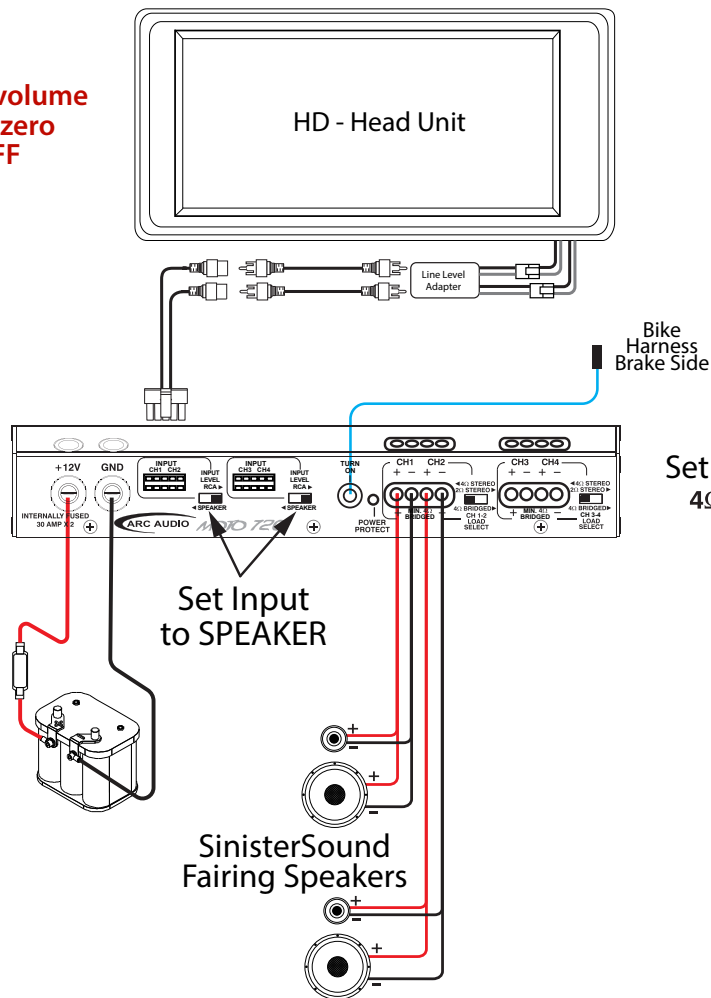

Line Levels Come Preset but make sure dials are max



Set Load Selects
4Ω STEREO

Amp Settings

With Line Levels Only

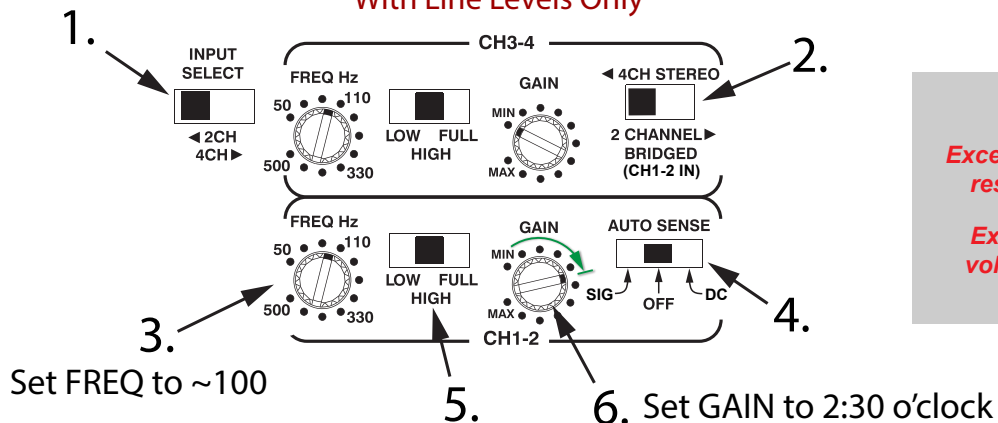

WARNING!

Exceeding these gain settings will result in equipment damage!

Exceeding 5 open bars on the volume on head unit will result in equipment damage!

MOTO720 STOCK HD HEAD UNIT - SINISTER FAIRING KIT + LIDS NO FLASH

!! Leave 5 bars open on volume
!! Set Bass and Treble to zero
!! Turn Speed Volume OFF

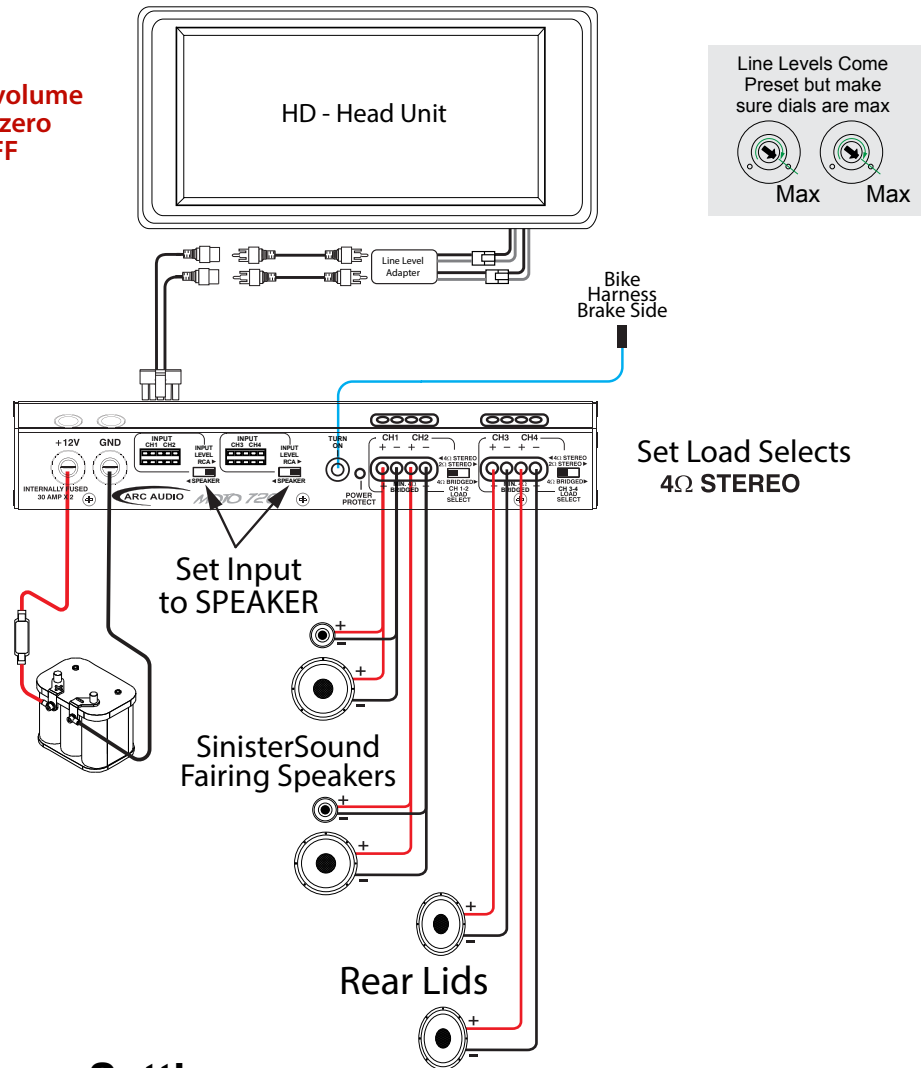

Line Levels Come
Preset but make
sure dials are max



Amp Settings With Line Levels Only

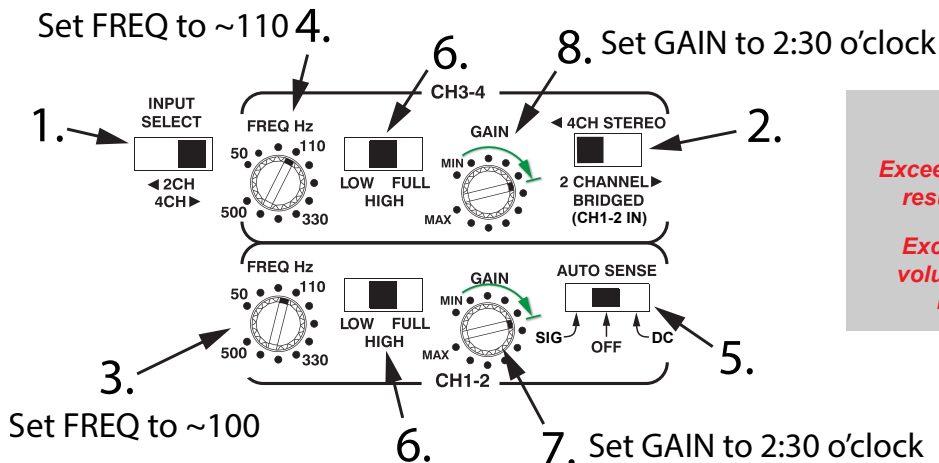

WARNING!

Exceeding these gain settings will
result in equipment damage!

Exceeding 5 open bars on the
volume on head unit will result
in equipment damage!

MOTO720 STOCK HD HEAD UNIT - SINISTER FAIRING KIT + CRAZY 8'S NO FLASH

!! Leave 5 bars open on volume
!! Set Bass and Treble to zero
!! Turn Speed Volume OFF

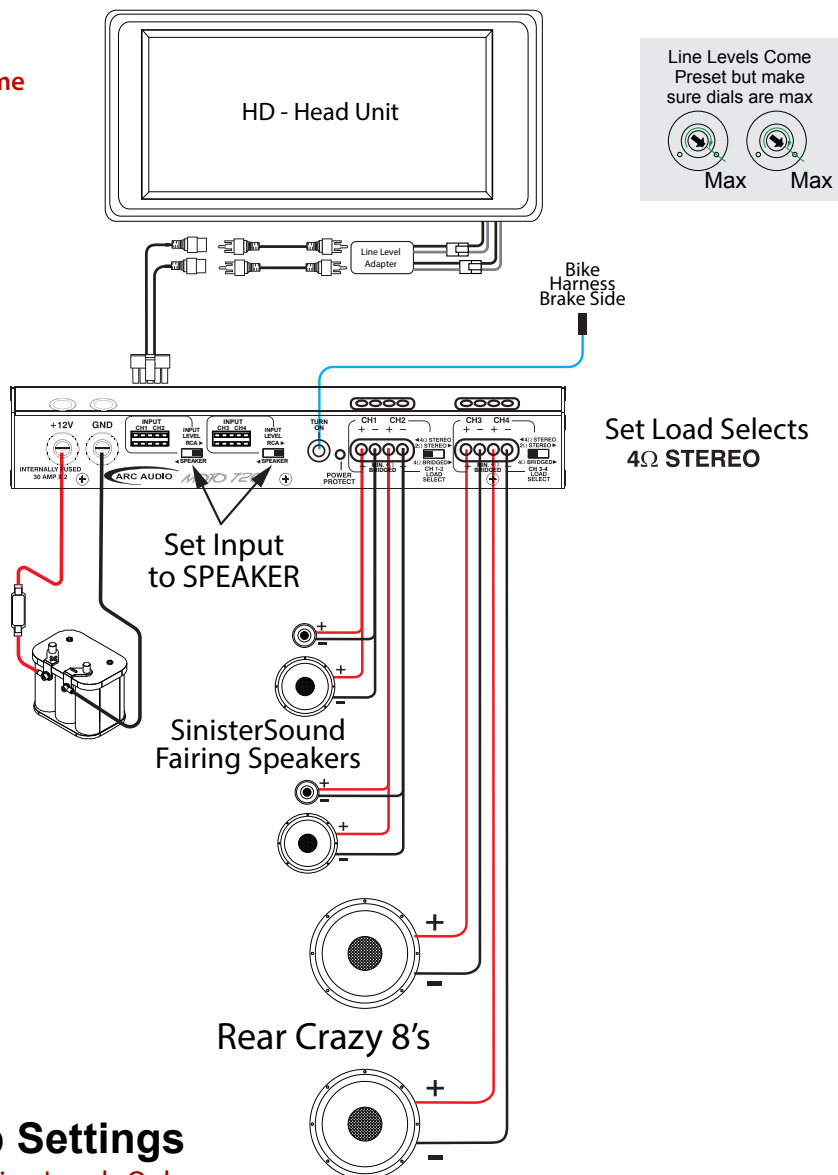

Amp Settings

With Line Levels Only

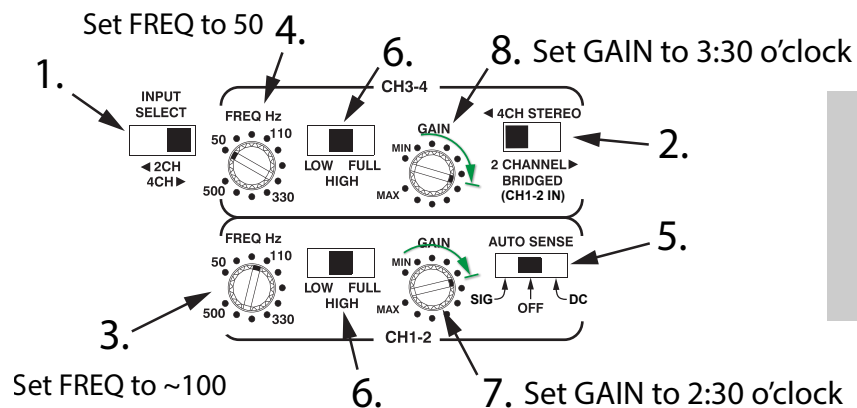

WARNING!

Exceeding these gain settings will result in equipment damage!

Exceeding 5 open bars on the volume on head unit will result in equipment damage!

MOTO720 STOCK HD HEAD UNIT - SINISTER FAIRING KIT + ULTRA REARS NO FLASH

!! Leave 5 bars open on volume
!! Set Bass and Treble to zero
!! Turn Speed Volume OFF

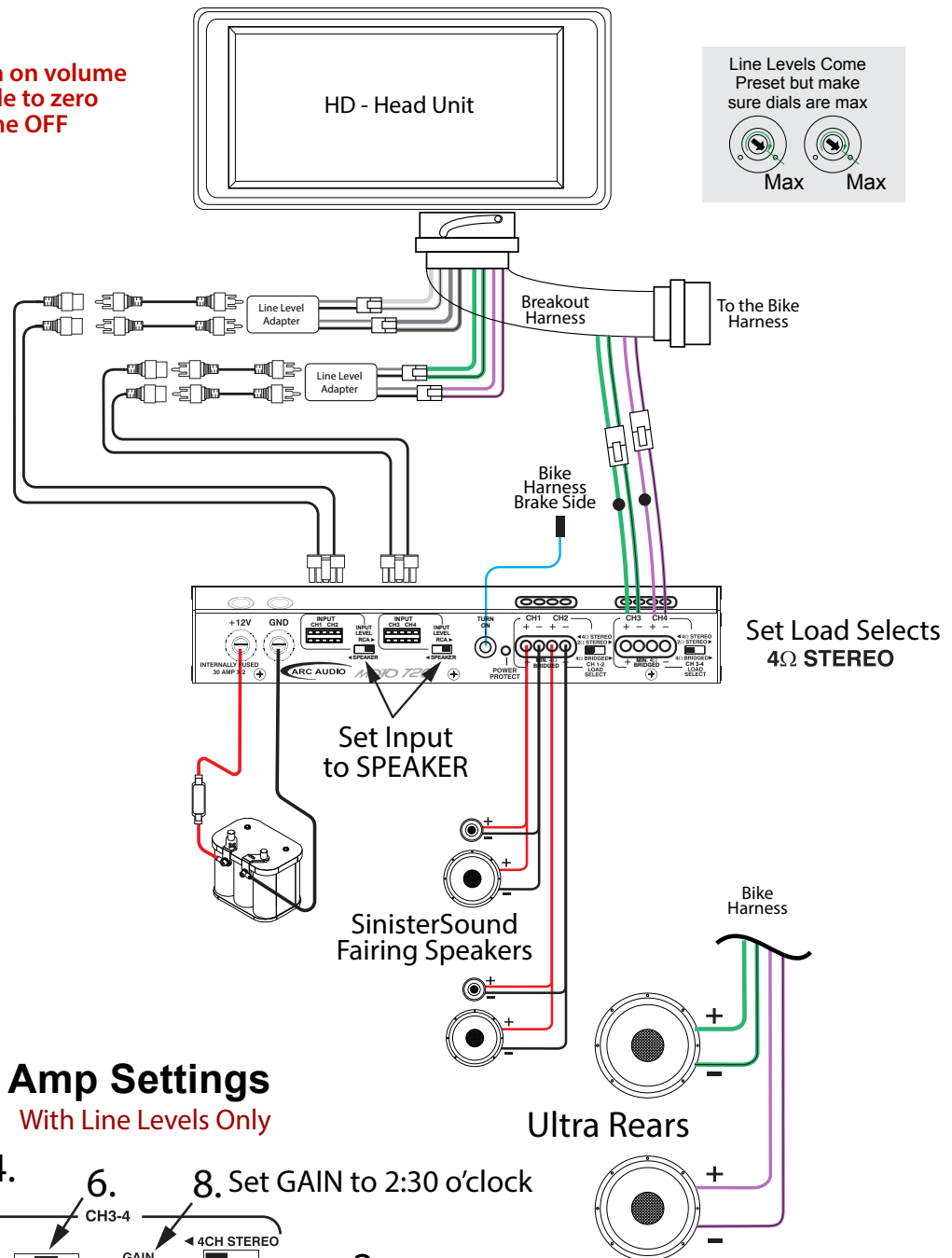

Amp Settings

With Line Levels Only

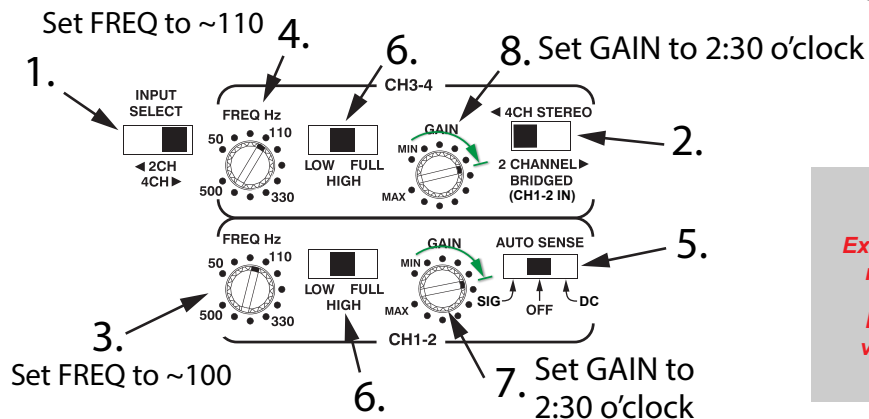

WARNING!

Exceeding these gain settings will result in equipment damage!

Exceeding 5 open bars on the volume on head unit will result in equipment damage!

MOTO720 STOCK HD HEAD UNIT - SINISTER FAIRING KIT WITH FLASH

!! Leave 5 bars open on volume
!! Set Bass and Treble to zero
!! Turn Speed Volume OFF

FLASH

The correct flash for our system is:
 Upper Fairing, Rear Pod, No Amp

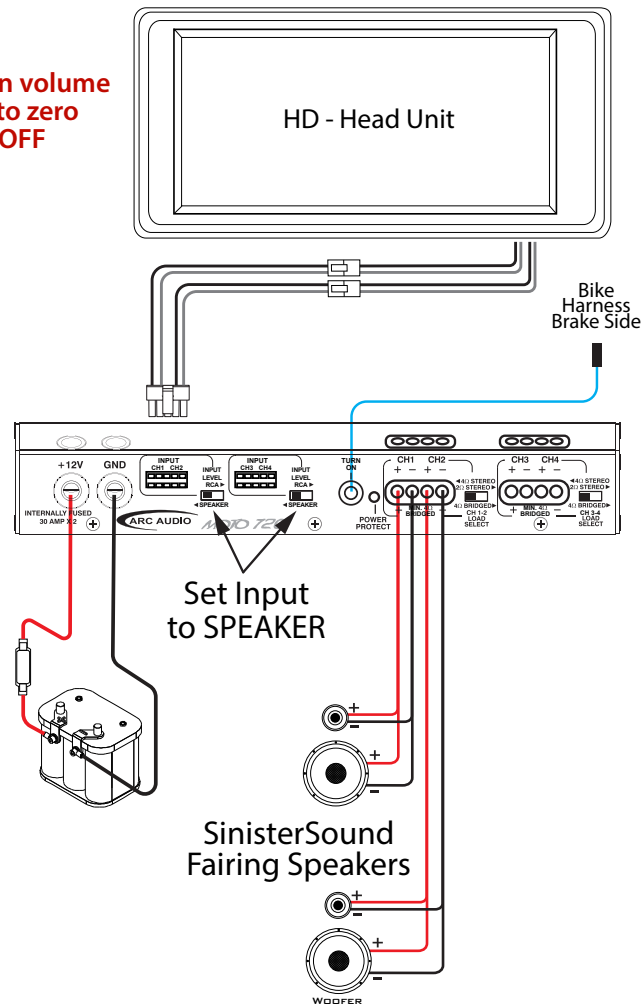

Set Load Selects
4Ω STEREO

Set Input
 to SPEAKER

SinisterSound
 Fairing Speakers

Amp Settings

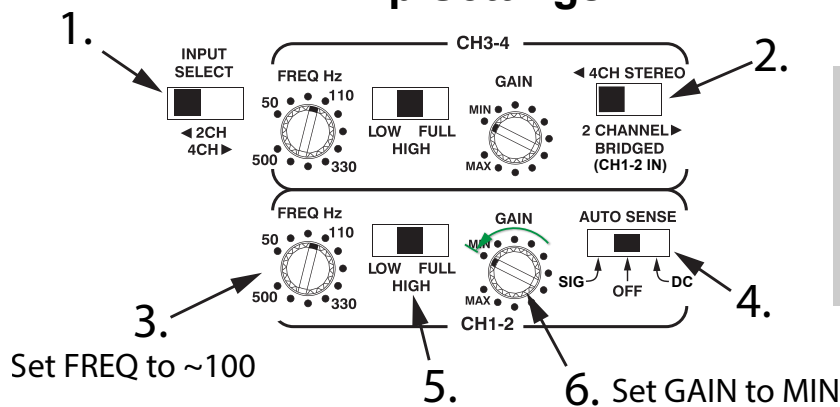

WARNING!

Exceeding these gain settings will
 result in equipment damage!

Exceeding 5 open bars on the
 volume on head unit will result in
 equipment damage!

MOTO720 STOCK HD HEAD UNIT - SINISTER FAIRING KIT + LIDS WITH FLASH

!! Leave 5 bars open on volume
!! Set Bass and Treble to zero
!! Turn Speed Volume OFF

FLASH

The correct flash for our system is:
Upper Fairing, Rear Pod, No Amp

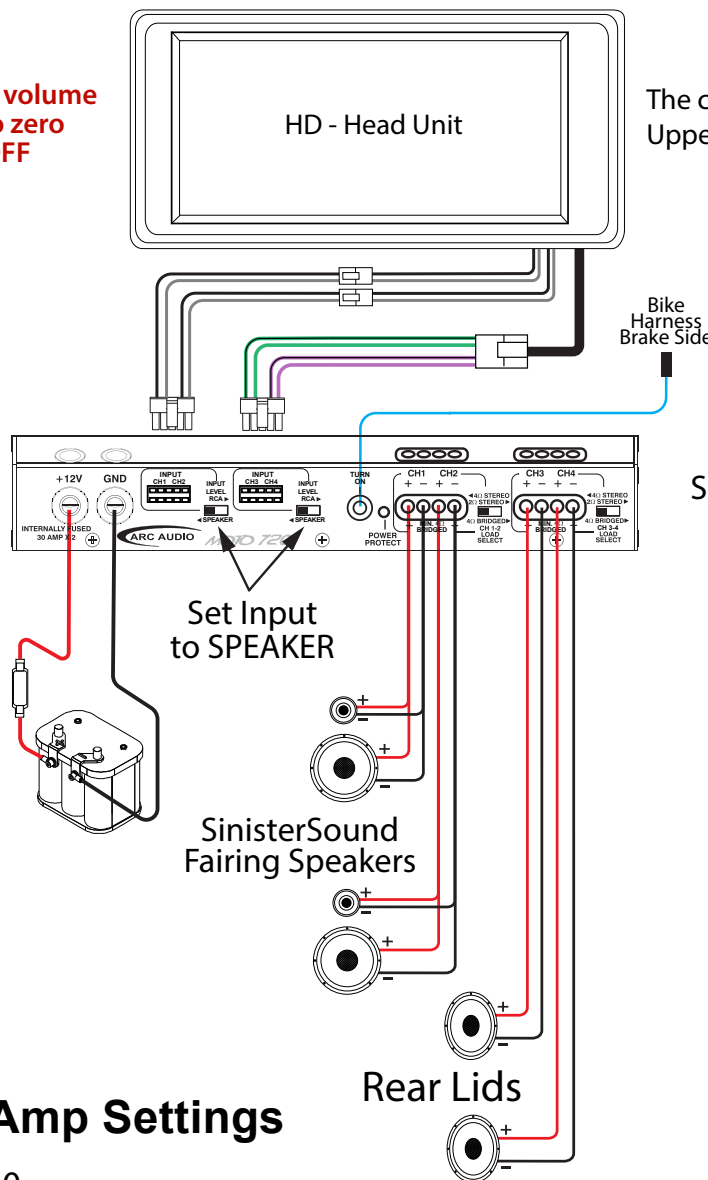

Set Load Selects
4Ω STEREO

Amp Settings

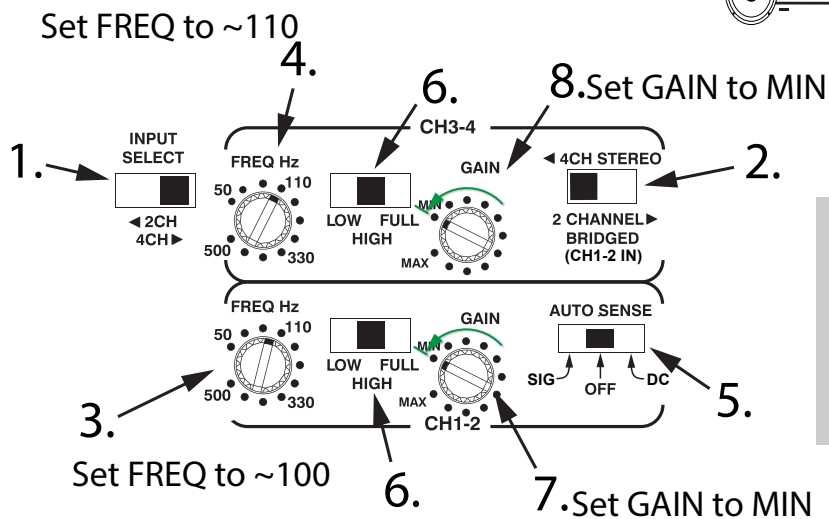

WARNING!

Exceeding these gain settings will
result in equipment damage!

Exceeding 5 open bars on the
volume on head unit will result
in equipment damage!

MOTO720 STOCK HD HEAD UNIT - SINISTER FAIRING KIT + CRAZY 8'S WITH FLASH

!! Leave 5 bars open on volume
!! Set Bass and Treble to zero
!! Turn Speed Volume OFF

FLASH

The correct flash for our system is:
Upper Fairing, Rear Pod, No Amp

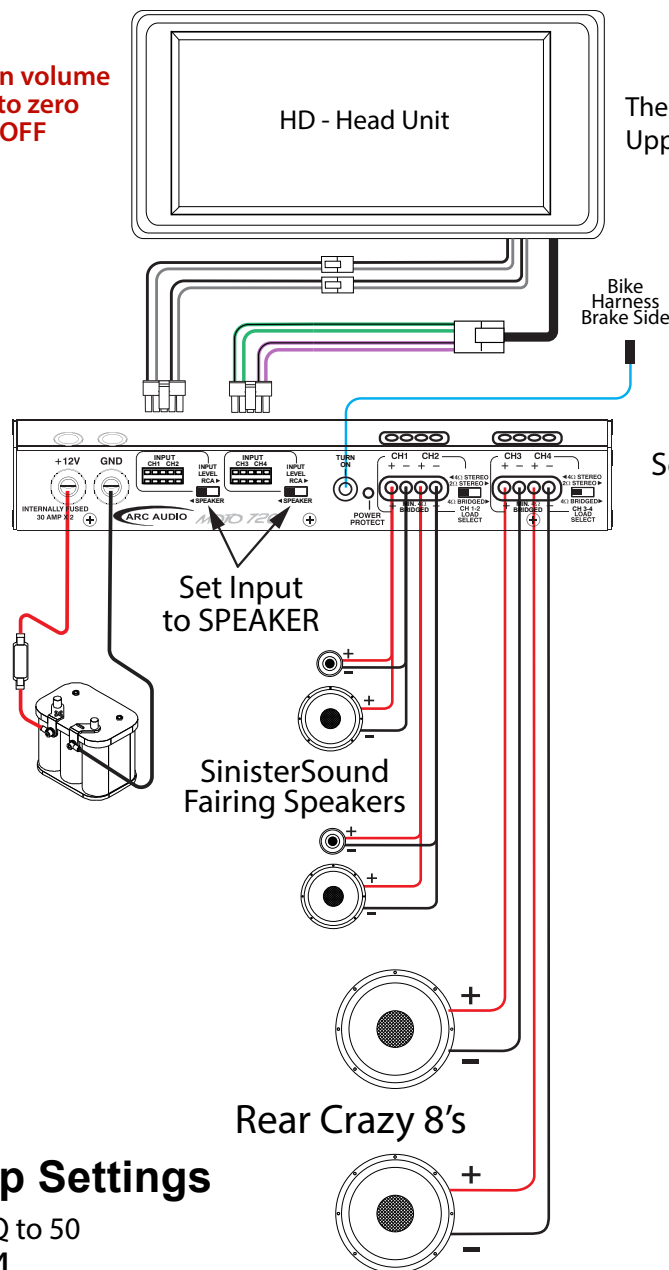

Amp Settings

Set FREQ to 50

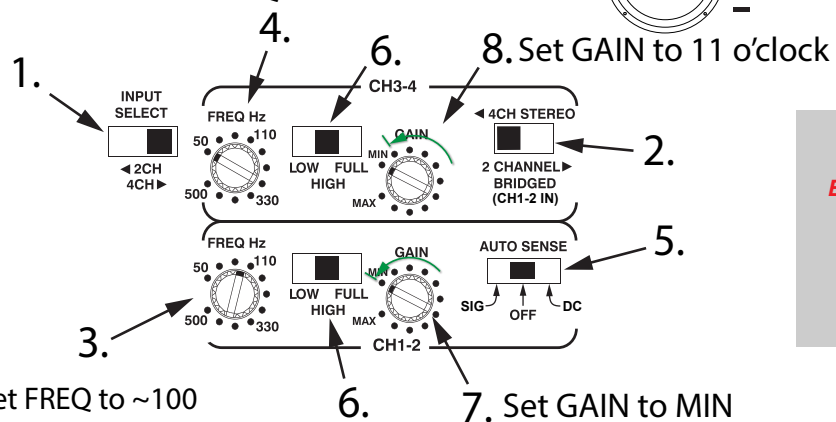

WARNING!
Exceeding these gain settings will
result in equipment damage!

Exceeding 5 open bars on the
volume on head unit will result
in equipment damage!

MOTO720 STOCK HD HEAD UNIT - SINISTER FAIRING KIT + ULTRA REARS WITH FLASH

!! Leave 5 bars open on volume
!! Set Bass and Treble to zero
!! Turn Speed Volume OFF

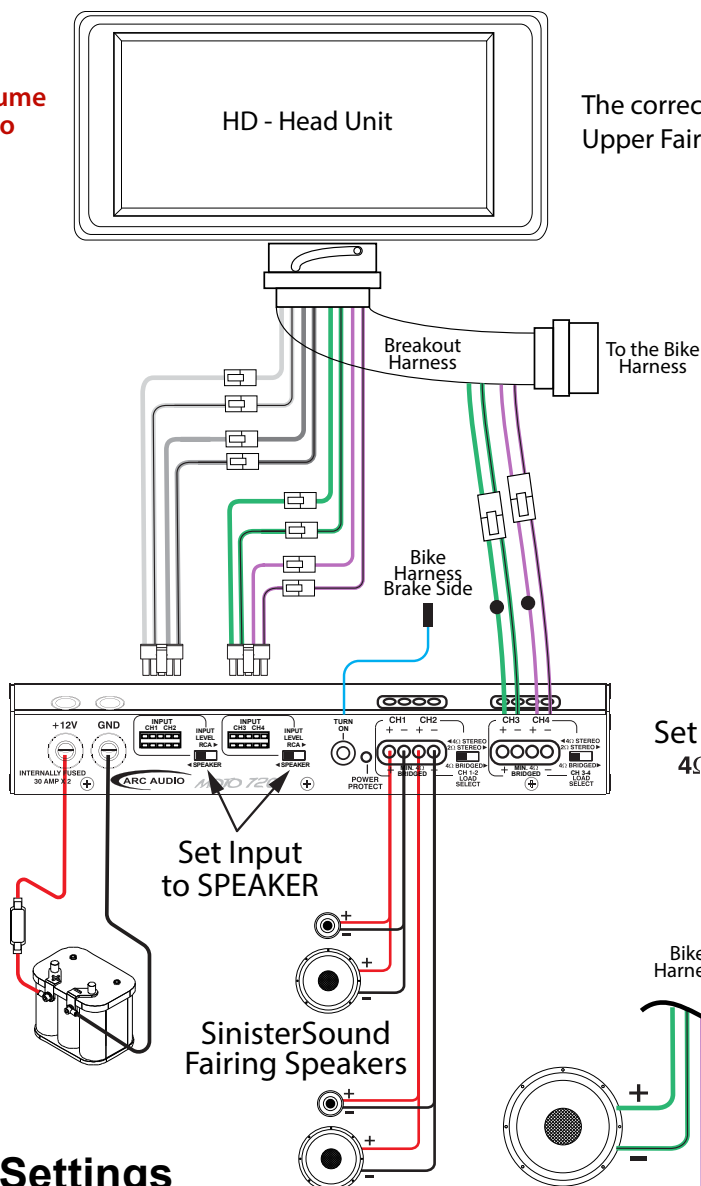

FLASH

The correct flash for our system is:
Upper Fairing, Rear Pod, No Amp

Set Load Selects
4Ω STEREO

Set Input
to SPEAKER

SinisterSound
Fairing Speakers

Bike
Harness

Ultra Rears

Amp Settings

Set FREQ to ~110

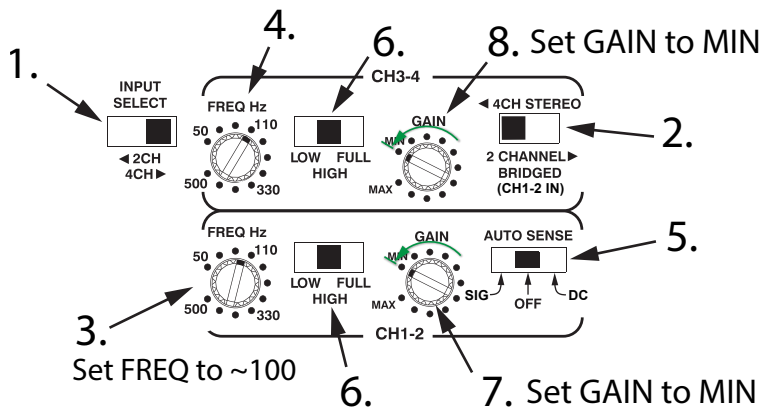

WARNING!

Exceeding these gain settings will
result in equipment damage!

Exceeding 5 open bars on the
volume on head unit will result
in equipment damage!

MOTO720 SOUNDSTREAM HDHU14+ HEAD UNIT - SINISTER FAIRING KIT

!! Do Not exceed 40 on volume

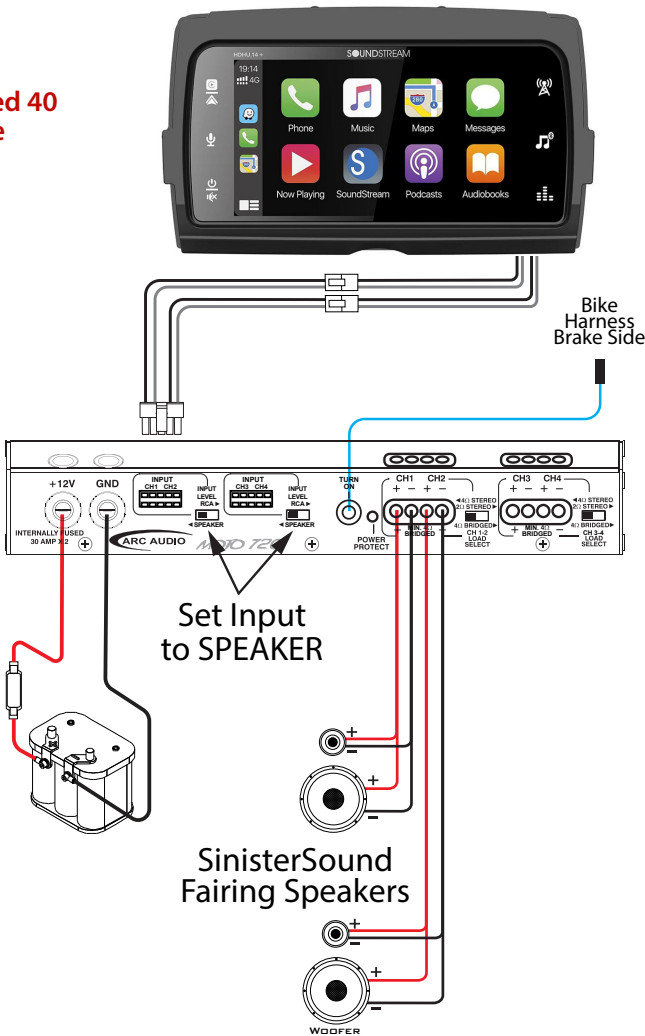

Amp Settings

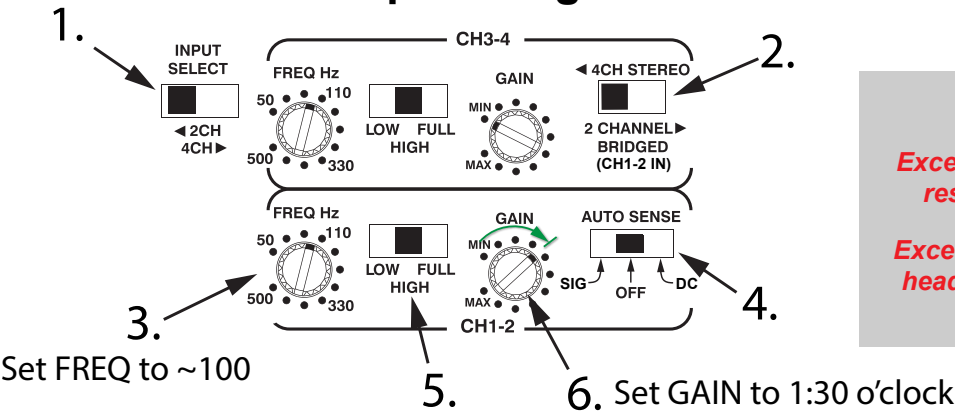

WARNING!

Exceeding these gain settings will result in equipment damage!

Exceeding the volume of 40 on the head unit will result in equipment damage!

MOTO720 SOUNDSTREAM HDHU 14+ HEAD UNIT - SINISTER FAIRING KIT + LIDS

!! Do Not exceed 40 on volume

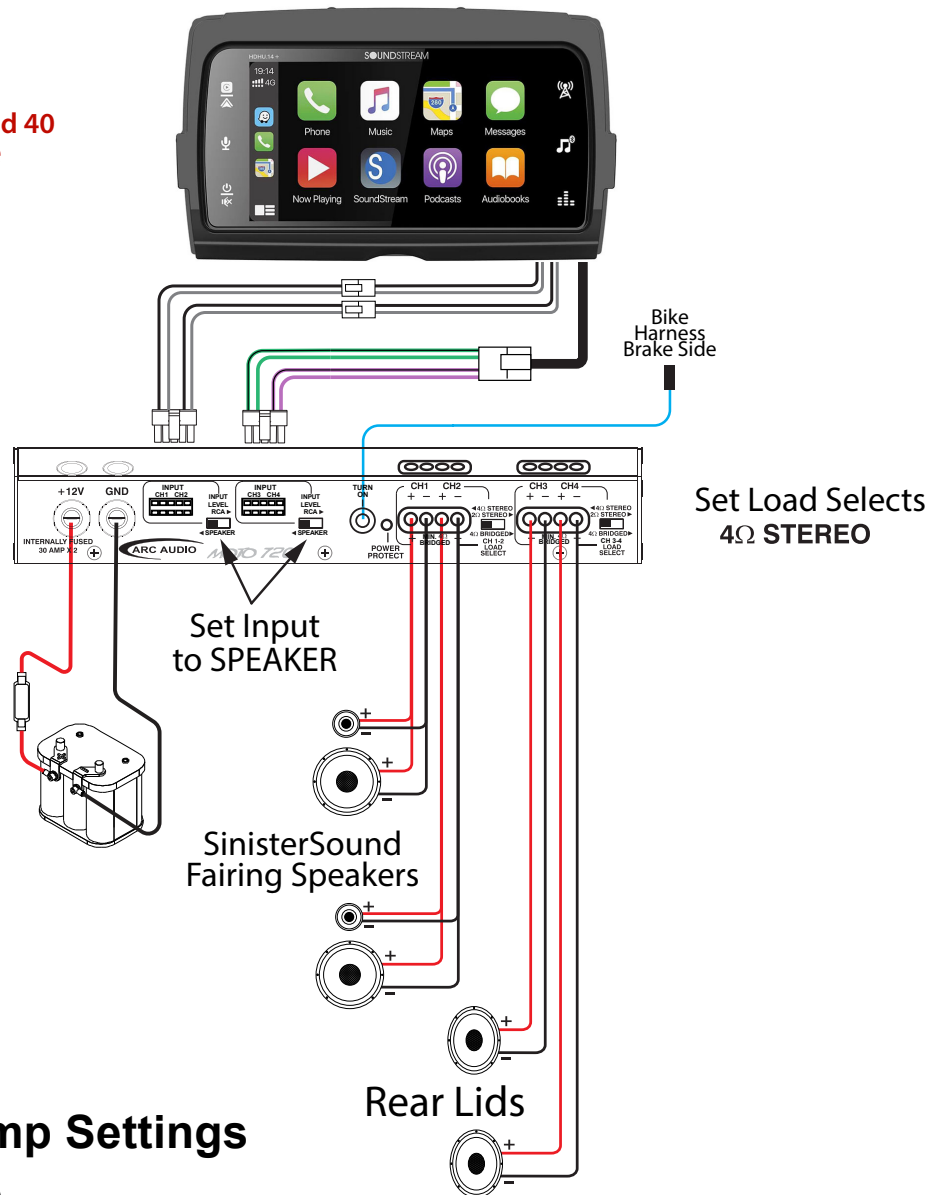

Amp Settings

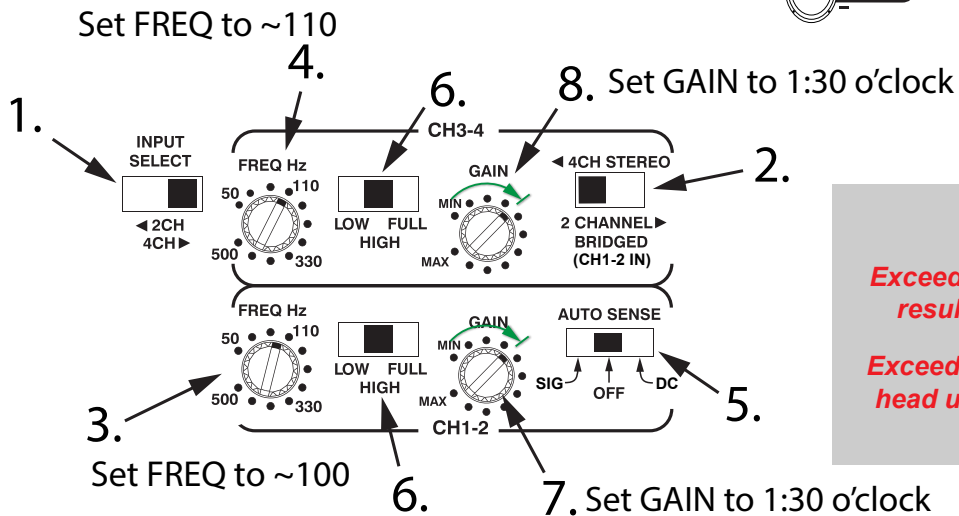

WARNING!

Exceeding these gain settings will result in equipment damage!

Exceeding the volume of 40 on the head unit will result in equipment damage!

MOTO720 SOUNDSTREAM HDHU14+ HEAD UNIT - SINISTER FAIRING KIT + CRAZY 8'S

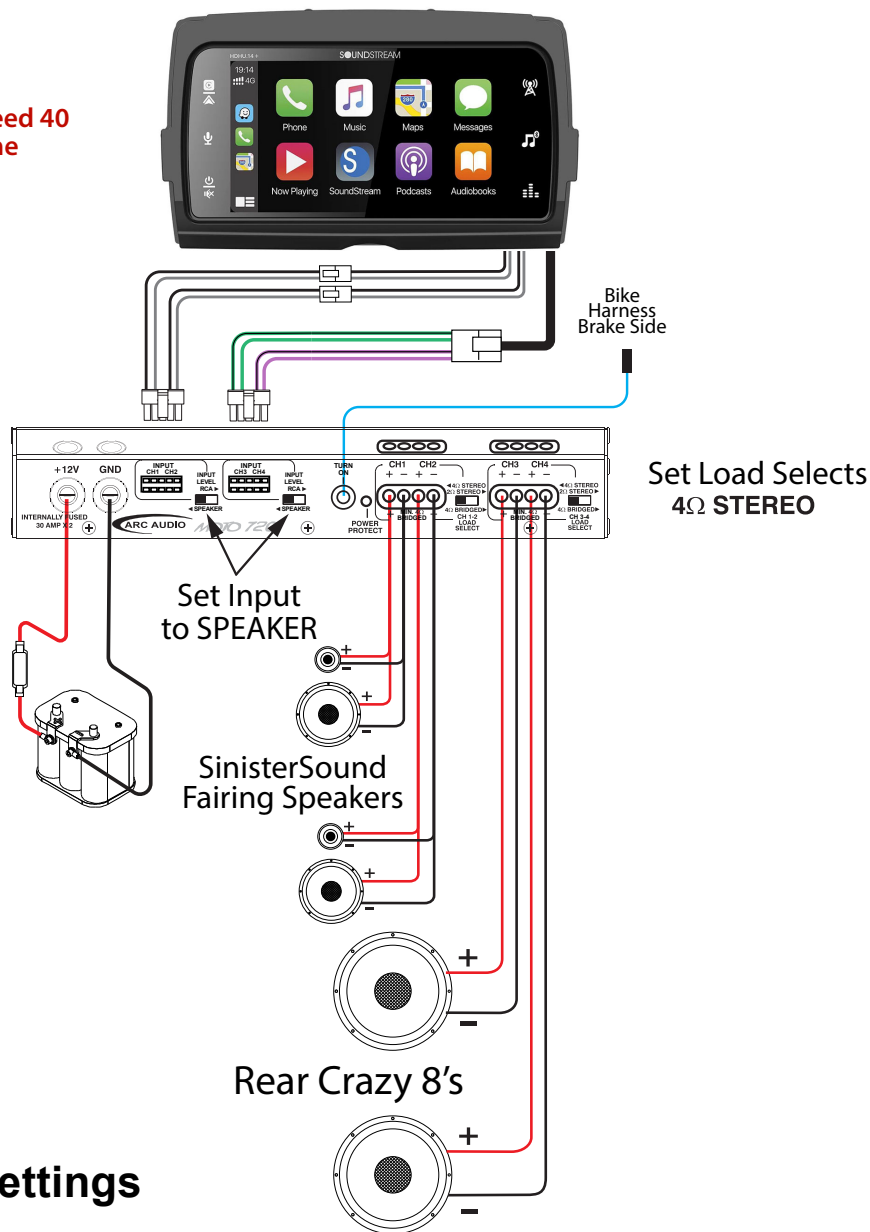

Amp Settings

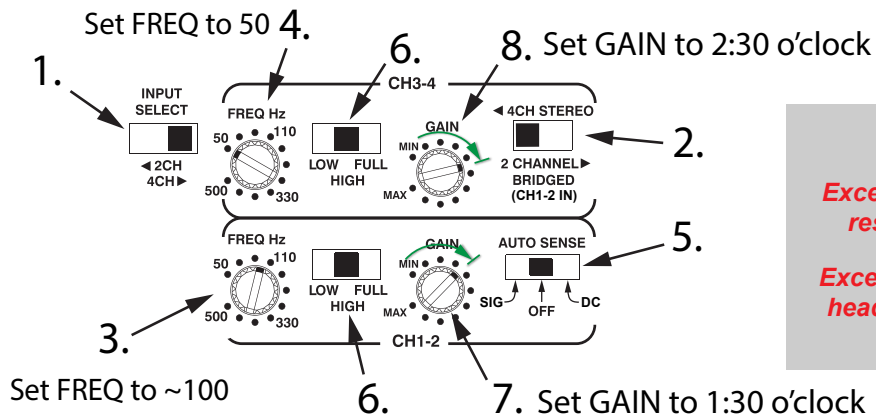

WARNING!

Exceeding these gain settings will result in equipment damage!

Exceeding the volume of 40 on the head unit will result in equipment damage!

MOTO720 SOUNDSTREAM HDHU14+ HEAD UNIT - SINISTER FAIRING KIT + ULTRA REARS

!! Do Not exceed 40 on volume

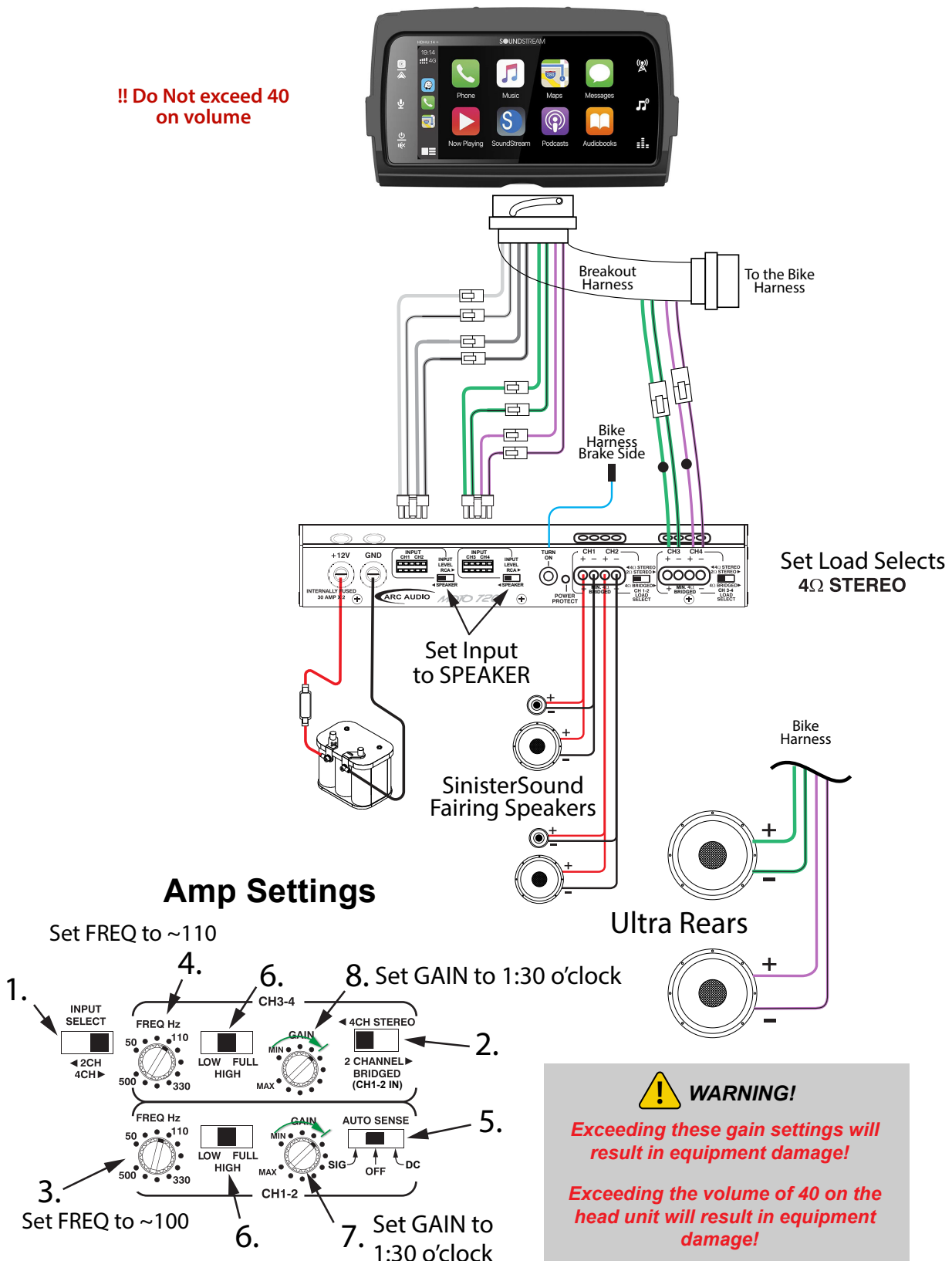

MOTO720 SOUNDSTREAM HDHU145L HEAD UNIT - SINISTER FAIRING KIT

!! Do Not exceed 40 on volume

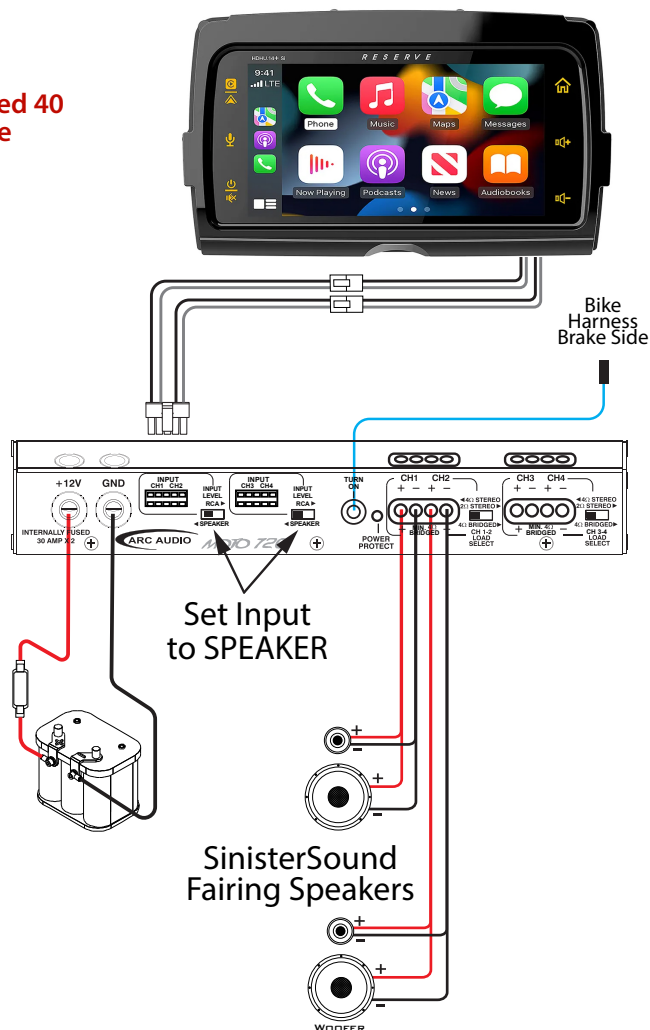

Amp Settings

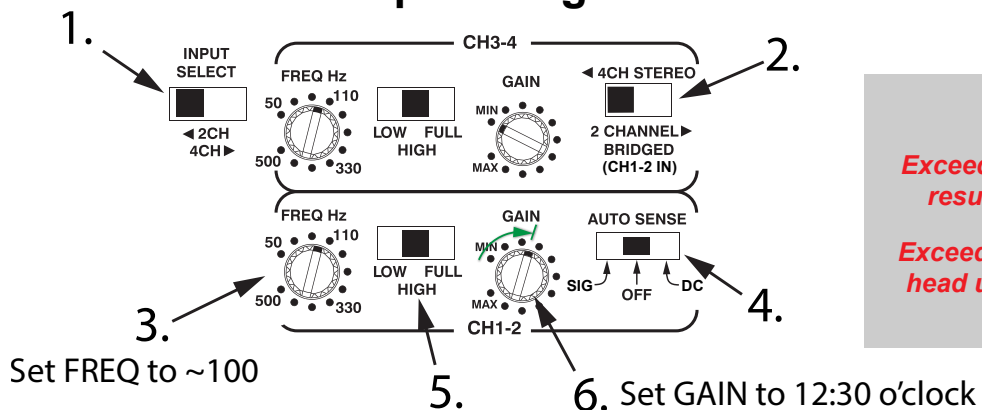

WARNING!

Exceeding these gain settings will result in equipment damage!

Exceeding the volume of 40 on the head unit will result in equipment damage!

MOTO720 SOUNDSTREAM HDHU145L HEAD UNIT - SINISTER FAIRING KIT + LIDS

**!! Do Not exceed 40
on volume**

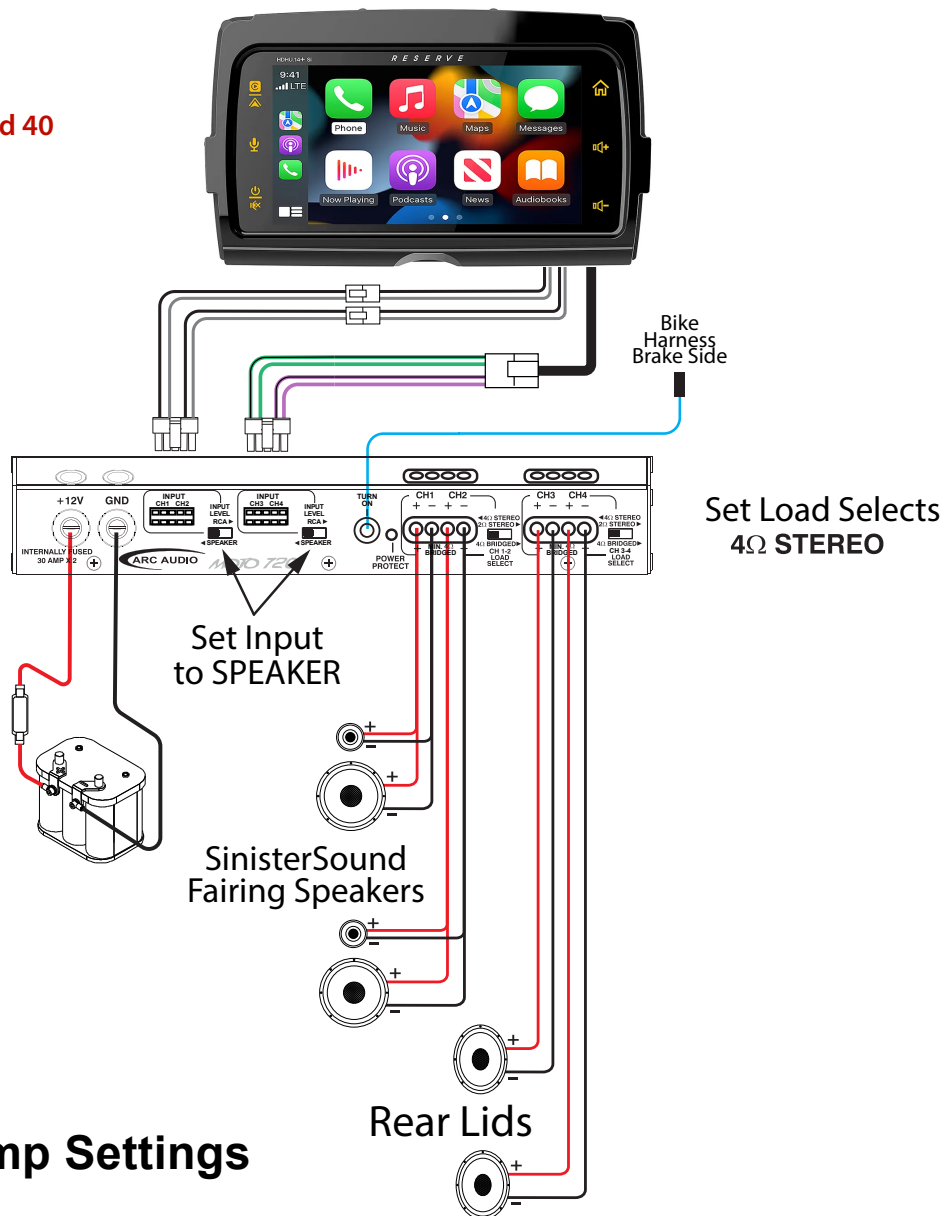

Amp Settings

Set FREQ to ~110

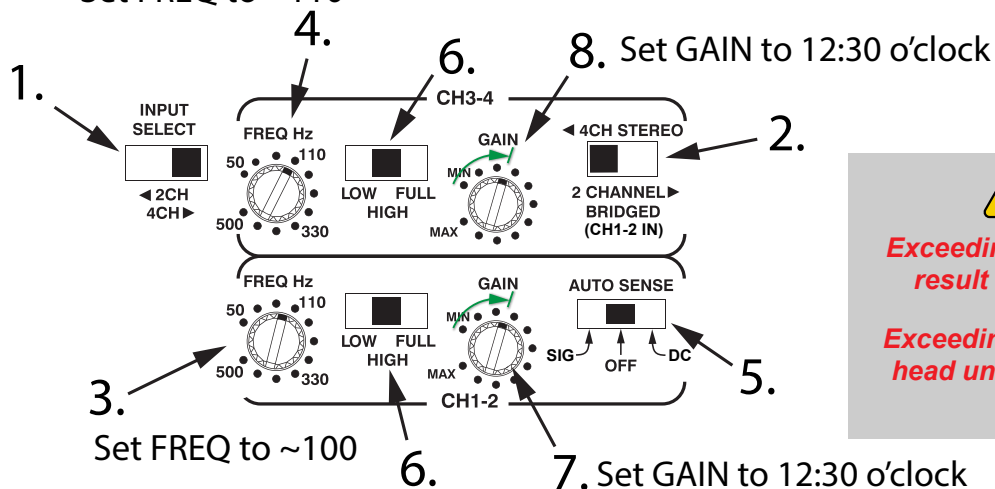

WARNING!

**Exceeding these gain settings will
result in equipment damage!**

**Exceeding the volume of 40 on the
head unit will result in equipment
damage!**

MOTO720 SOUNDSTREAM HDHU14S HEAD UNIT - SINISTER FAIRING KIT + CRAZY 8'S

!! Do Not exceed 40 on volume

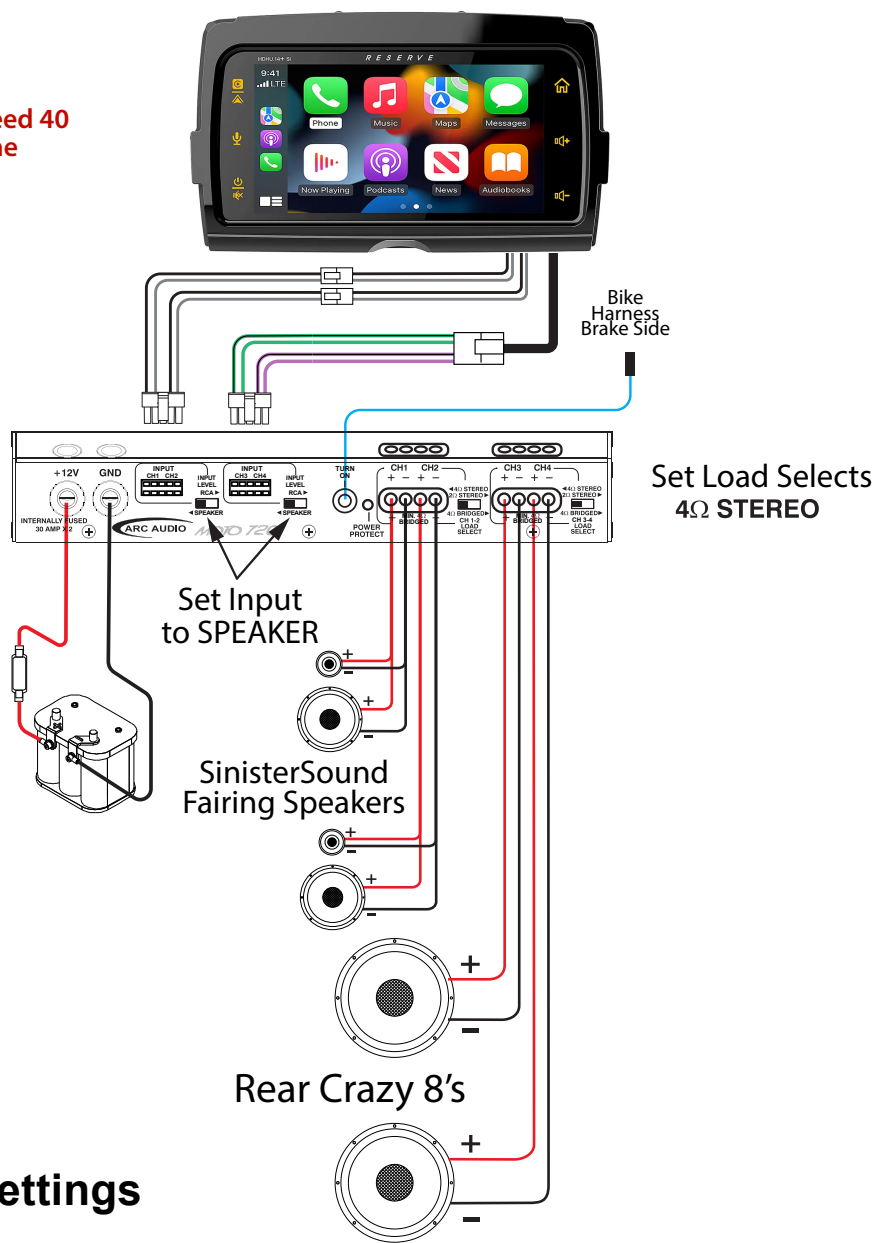

Amp Settings

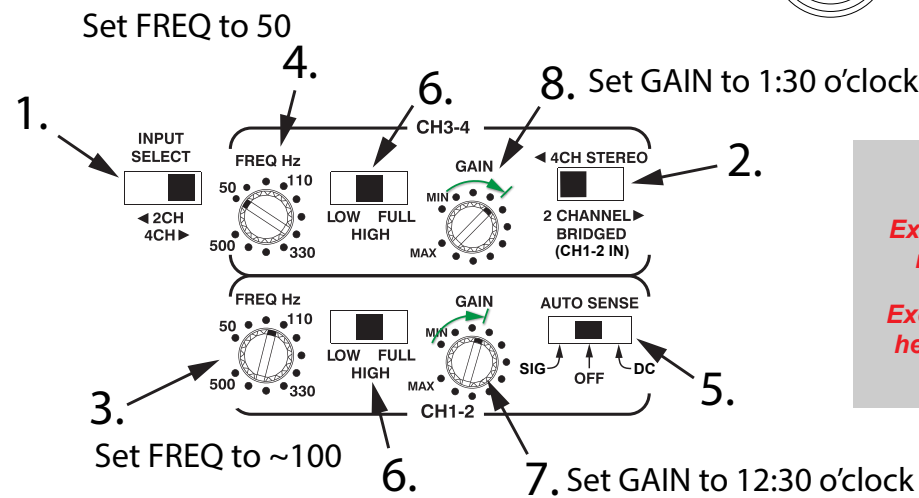

MOTO720 SOUNDSTREAM HDHU14S1 HEAD UNIT - SINISTER FAIRING KIT + ULTRA REARS

!! Do Not exceed 40 on volume

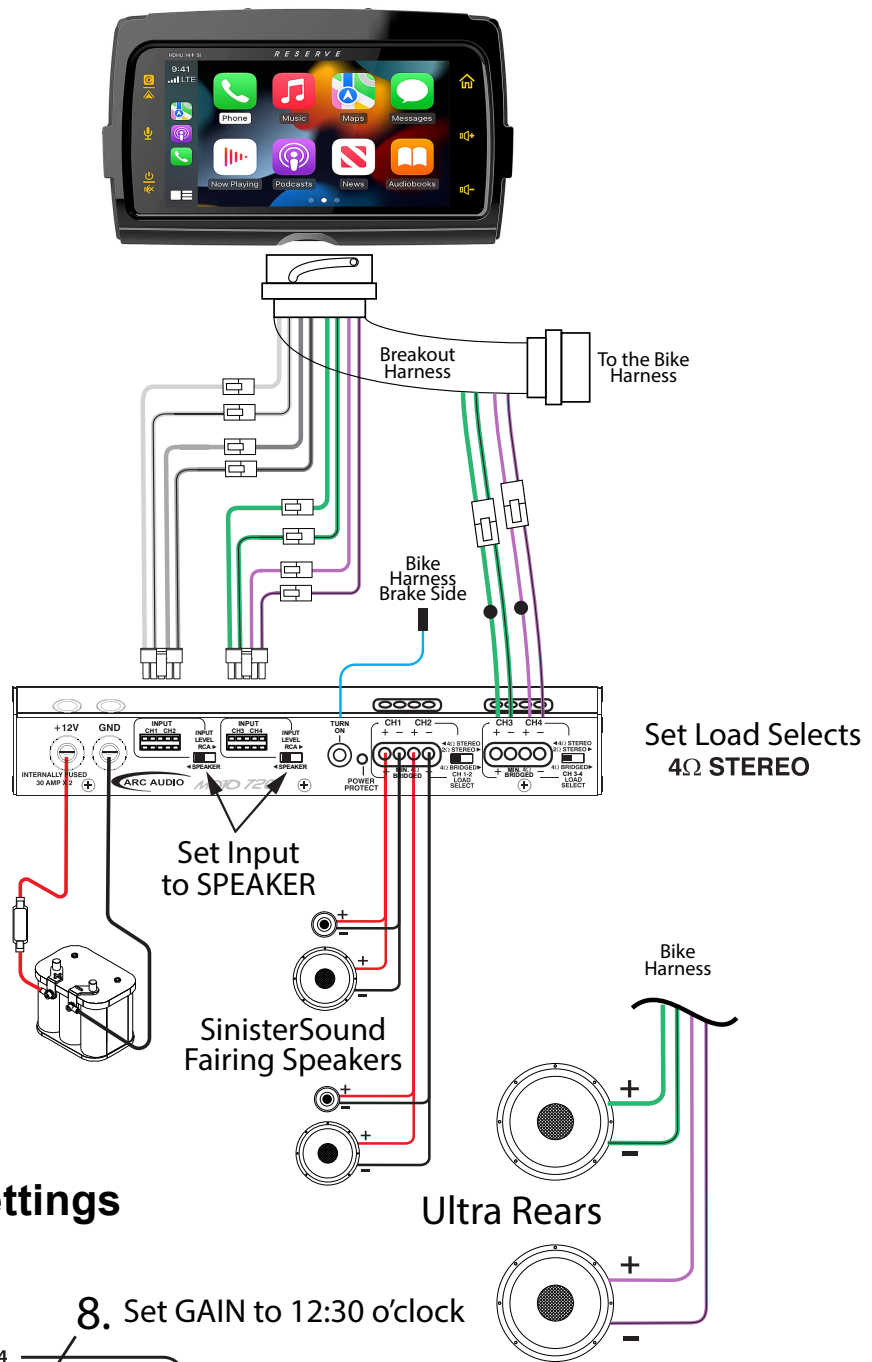

Amp Settings

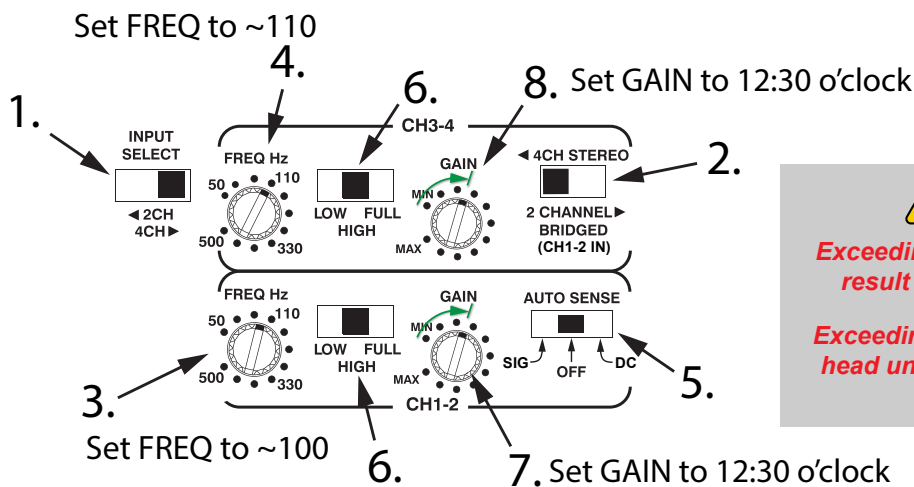

WARNING!

Exceeding these gain settings will result in equipment damage!

Exceeding the volume of 40 on the head unit will result in equipment damage!

TESTING AND TUNING

1. Insert the fuse on the power and ground cable.
2. Flashing the bike. If you have Line Level adapters OR a 19-UP bike, Skip to Step 4.

Do Not flash the bike if you're using BOOM amps.

When Flashing 14-UP bikes, set your amp Gain all the way down on the Moto720 on 1-2 channels. When playing at the loudest recommended volume, you will have 5 bars left. Playing beyond this level will result in damage to the system.

The correct flash for our amps is: Four Speaker, Upper Fairing, Rear Pod, No Amp

Perform a pre-calibration reset.

3. Turn bike ignition switch to Accessory.
4. Turn Autospeed **OFF** in the stock head unit options!
5. Choose a music source and play.
6. Check that grip controls are functioning properly.
7. Once you are satisfied that everything is functioning properly, move on to the Finishing the Installation section.

EQUALIZER SETTINGS

SoundStream HDHU14+ and HDHU14Si EQ Settings Without Crazy 8's

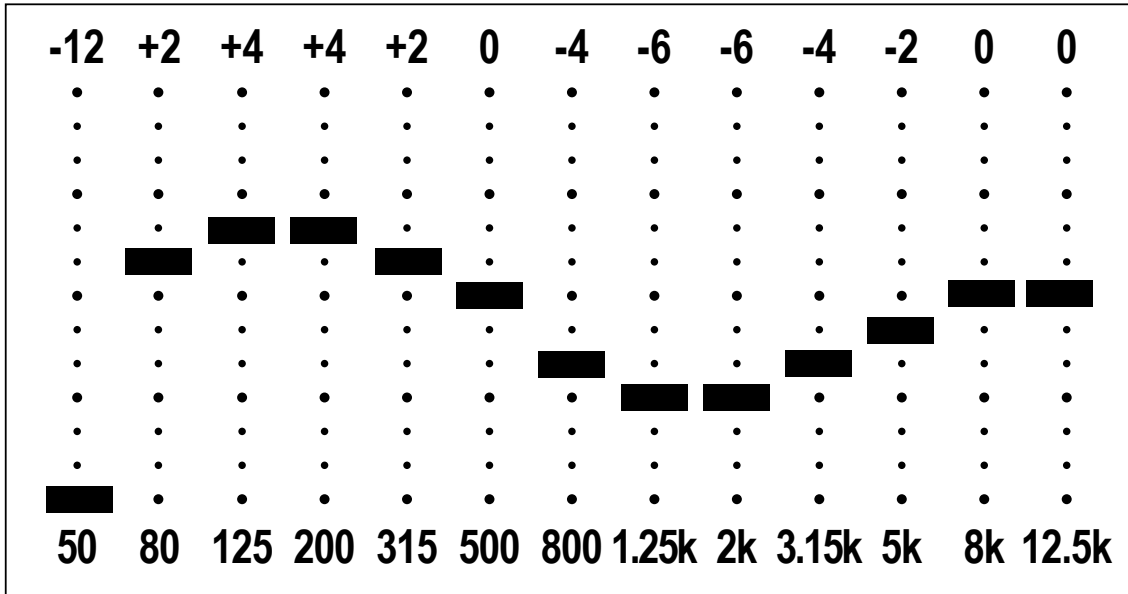

SoundStream HDHU14+ and HDHU14Si EQ Settings With Crazy 8's

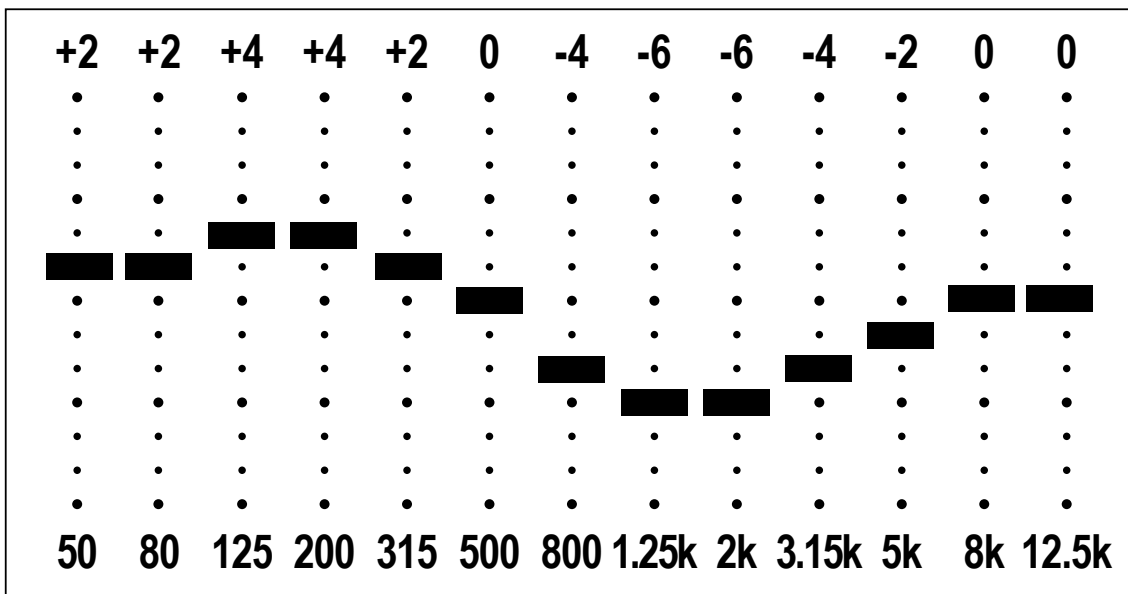

FINISHING THE INSTALLATION

- 1** Once you are satisfied with the tuning, mount the amp to the ARC RG15 Bracket. Slide the wired, tuned amp upside down under the bracket with the rear of the amp and wiring exiting on the clutch side.

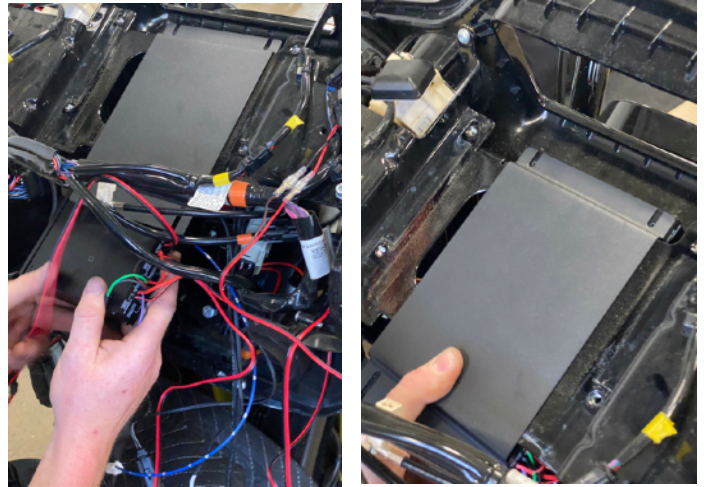

- 2** Locate the four holes in the bottom of the amp. Secure the amp with the provided short black screws and washers. Blue Loctite® is advised. Screws are in the Moto720 Box, washers come with the RG15 Bracket.

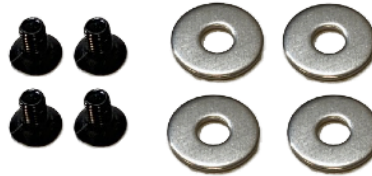

- 3** Reinstall the head unit above the bracket.

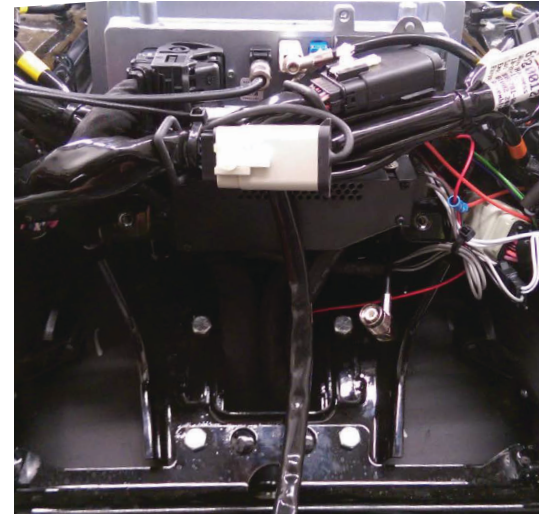
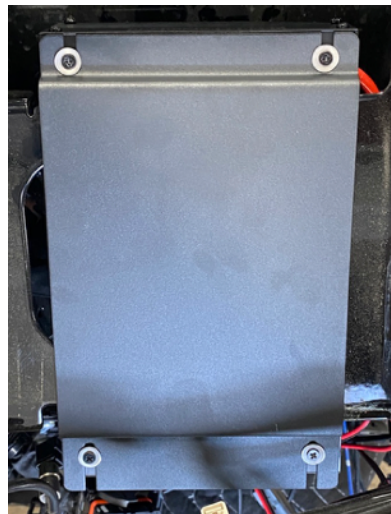

- 4** Reinstall fairing and speaker grills.
- 5** Reinstall seat and tank if previously removed.
- 6** Enjoy your new system!

