



**14-UP STREET GLIDE/ULTRA**

INSTALLATION INSTRUCTIONS  
REV 006



## 14-UP STREET GLIDE/ULTRA INSTALLATION INSTRUCTIONS

KIT PARTS .....	3
BASE KIT PARTS: .....	3
WITH AMPLIFIER .....	3
14-18 Misc. ....	3
PREPARE THE BIKE .....	4
PREPARING THE SPEAKER ENCLOSURES.....	5
INSTALLATION OF TOUR PACK SPEAKERS.....	9
INSTALLATION OF AMPLIFIER.....	10
ARC AUDIO AMPLIFIER WIRING AND SETTINGS .....	11
MOTO720 STOCK HD HEAD UNIT - SINISTER FAIRING KIT NO FLASH .....	12
MOTO720 STOCK HD HEAD UNIT - SINISTER FAIRING KIT + LIDS NO FLASH .....	13
MOTO720 STOCK HD HEAD UNIT - SINISTER FAIRING KIT + CRAZY 8's NO FLASH .....	14
MOTO720 STOCK HD HEAD UNIT - SINISTER FAIRING KIT + ULTRA REARS NO FLASH .....	15
MOTO720 STOCK HD HEAD UNIT - SINISTER FAIRING KIT WITH FLASH .....	16
MOTO720 STOCK HD HEAD UNIT - SINISTER FAIRING KIT + LIDS WITH FLASH .....	17
MOTO720 STOCK HD HEAD UNIT - SINISTER FAIRING KIT + CRAZY 8's WITH FLASH .....	18
MOTO720 STOCK HD HEAD UNIT - SINISTER FAIRING KIT + ULTRA REARS WITH FLASH ....	19
MOTO720 SOUNDSTREAM HDHU14+ HEAD UNIT - SINISTER FAIRING KIT.....	20
MOTO720 SOUNDSTREAM HDHU14+ HEAD UNIT - SINISTER FAIRING KIT + LIDS.....	21
MOTO720 SOUNDSTREAM HDHU14+ HEAD UNIT - SINISTER FAIRING KIT + CRAZY 8's .....	22
MOTO720 SOUNDSTREAM HDHU14+ HEAD UNIT - SINISTER FAIRING KIT + ULTRA REARS ....	23
MOTO720 SOUNDSTREAM HDHU14Si HEAD UNIT - SINISTER FAIRING KIT.....	24
MOTO720 SOUNDSTREAM HDHU14Si HEAD UNIT - SINISTER FAIRING KIT + LIDS .....	25
MOTO720 SOUNDSTREAM HDHU14Si HEAD UNIT - SINISTER FAIRING KIT + CRAZY 8's .....	26
MOTO720 SOUNDSTREAM HDHU14Si HEAD UNIT - SINISTER FAIRING KIT + ULTRA REARS ...	27
DIAMOND AUDIO AMPLIFIER WIRING AND SETTINGS.....	28
TESTING AND TUNING .....	30
EQUALIZER SETTINGS.....	31
FINISHING THE INSTALLATION .....	32

## KIT PARTS

### BASE KIT PARTS:

- 2 - SinisterSound Woofers
- 1 - SinisterSound Tweeter/Speaker cover assembly Clutch side
- 1 - SinisterSound Tweeter/Speaker cover assembly Brake side
- 2 - Woofer leads
- 2 - Ports
- 1 - Set of drill templates and wiring spacers



Enclosures for illustration only. Not included.

### WITH AMPLIFIER

- 1 - Amplifier
- 1 - SinisterSound power and ground cable



### 14-18 MISC.

- 1 - SinisterSound Line Level Adapter
- 1 - RCA Cable
- \* Not required with 19-UP models or bikes that will be flashed.





## PREPARE THE BIKE

1

Remove the outer fairing and amp, if replacing. Remove the speaker enclosures and save the screws for reassembly. Remove the speakers from the enclosures.



2

Remove the factory speaker grills and save the screws for later.



3

Remove the old speakers from the pods saving the screws and speaker leads with the Molex connectors.



If you already have an Amplifier go to the [Preparing the Speaker Enclosures](#) section.

If you are installing an Amplifier, continue.

4

Remove the seat to expose the battery.

5

Remove the gas tank to expose the cable channel.





## PREPARING THE SPEAKER ENCLOSURES

1

Place the drill templates on the enclosures as shown.

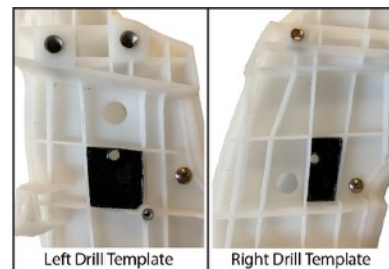

2

Using the drill templates, drill pilot holes in the enclosures.

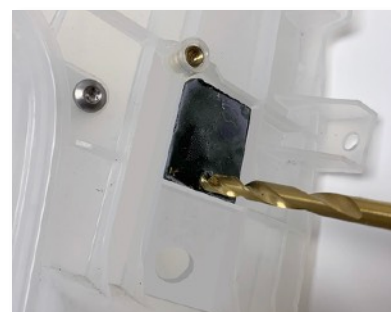

3

Using a 2-3/8" (60mm) hole saw, drill the port holes in the enclosures. Use your pilot holes to guide you. Run the drill in reverse and go slow.



4

Trim the fin in line with the hole you drilled in the previous step. This will allow the port to sit in the proper position.

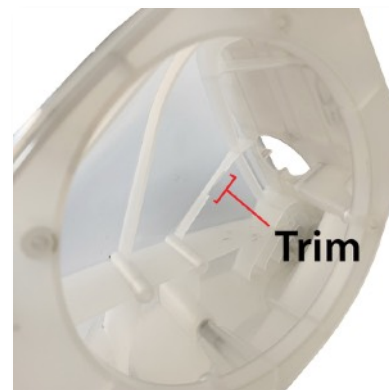

5

Remove the nub from each of the front surfaces.



6

Place the wiring spacers next to the port holes as shown.



7

Route the woofer leads in the notch of the wire spacers and insert the ports into the enclosures flush with the lowest fins.

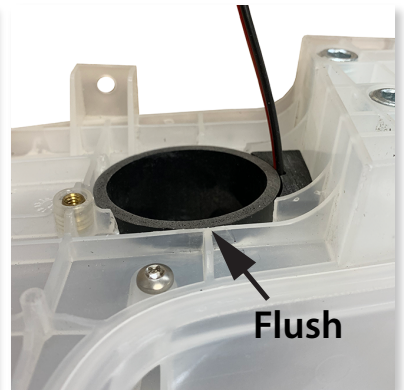
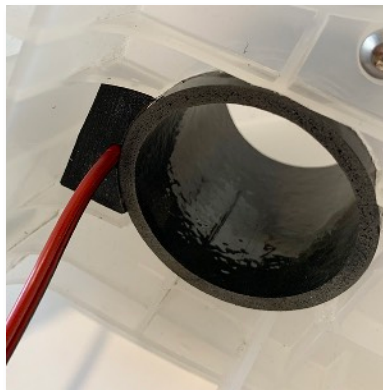

8

Connect the leads to the woofers paying attention to the positive and negative tabs.



9

Mount the woofers using the screws previously removed. Gently pull some of the slack out of the woofer leads being careful not to put tension on the tabs.



10

Glue the ports and spacers in place.

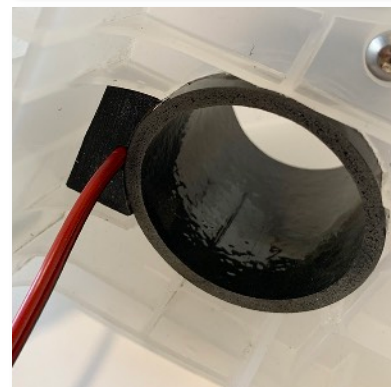

11

Install the tweeter bridge assembly to the fairing as shown using the screws previously removed. There are three tabs. The flat tab goes toward the head unit as shown. Route the tweeter leads toward the amp. Repeat on opposite side.

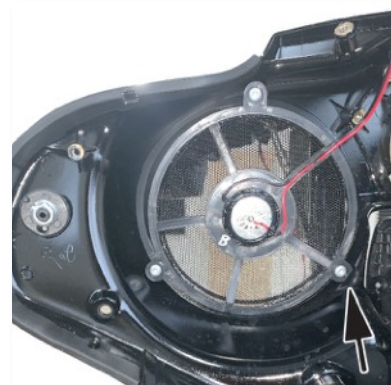

12

Mount the speaker pods to the bike using the previously removed screws. Route the woofer leads toward the amp.



13

Neatly route the wires to the amp and make the speaker connections as shown in Figure 1 on the next page per the kit you purchased. Picture shows Channel 1 which is your Clutch Side speaker. Repeat the same for Channel 2 (Brake Side). Make sure to match the positive and negative wires on each side. **DO NOT CROSS THE POSITIVES AND NEGATIVES.** If your woofers are out of phase, you will have no bass.



**FIGURE 1**

**Typical Front Fairing Speaker to Amp - CH 1 (Clutch Side)**

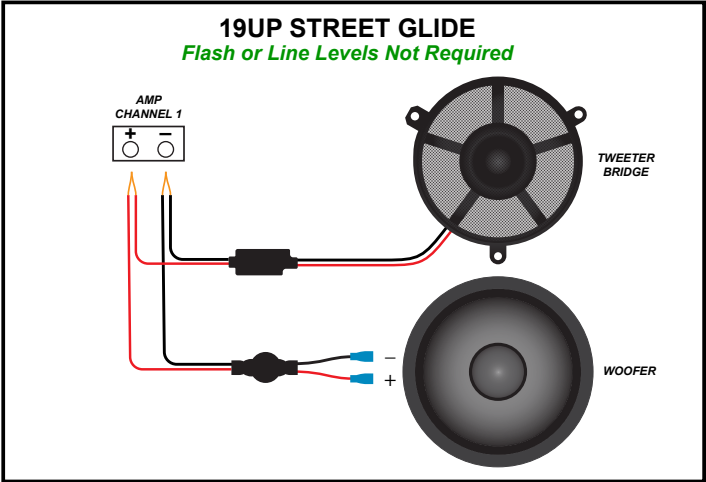
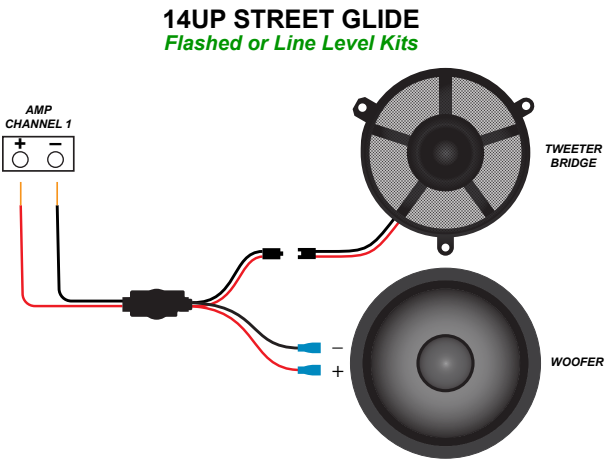

## INSTALLATION OF TOUR PACK SPEAKERS

1

Disconnect and remove the old speakers. Trim back some shrink tube around the speaker wires to allow them to spread. Discard the screws that held the old speakers in place. New larger screws are supplied in the kit.



2

The stack-up will be: Metal Spacer Ring (closest to the pod), Plastic Spacer then Woofer as shown.



3

Connect the speaker leads to the new woofers as shown screws. **DO NOT CROSS THE POSITIVES AND NEGATIVES.** If your woofers are out of phase, you will have no bass.



4

Secure the new Speaker, Spacer and Spacer Ring Assembly with the supplied screws. Drive the NEW supplied screws into new locations in the pods. Do not reuse the existing holes.



x 4 per Speaker



5

Install the supplied grills.



## INSTALLATION OF AMPLIFIER

Follow the instructions included with your amplifier.

The amplifier is mounted on top of the head unit and can be secured with velcro or double sided tape.

For Arc Audio amplifier wiring and settings, see [Arc Audio Amplifier Wiring and Settings](#).

For Diamond Audio amplifier wiring and settings, see [Diamond Audio Amplifier Wiring and Settings](#) section.

IMAGE BELOW SHOWS TYPICAL WIRING OF A LINE LEVEL ADAPTER  
(IF NOT FLASHING THE BIKE)

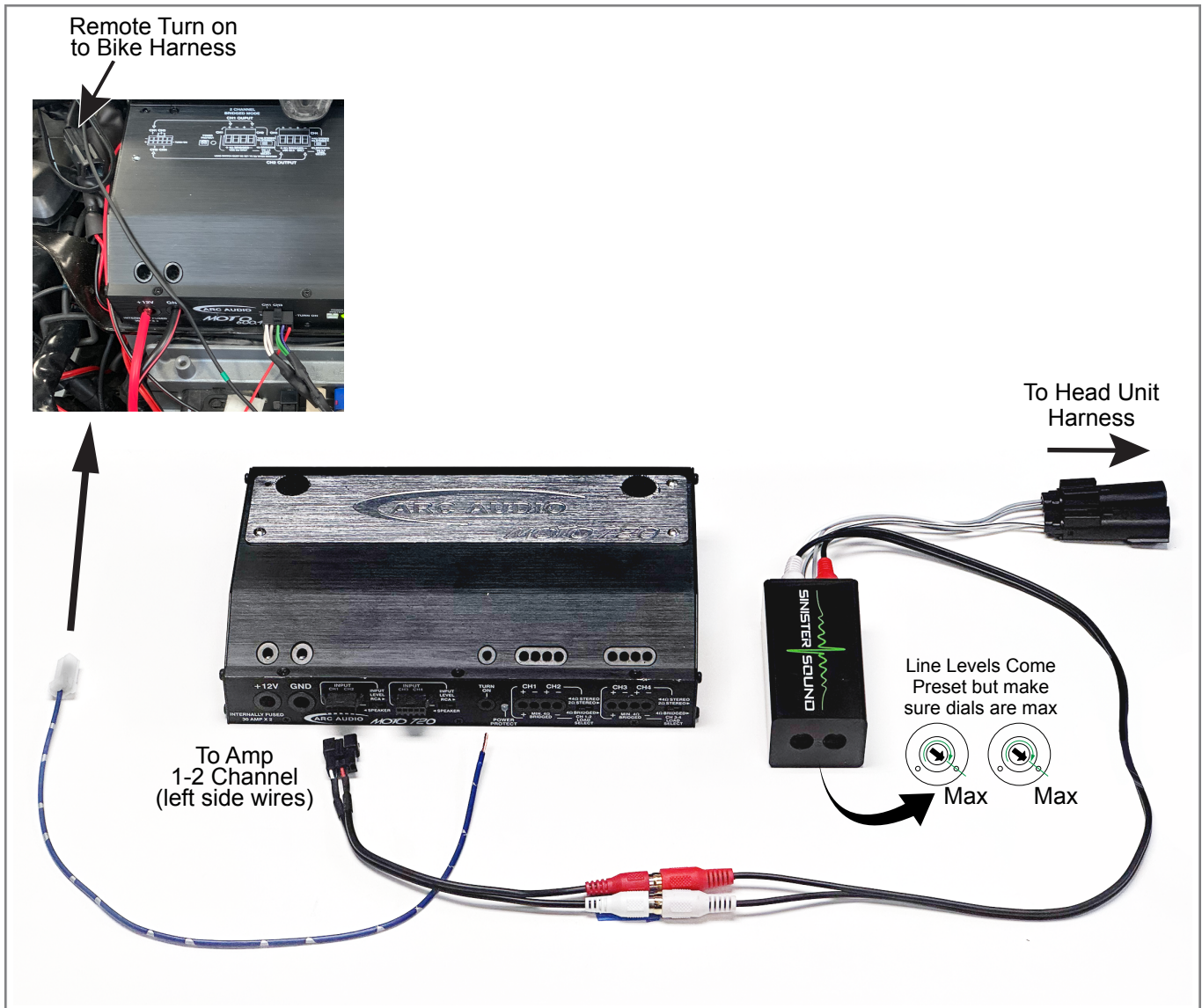



## ARC AUDIO AMPLIFIER WIRING AND SETTINGS

### ARC AUDIO MOTO720



1. Remove the fuse from the SinisterSound power and ground cable.
2. Connect the SinisterSound power and ground cable to the amplifier and route towards the battery through the cable channel under the tank.

**If you are flashing the bike or have a 19UP Kit, continue with Step 3. If you are NOT flashing the bike continue to step 4.**

**NOTE: For 19-UP bikes, flash or Line Level Adapters are not required. Continue to Step 3.**

3. If you are flashing the bike or you have a 19UP Kit you will not need the Line Level Adapter. Use the Speaker Level In harness to connect to the Molex connector wires (previously removed from the enclosures). Connect the male and female Molex ends. **Skip Step 4.**
4. If you are NOT flashing the bike, connect the Molex connectors of the Line Level Adaptor to Molex connectors from the head unit. Connect the RCA harness from the Line Level Adaptor to the amplifier Input ports. Connect the remote turn on wire to the head unit wiring harness.
5. Make the connections and initial settings per the diagrams on the following pages specific to your application:
  - Moto720 Stock Hd Head Unit - Sinister Fairing Kit No Flash
  - Moto720 Stock Hd Head Unit - Sinister Fairing Kit + Lids NO FLASH
  - Moto720 Stock Hd Head Unit - Sinister Fairing Kit + Crazy 8's NO FLASH
  - Moto720 Stock Hd Head Unit - Sinister Fairing Kit+ Ultra Rears NO FLASH
  - Moto720 Stock Hd Head Unit - Sinister Fairing Kit WITH FLASH
  - Moto720 Stock Hd Head Unit - Sinister Fairing Kit + Lids WITH FLASH
  - Moto720 Stock Hd Head Unit - Sinister Fairing Kit + Crazy 8's WITH FLASH
  - Moto720 Stock Hd Head Unit - Sinister Fairing Kit + Ultra Rears WITH FLASH
  - MOTO720 SoundStream Head Unit - Sinister Fairing Kit
  - MOTO720 SoundStream Head Unit - Sinister Fairing Kit + Lids
  - MOTO720 SoundStream Head Unit - Sinister Fairing Kit + Crazy 8's
  - MOTO720 SoundStream Head Unit - Sinister Fairing Kit + Ultra Rears

# MOTO720 STOCK HD HEAD UNIT - SINISTER FAIRING KIT NO FLASH

**!! Leave 5 bars open on volume**  
**!! Set Bass and Treble to zero**  
**!! Turn Speed Volume OFF**

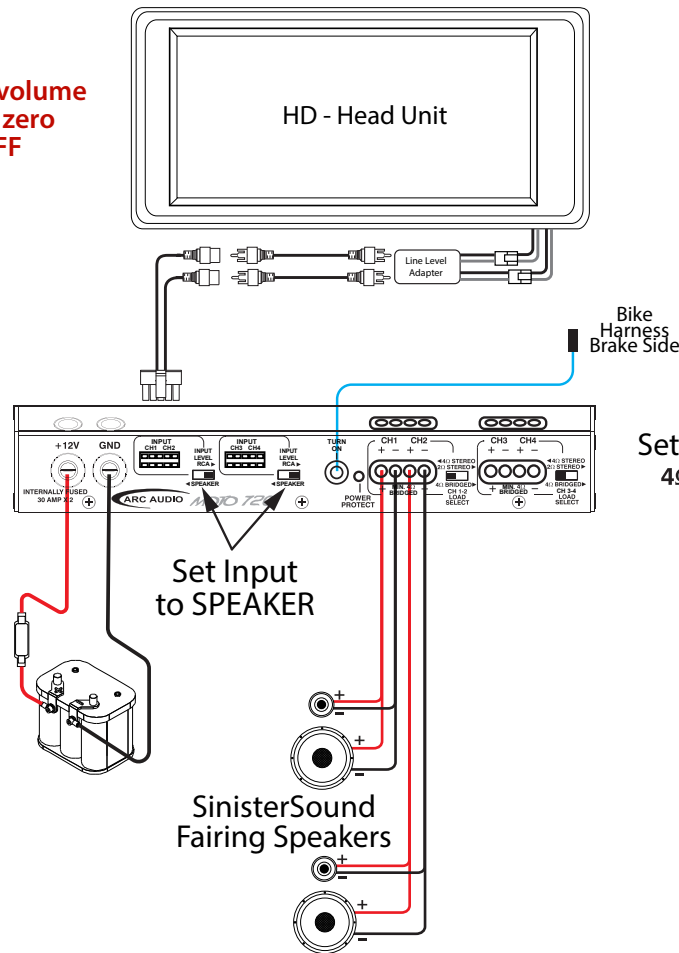

Line Levels Come Preset but make sure dials are max



## Amp Settings

With Line Levels Only

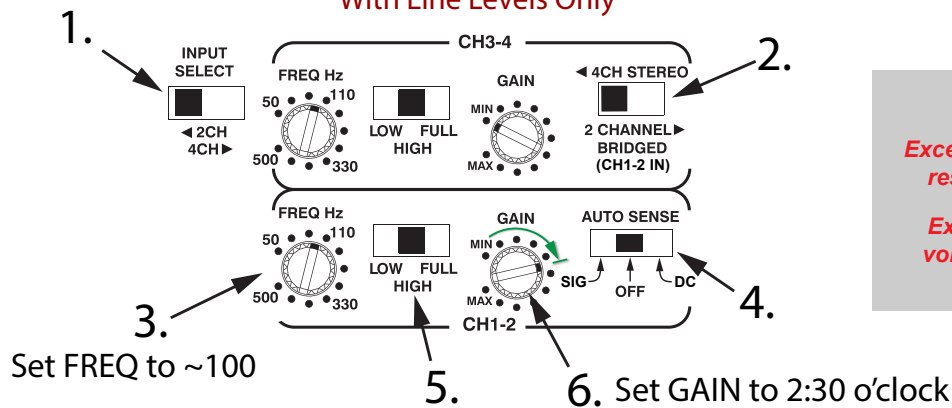

## WARNING!

Exceeding these gain settings will result in equipment damage!

Exceeding 5 open bars on the volume on head unit will result in equipment damage!

# MOTO720 STOCK HD HEAD UNIT - SINISTER FAIRING KIT + LIDS NO FLASH

!! Leave 5 bars open on volume  
!! Set Bass and Treble to zero  
!! Turn Speed Volume OFF

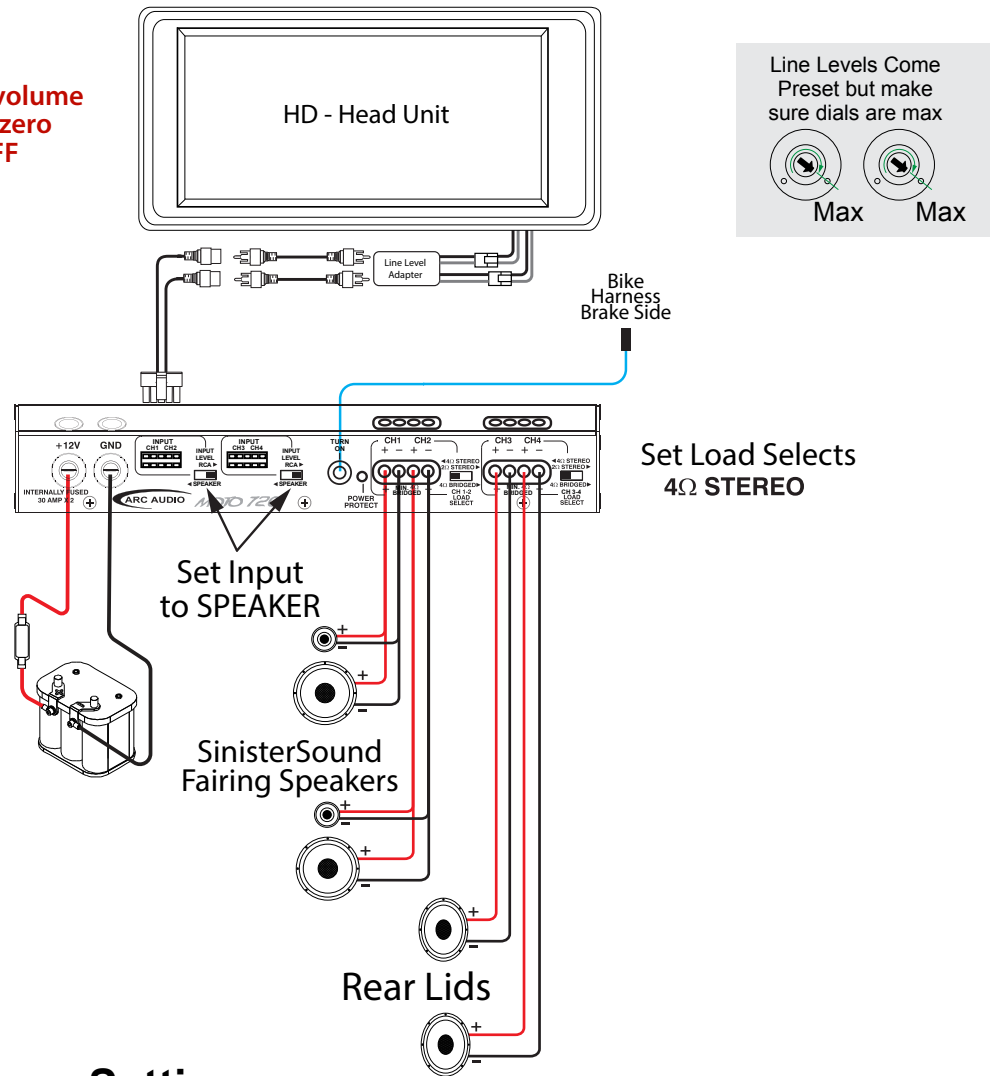

## Amp Settings With Line Levels Only

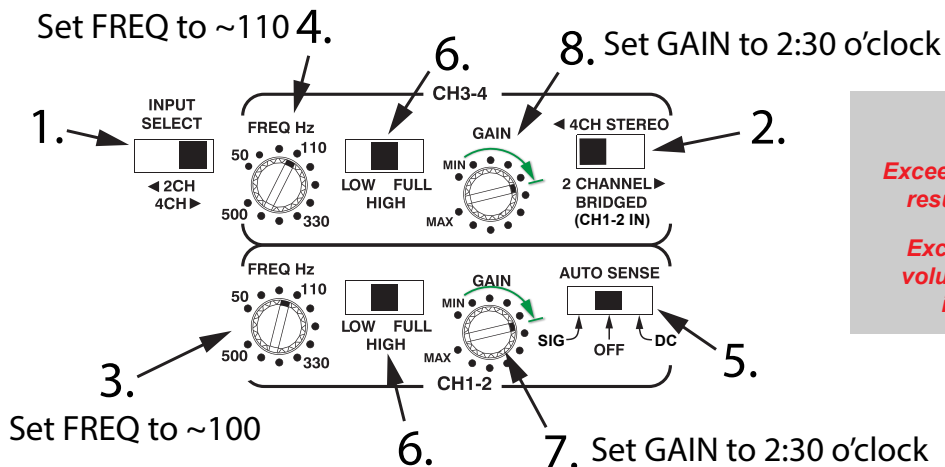

### WARNING!

Exceeding these gain settings will result in equipment damage!

Exceeding 5 open bars on the volume on head unit will result in equipment damage!



# MOTO720 STOCK HD HEAD UNIT - SINISTER FAIRING KIT + CRAZY 8'S NO FLASH

!! Leave 5 bars open on volume  
!! Set Bass and Treble to zero  
!! Turn Speed Volume OFF

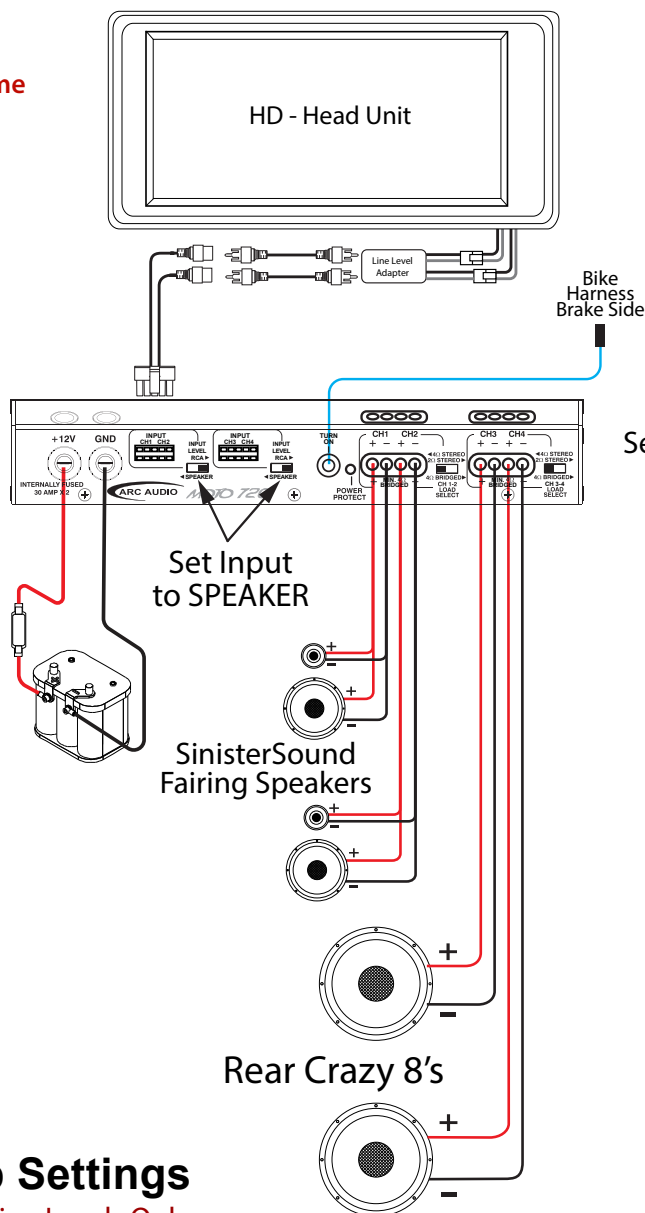

Line Levels Come Preset but make sure dials are max

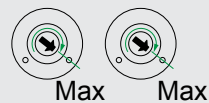

Set Load Selects  
4Ω STEREO

## Amp Settings With Line Levels Only

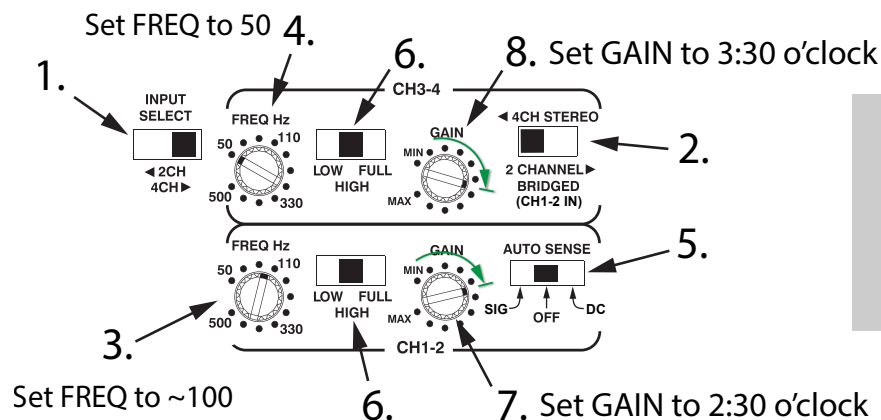

### WARNING!

Exceeding these gain settings will result in equipment damage!

Exceeding 5 open bars on the volume on head unit will result in equipment damage!

**MOTO720 STOCK HD HEAD UNIT - SINISTER FAIRING KIT + ULTRA REARS NO FLASH**

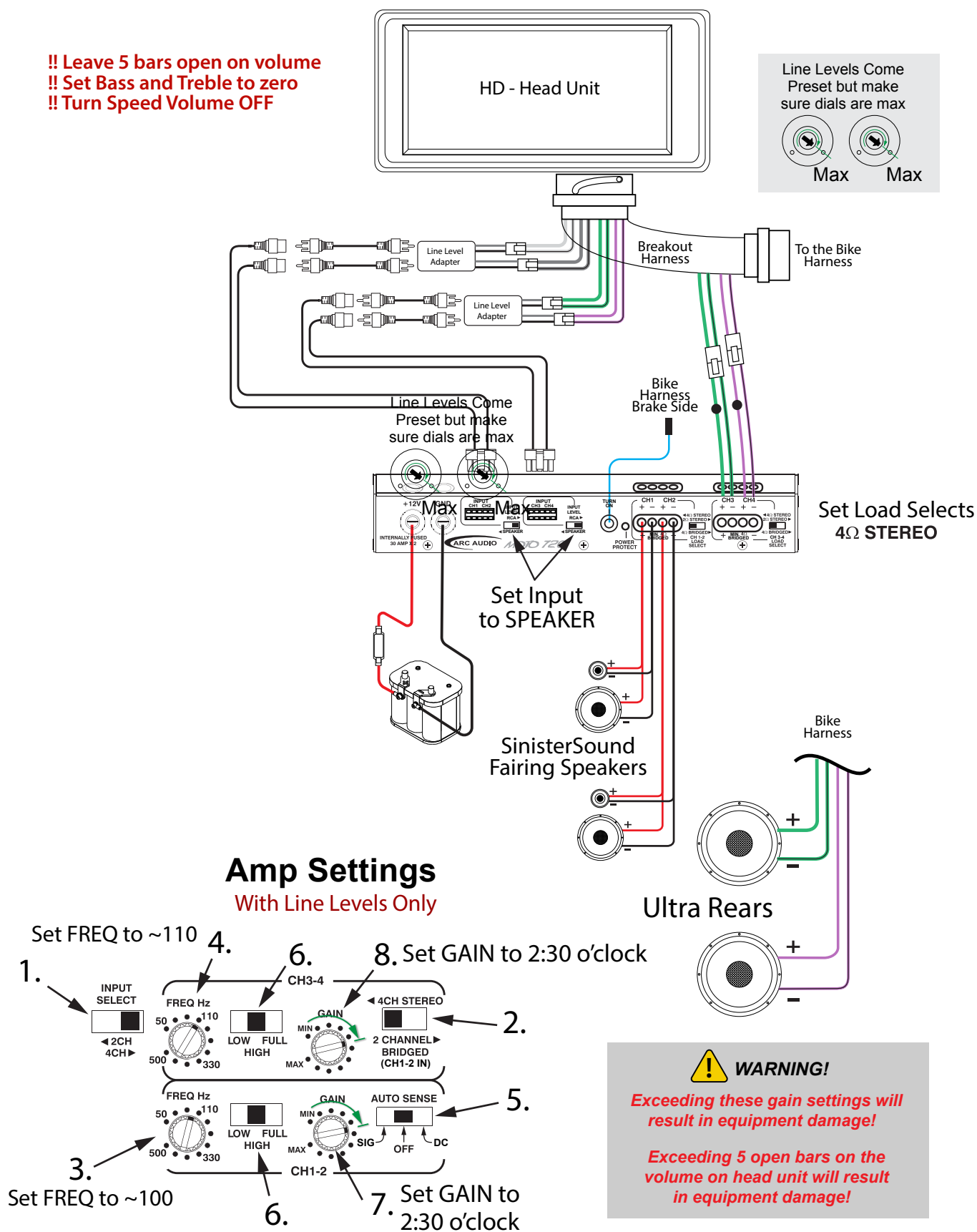

## MOTO720 STOCK HD HEAD UNIT - SINISTER FAIRING KIT WITH FLASH

!! Leave 5 bars open on volume  
!! Set Bass and Treble to zero  
!! Turn Speed Volume OFF

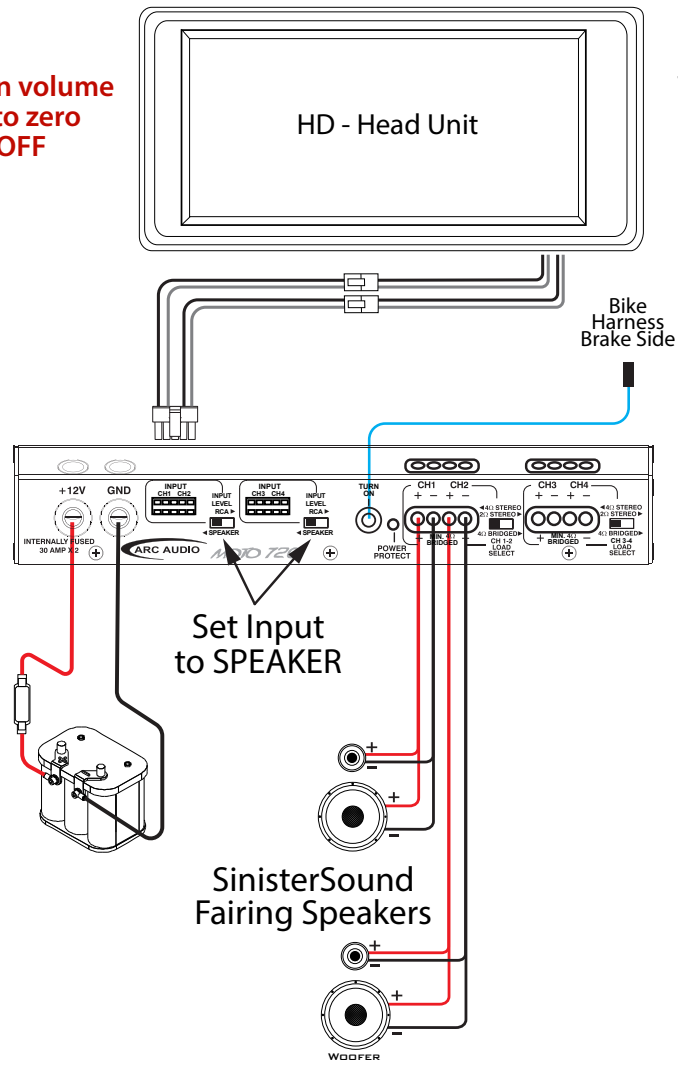

### FLASH

The correct flash for our system is:  
Upper Fairing, Rear Pod, No Amp

Set Load Selects  
4Ω STEREO

## Amp Settings

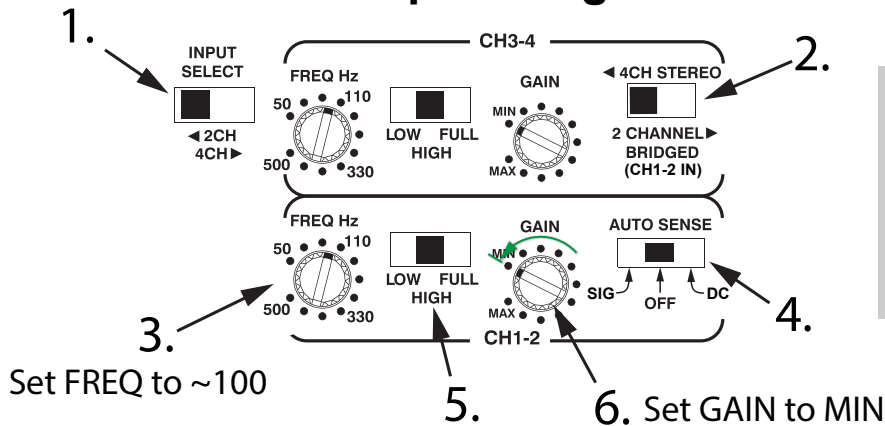

### WARNING!

Exceeding these gain settings will  
result in equipment damage!

Exceeding 5 open bars on the  
volume on head unit will result  
in equipment damage!



# MOTO720 STOCK HD HEAD UNIT - SINISTER FAIRING KIT + LIDS WITH FLASH

!! Leave 5 bars open on volume  
!! Set Bass and Treble to zero  
!! Turn Speed Volume OFF

## FLASH

The correct flash for our system is:  
Upper Fairing, Rear Pod, No Amp

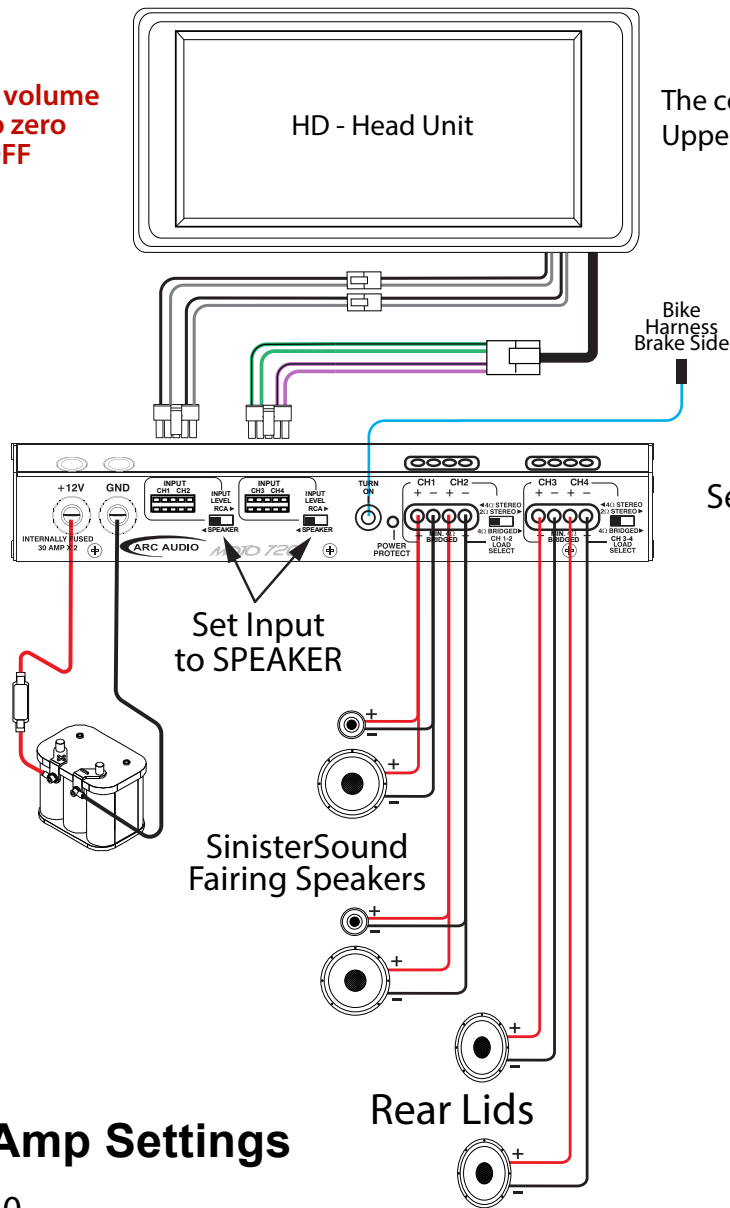

## Amp Settings

Set FREQ to ~110

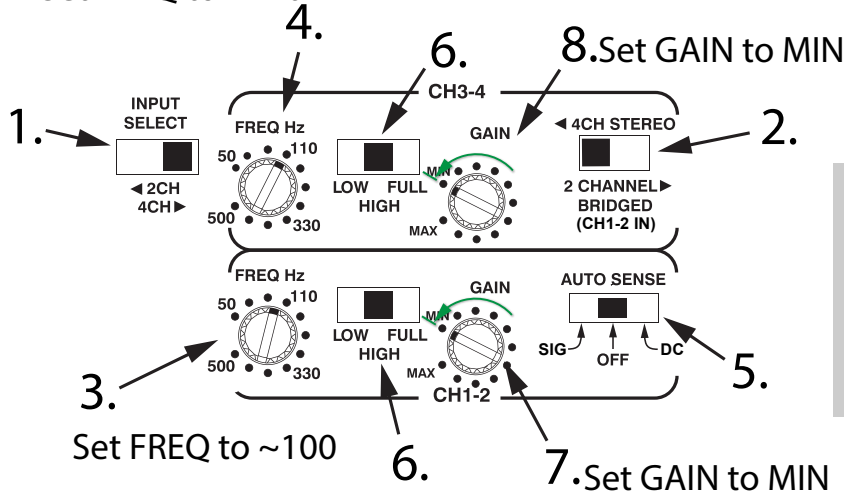

## WARNING!

Exceeding these gain settings will  
result in equipment damage!

Exceeding 5 open bars on the  
volume on head unit will result  
in equipment damage!

# MOTO720 STOCK HD HEAD UNIT - SINISTER FAIRING KIT + CRAZY 8'S WITH FLASH

**!! Leave 5 bars open on volume**  
**!! Set Bass and Treble to zero**  
**!! Turn Speed Volume OFF**

## FLASH

The correct flash for our system is:  
 Upper Fairing, Rear Pod, No Amp

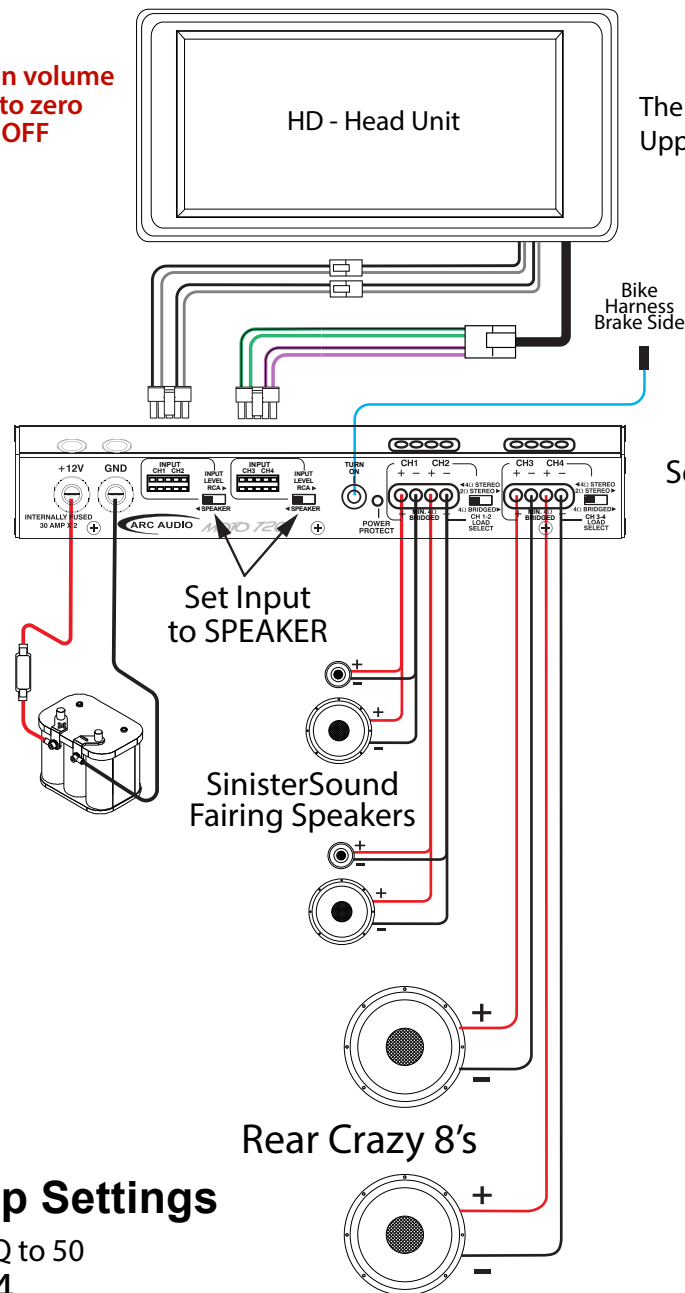

Set Load Selects  
**4Ω STEREO**

Set Input  
 to SPEAKER

SinisterSound  
 Fairing Speakers

Rear Crazy 8's

## Amp Settings

Set FREQ to 50

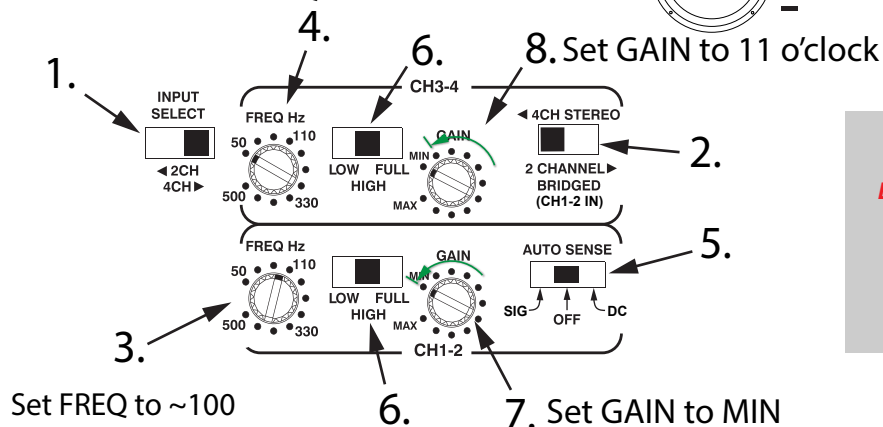

## WARNING!

Exceeding these gain settings will  
 result in equipment damage!

Exceeding 5 open bars on the  
 volume on head unit will result  
 in equipment damage!

# MOTO720 STOCK HD HEAD UNIT - SINISTER FAIRING KIT + ULTRA REARS WITH FLASH

!! Leave 5 bars open on volume  
!! Set Bass and Treble to zero  
!! Turn Speed Volume OFF

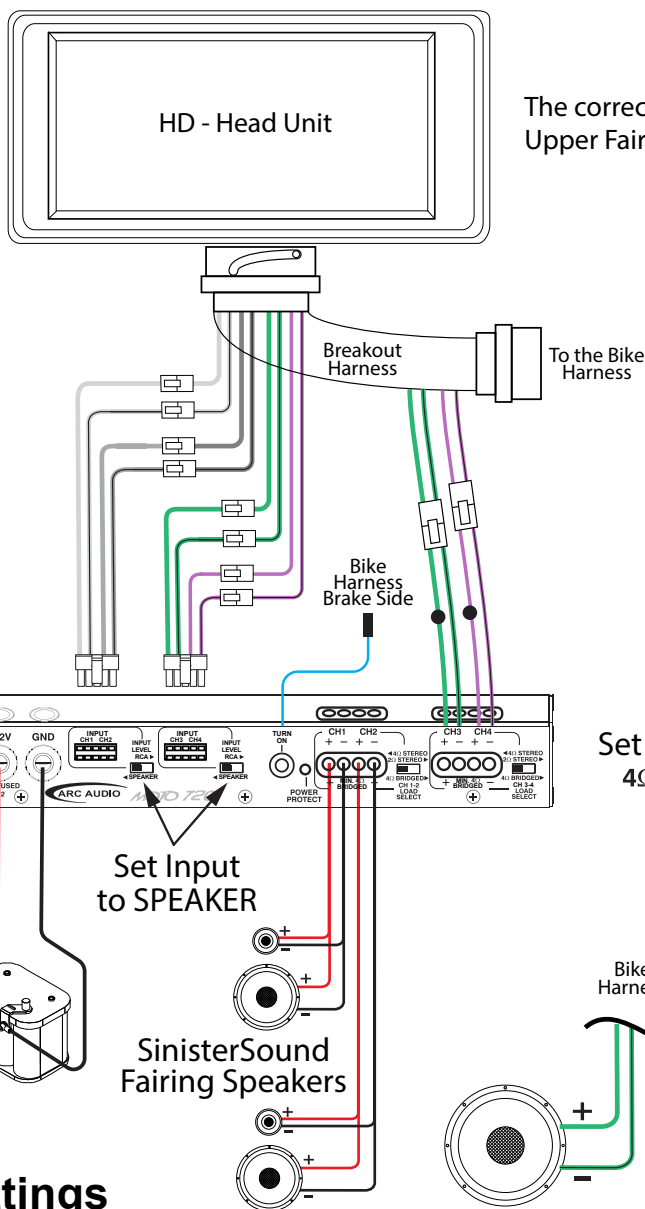

Set Load Selects  
4Ω STEREO

## Amp Settings

Set FREQ to ~110

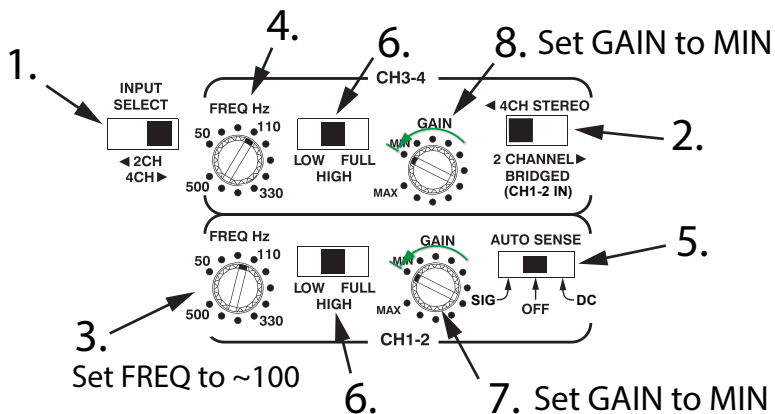

### WARNING!

Exceeding these gain settings will result in equipment damage!

Exceeding 5 open bars on the volume on head unit will result in equipment damage!

# MOTO720 SOUNDSTREAM HDHU14+ HEAD UNIT - SINISTER FAIRING KIT

**!! Do Not exceed 40 on volume**

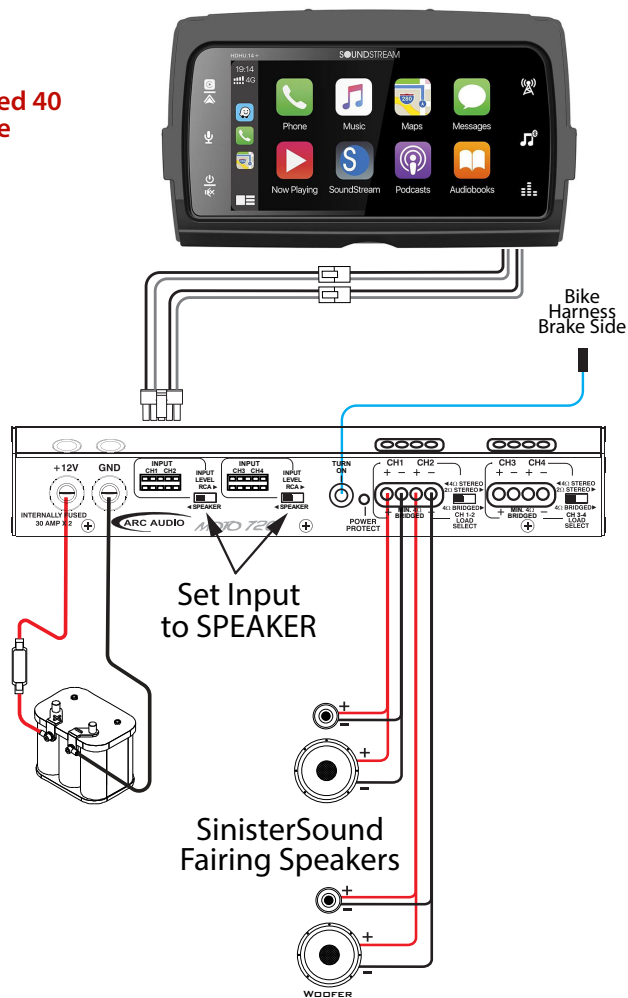

**Set Load Selects  
4Ω STEREO**

**Set Input  
to SPEAKER**

**SinisterSound  
Fairing Speakers**

## Amp Settings

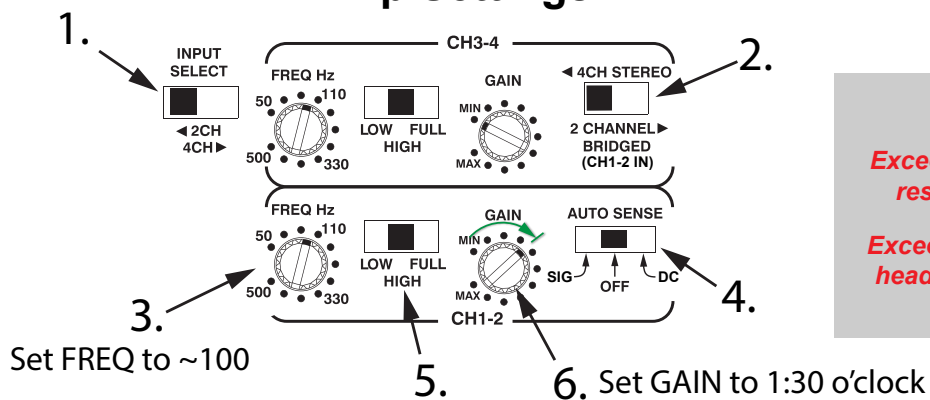

### **WARNING!**

**Exceeding these gain settings will  
result in equipment damage!**

**Exceeding the volume of 40 on the  
head unit will result in equipment  
damage!**



MOTO720 SOUNDSTREAM HDHU14+ HEAD UNIT - SINISTER FAIRING KIT + LIDS

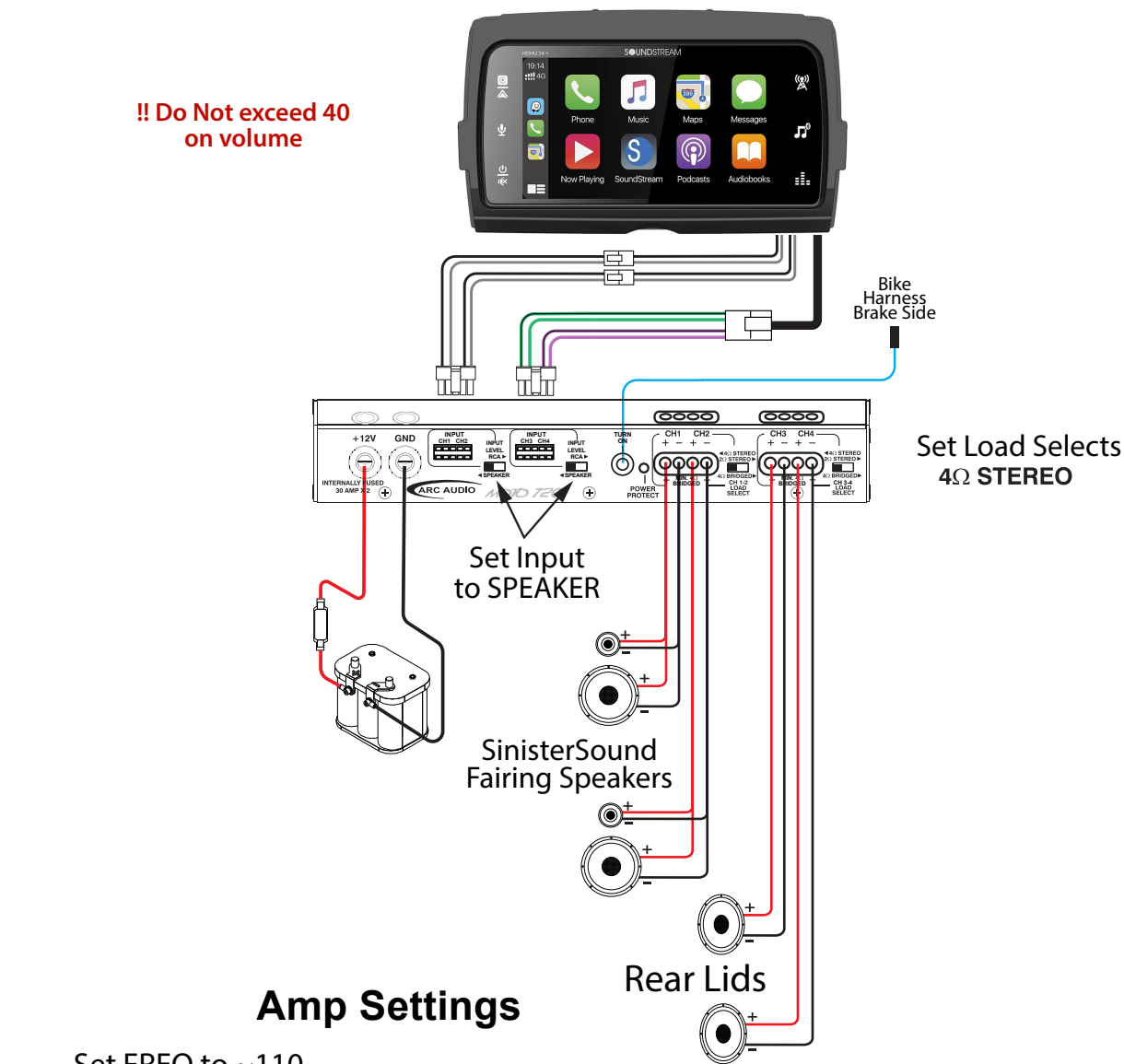

**Amp Settings**

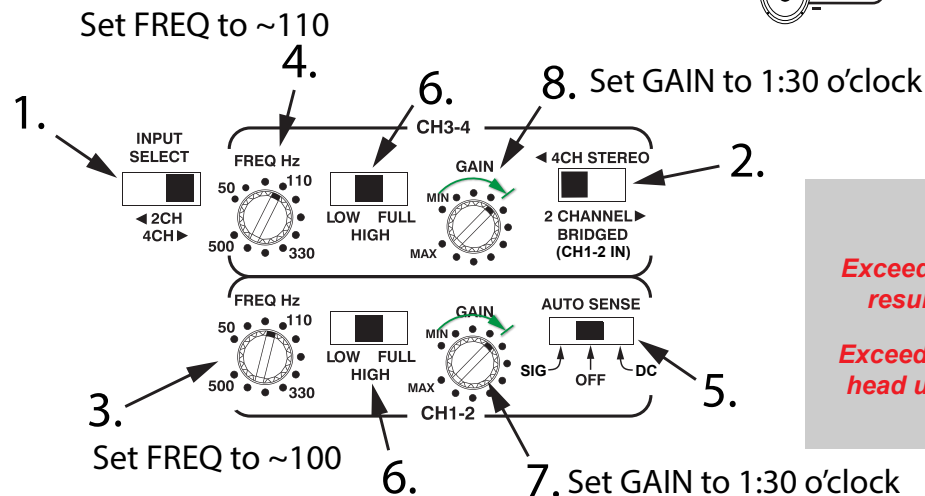

**WARNING!**

Exceeding these gain settings will result in equipment damage!

Exceeding the volume of 40 on the head unit will result in equipment damage!

MOTO720 SOUNDSTREAM HDHU14+ HEAD UNIT - SINISTER FAIRING KIT + CRAZY 8's

!! Do Not exceed 40 on volume

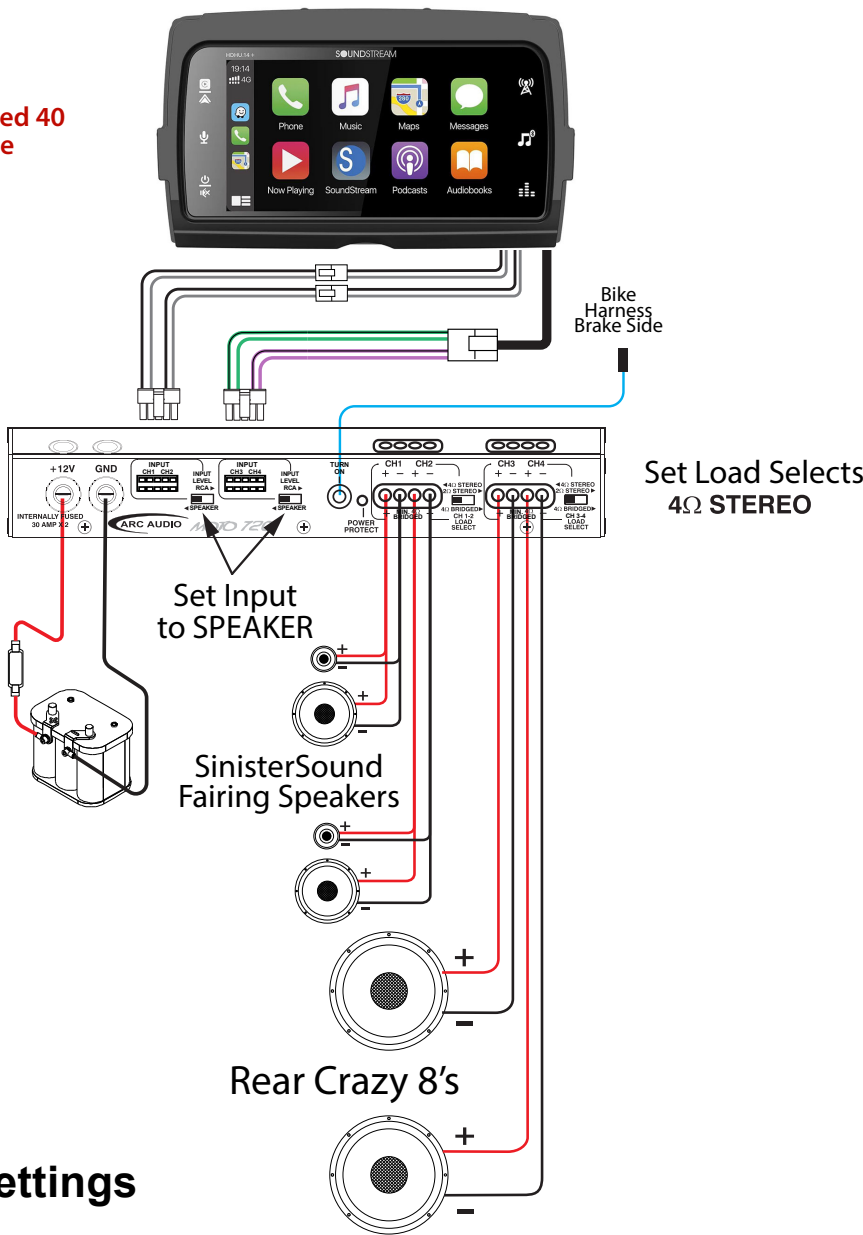

Amp Settings

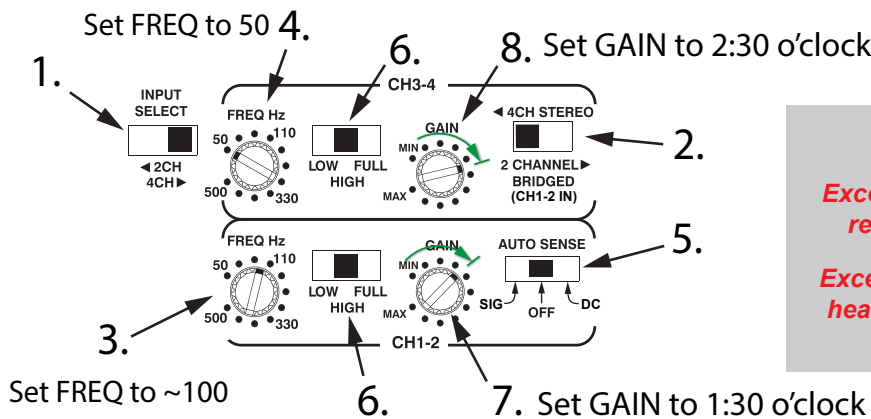

**WARNING!**

Exceeding these gain settings will result in equipment damage!

Exceeding the volume of 40 on the head unit will result in equipment damage!

MOTO720 SOUNDSTREAM HDHU 14+ HEAD UNIT - SINISTER FAIRING KIT + ULTRA REARS

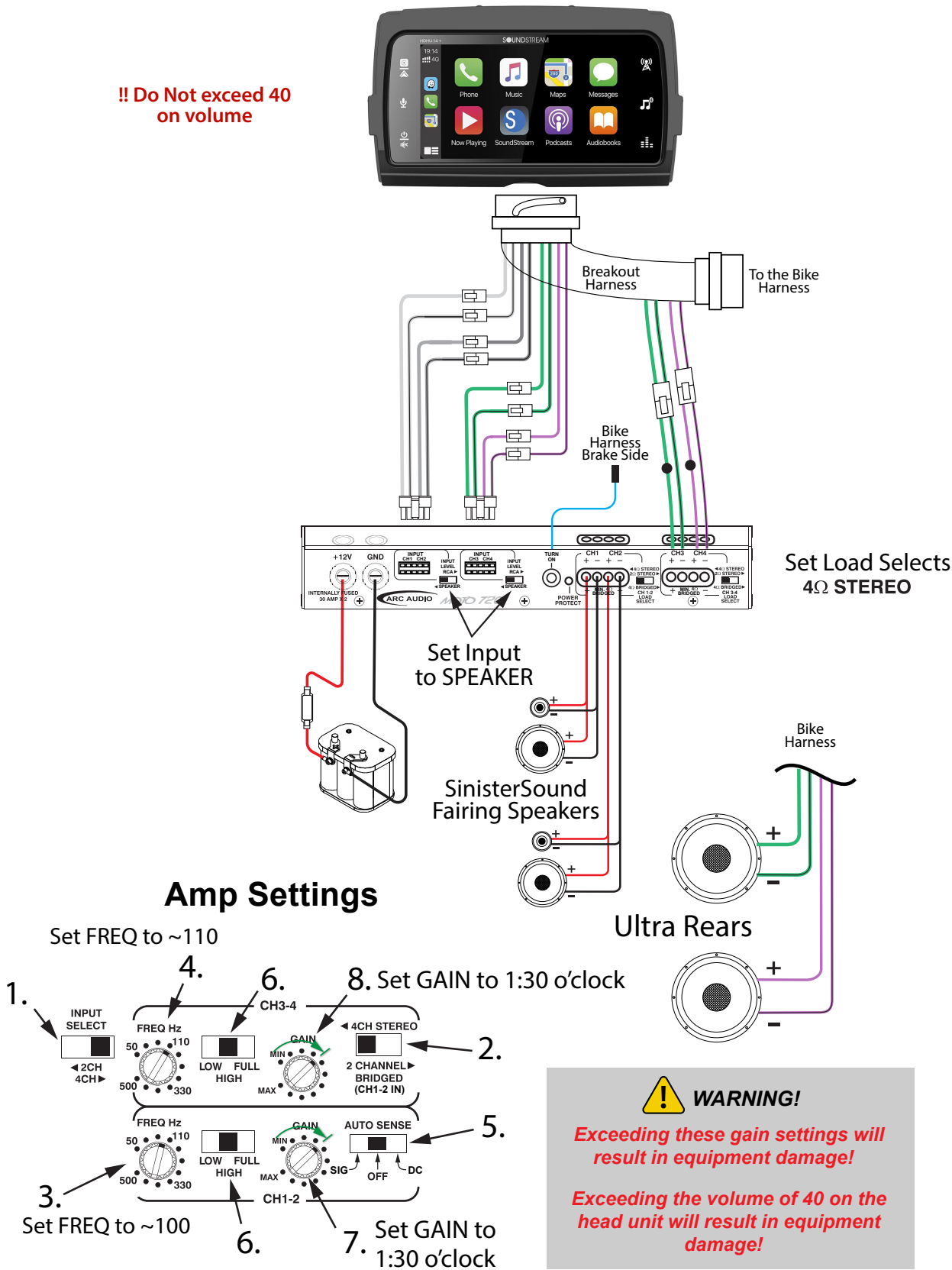

# MOTO720 SOUNDSTREAM HDHU145L HEAD UNIT - SINISTER FAIRING KIT

**!! Do Not exceed 40 on volume**

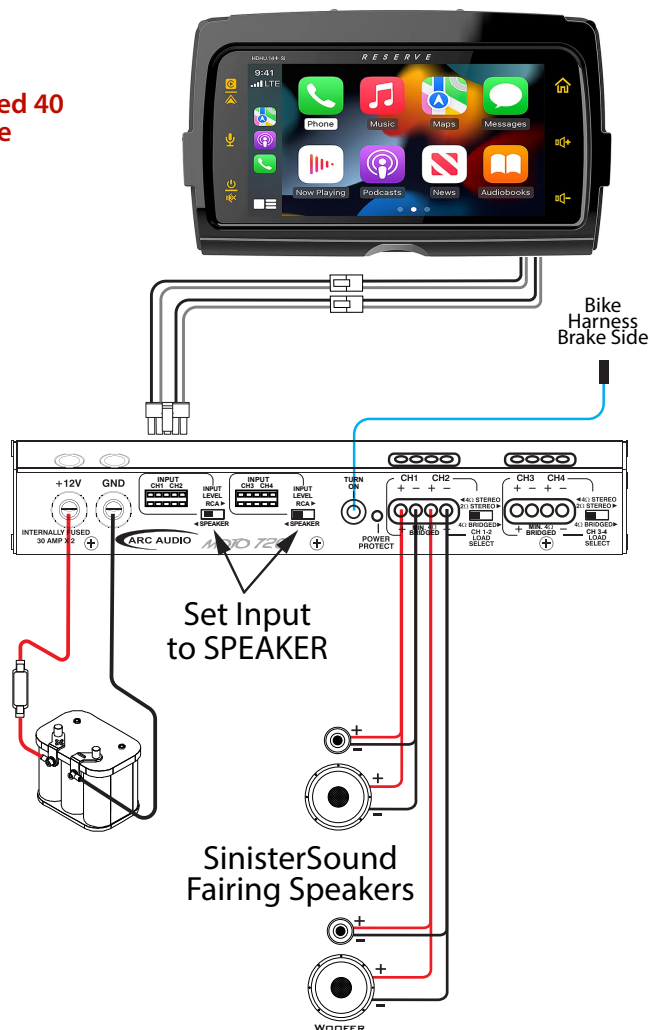

## Amp Settings

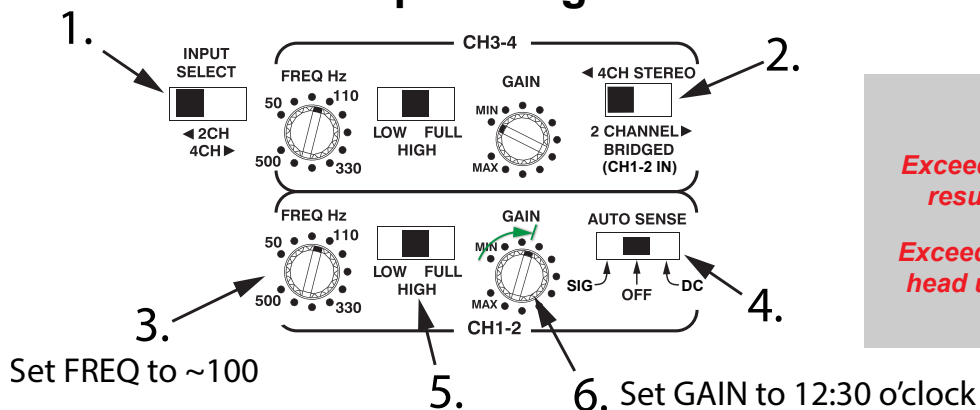

### WARNING!

*Exceeding these gain settings will result in equipment damage!*

*Exceeding the volume of 40 on the head unit will result in equipment damage!*

# MOTO720 SOUNDSTREAM HDHU14S HEAD UNIT - SINISTER FAIRING KIT + LIDS

**!! Do Not exceed 40 on volume**

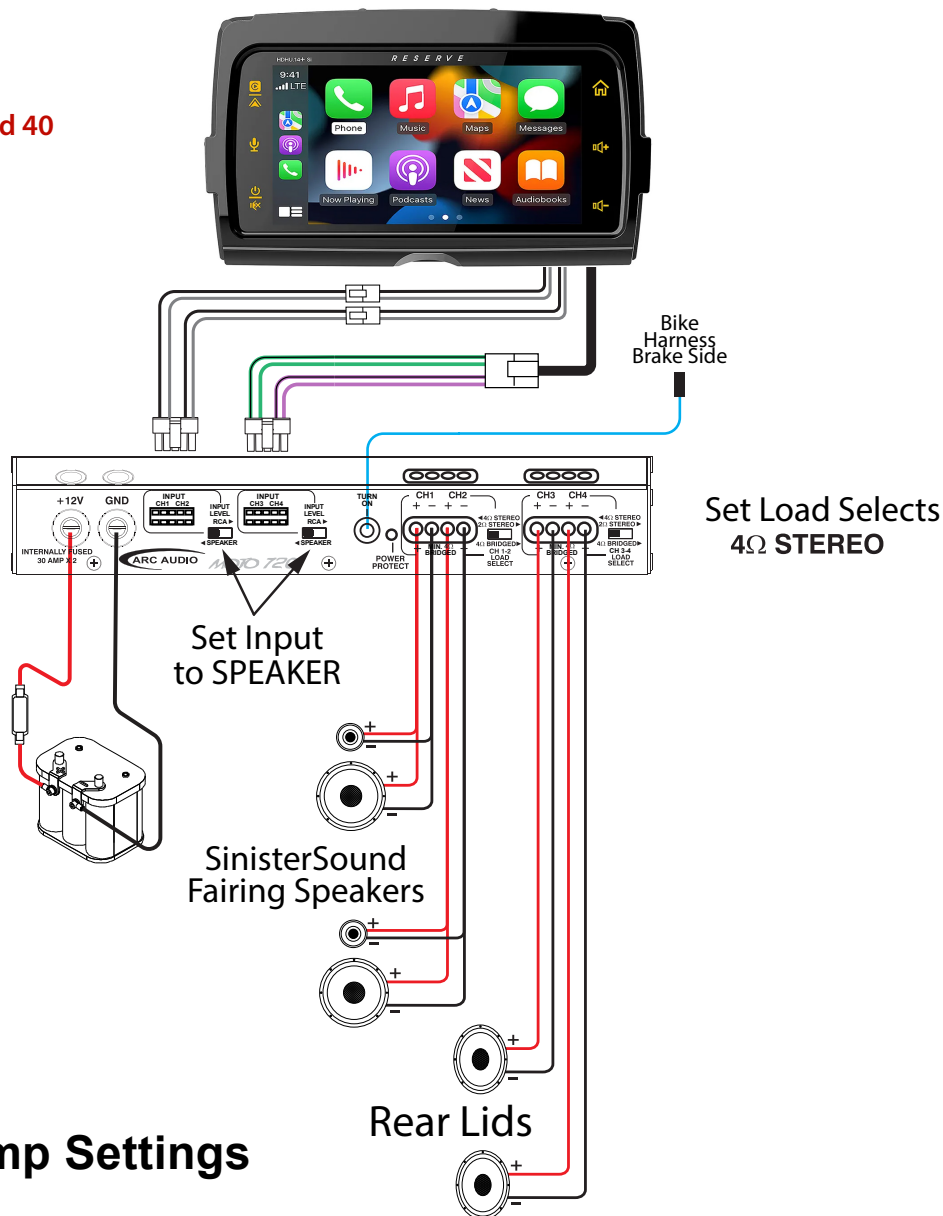

## Amp Settings

Set FREQ to ~110

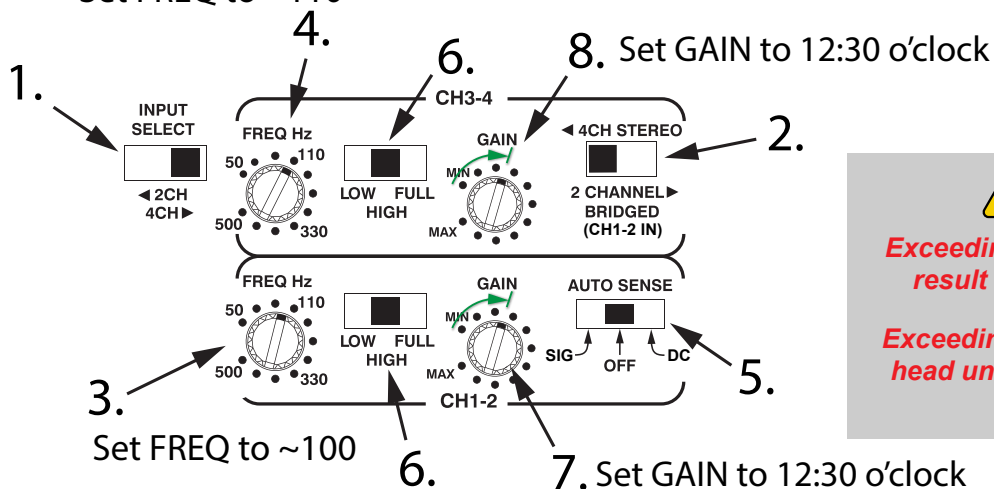

### WARNING!

**Exceeding these gain settings will result in equipment damage!**

**Exceeding the volume of 40 on the head unit will result in equipment damage!**



MOTO720 SOUNDSTREAM HDHU14SI HEAD UNIT - SINISTER FAIRING KIT + CRAZY 8'S

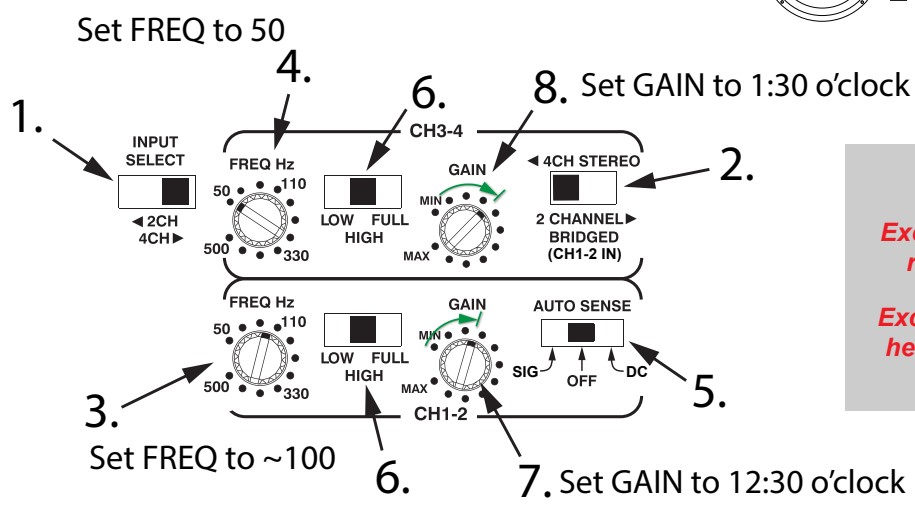
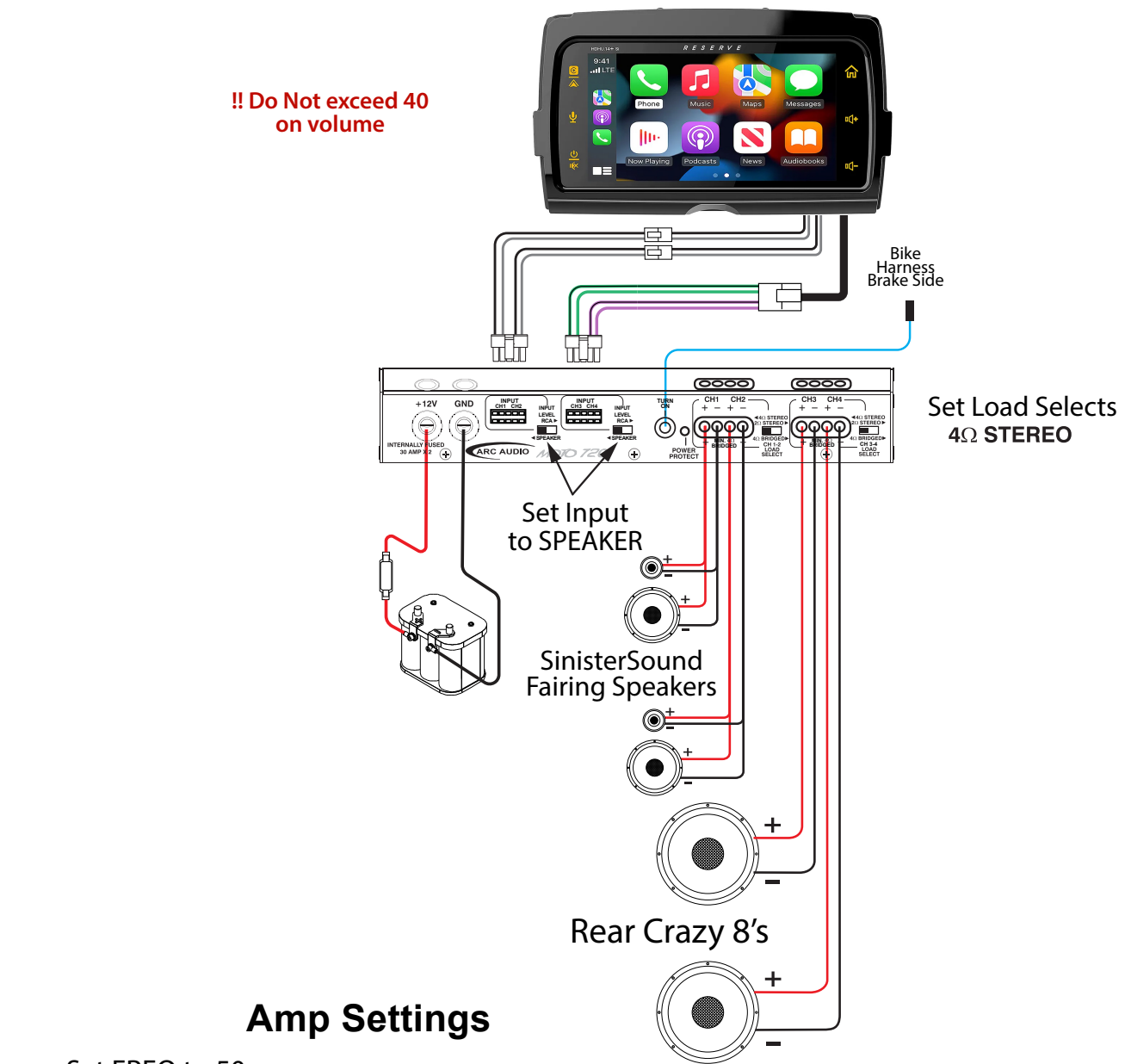

**WARNING!**

Exceeding these gain settings will result in equipment damage!

Exceeding the volume of 40 on the head unit will result in equipment damage!

# MOTO720 SOUNDSTREAM HDHU14S1 HEAD UNIT - SINISTER FAIRING KIT + ULTRA REARS

**!! Do Not exceed 40 on volume**

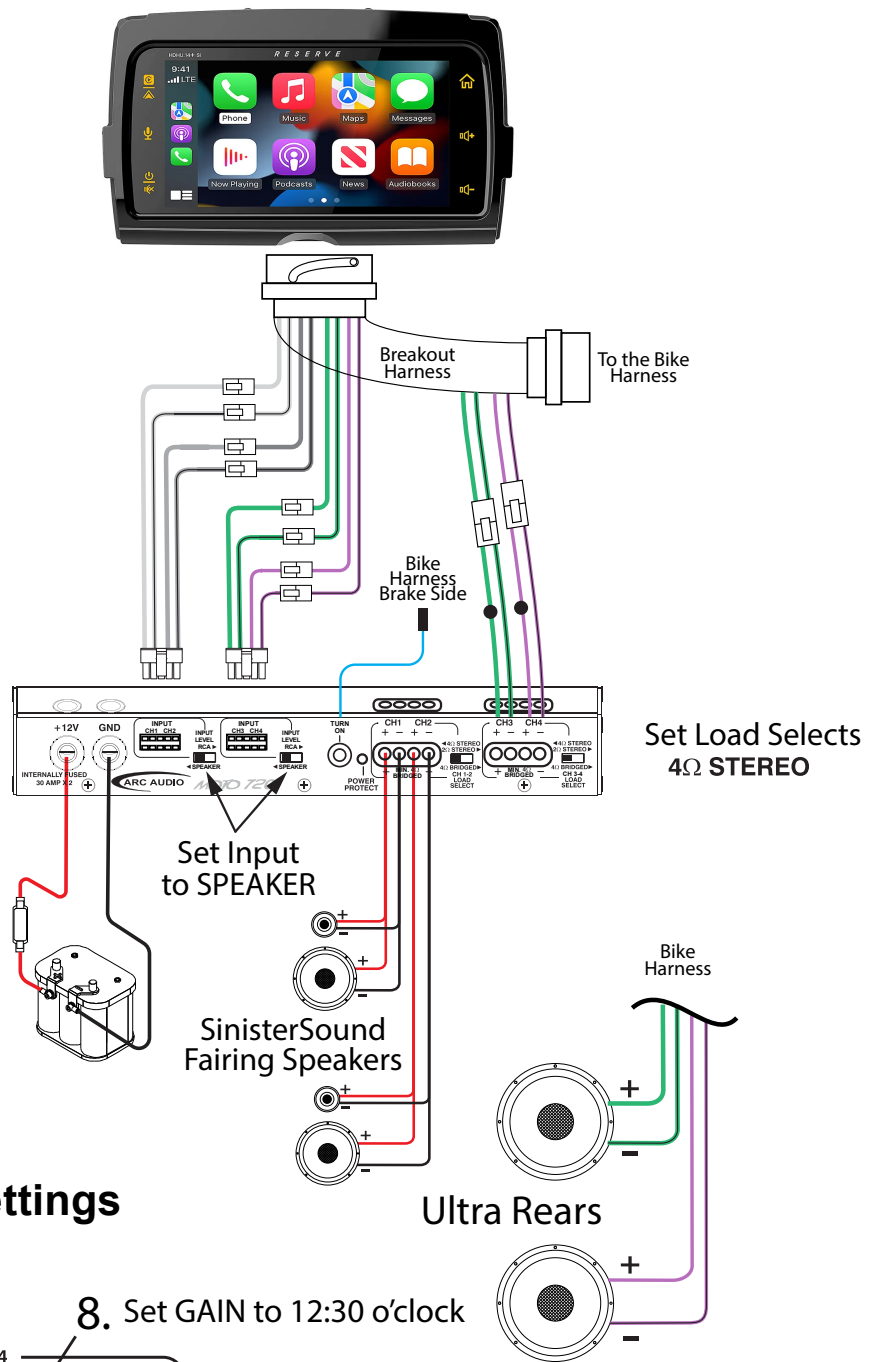

## Amp Settings

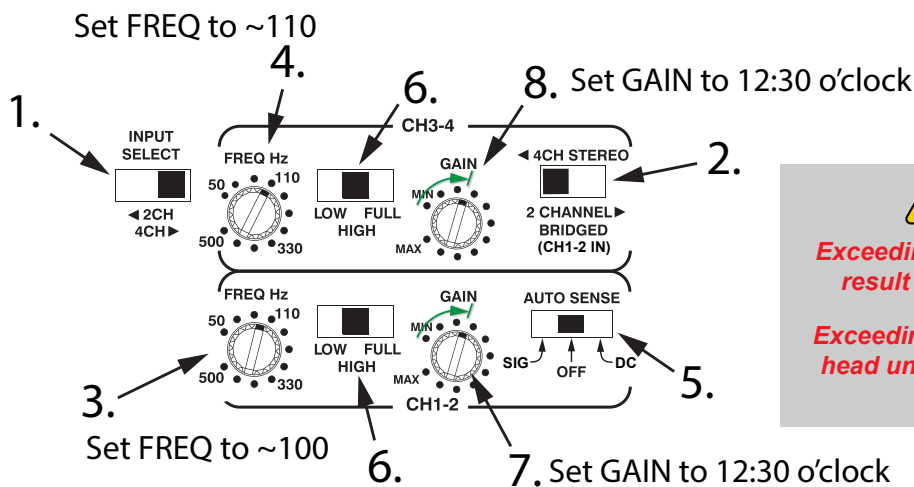

### WARNING!

Exceeding these gain settings will result in equipment damage!

Exceeding the volume of 40 on the head unit will result in equipment damage!

# DIAMOND AUDIO AMPLIFIER WIRING AND SETTINGS

## DIAMOND AUDIO MICRO 2V2

1. Remove the fuse from the SinisterSound power and ground cable.
2. Connect the SinisterSound power and ground cable to the amplifier and route towards the battery through the cable channel under the tank.

**If you are flashing the bike, continue with Step 3. If you are NOT flashing the bike continue to step 4.**

**NOTE: For 19-UP bikes, flash or Line Level Adapters are not required. Make the connections per Step 3.**

3. If you are flashing the bike, you will not need the Line Level Adapter. Use the Speaker Level Input harness to connect to the Molex connector wires (previously removed from the enclosures). Connect the male and female Molex ends. **Skip Step 4.**
4. If you are NOT flashing the bike, connect the Molex connector of the Line Level Adaptor to Molex connectors from the head unit. Connect the RCA harness from the Line Level Adaptor to the amplifier Input ports. Connect the remote turn on wire to the head unit wiring harness.
5. Connect the woofer and tweeter leads together at the amp end being careful not to cross positive and negatives. Connect the speaker pod wires to the CH1 and CH2 output ports on the amplifier.
6. Change the amplifier settings as shown in the table below.
7. Connect the power and ground cable to the battery
8. Insert the fuse on the power and ground cable.
9. Turn bike ignition switch to Accessory.
10. Choose a music source and play.
11. We recommend setting the head unit volume to 70% then slowly increase the gain (SENS) until you start to hear distortion. Then back the gain (SENS) off a few clicks.

**Setting the gains too high and exceeding 70% volume will result in equipment damage! Please call the tech line 1-812-363-2071 with questions!**

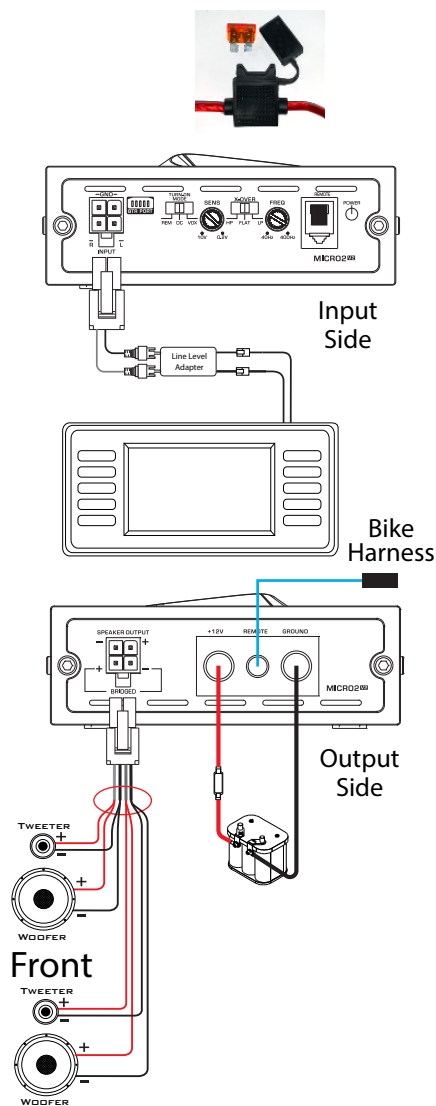

## DIAMOND AUDIO 2V2 AMPLIFIER SETTINGS

### DIAMOND AUDIO 2V2 INPUT SIDE

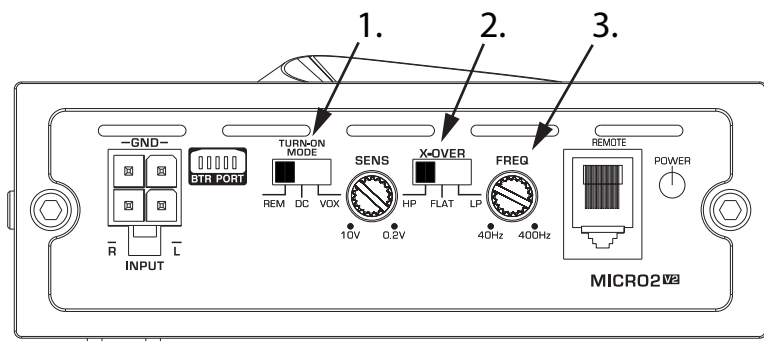

1. SET TURN-ON MODE TO REM
2. SET X-OVER TO HP
3. SET FREQ TO AROUND 100Hz (A COUPLE OF CLICKS CLOCKWISE FROM HORIZONTAL)

## DIAMOND AUDIO MICRO 4V2

1. Remove the fuse from the SinisterSound power and ground cable.
2. Connect the SinisterSound power and ground cable to the amplifier and route towards the battery through the cable channel under the tank.

**If you are flashing the bike, continue with Step 3. If you are NOT flashing the bike continue to step 4.**

**NOTE: For 19-UP bikes, flash or Line Level Adapters are not required. Make the connections per Step 3.**

3. If you are flashing the bike, you will not need the Line Level Adapter. Use the Speaker Level Input harness to connect to the Molex connector wires (previously removed from the enclosures). Connect the male and female Molex ends. **Skip Step 4.**
4. If you are NOT flashing the bike, connect the Molex connector of the Line Level Adaptor to Molex connectors from the head unit. Connect the RCA harness from the Line Level Adaptor to the amplifier Input ports. Connect the remote turn on wire to the head unit wiring harness.
5. Connect the woofer and tweeter leads together at the amp end being careful not to cross positive and negatives. Connect the speaker pod wires to the CH1 and CH2 output ports on the amplifier.
6. Change the amplifier settings as shown in the table below.
7. Connect the power and ground cable to the battery
8. Insert the fuse on the power and ground cable.
9. Turn bike ignition switch to Accessory.
10. Choose a music source and play.
11. We recommend setting the head unit volume to 70% then slowly increase the gain (SENS) until you start to hear distortion. Then back the gain (SENS) off a few clicks.

**Setting the gains too high and exceeding 70% volume will result in equipment damage! Please call the tech line 1-812-363-2071 with questions!**

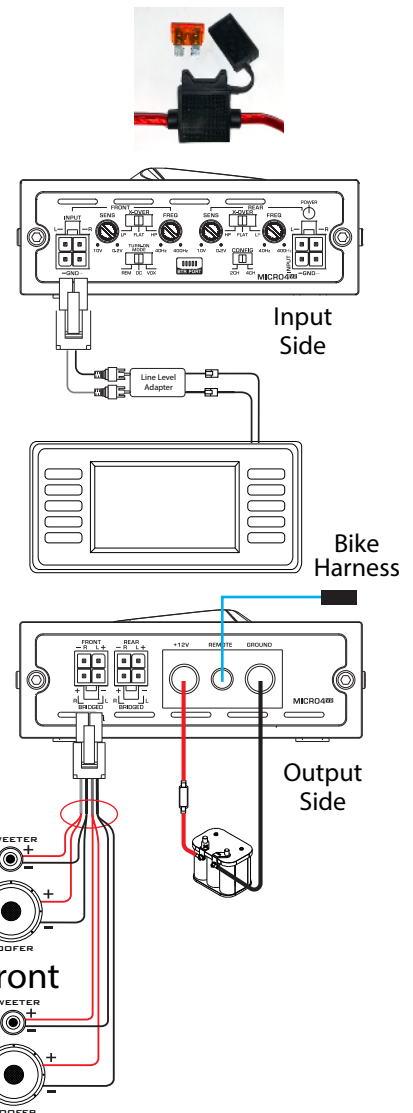

### DIAMOND AUDIO 4V2 AMPLIFIER SETTINGS

#### DIAMOND AUDIO 4V2 INPUT SIDE

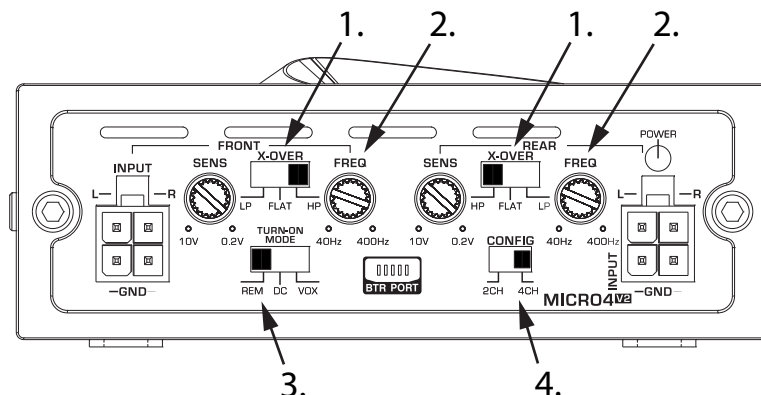

1. SET X-OVER TO HP
2. SET FREQ TO AROUND 100Hz (A COUPLE OF CLICKS CLOCKWISE FROM HORIZONTAL)
3. SET TURN-ON MODE TO REM
4. SET CONFIG TO 4CH

## TESTING AND TUNING

1. Connect the power and ground cable to the battery
2. Insert the fuse on the power and ground cable.
3. Flashing the bike. If you have Line Level adapters OR a 19-UP bike, Skip to Step 4.

Do Not flash the bike if you're using BOOM amps.

***When Flashing 14-UP bikes, set your amp Gain all the way down on the Moto720 on 1-2 channels. When playing at the loudest recommended volume, you will have 5 bars left. Playing beyond this level will result in damage to the system.***

The correct flash for our amps is: Upper Fairing, Rear Pod, No Amp

Perform a pre-calibration reset.

4. Turn bike ignition switch to Accessory.
5. Turn Autospeed **OFF** in the stock head unit options!
6. Choose a music source and play.
7. Check that grip controls are functioning properly.
8. Once you are satisfied that everything is functioning properly, move on to the Finishing the Installation section.



# EQUALIZER SETTINGS

SoundStream HDHU14+ and HDHU14Si EQ Settings Without Crazy 8's

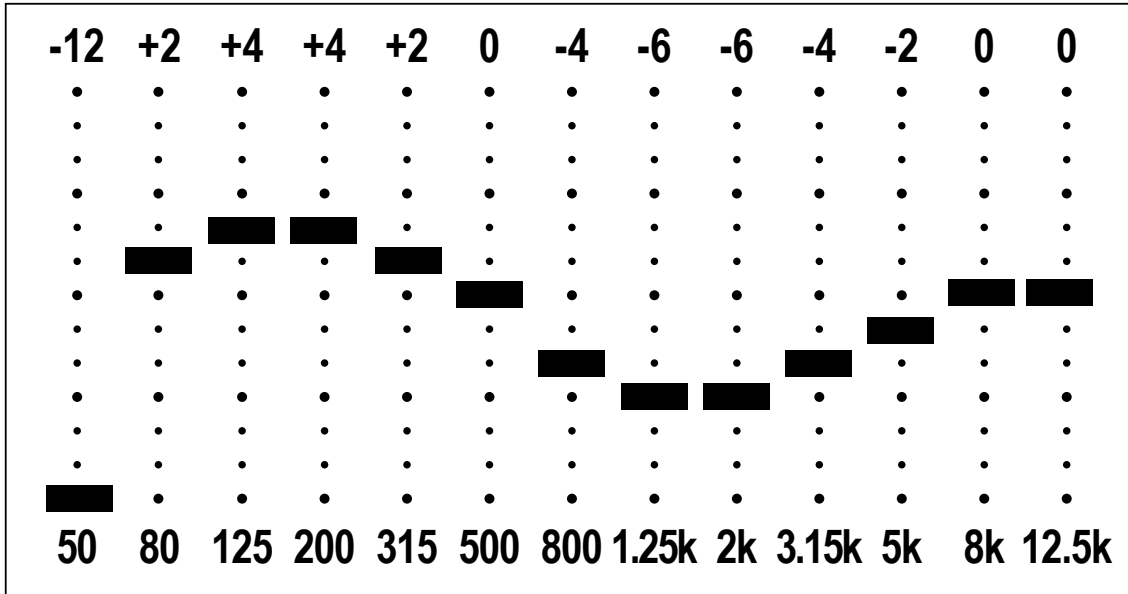

SoundStream HDHU14+ and HDHU14Si EQ Settings With Crazy 8's

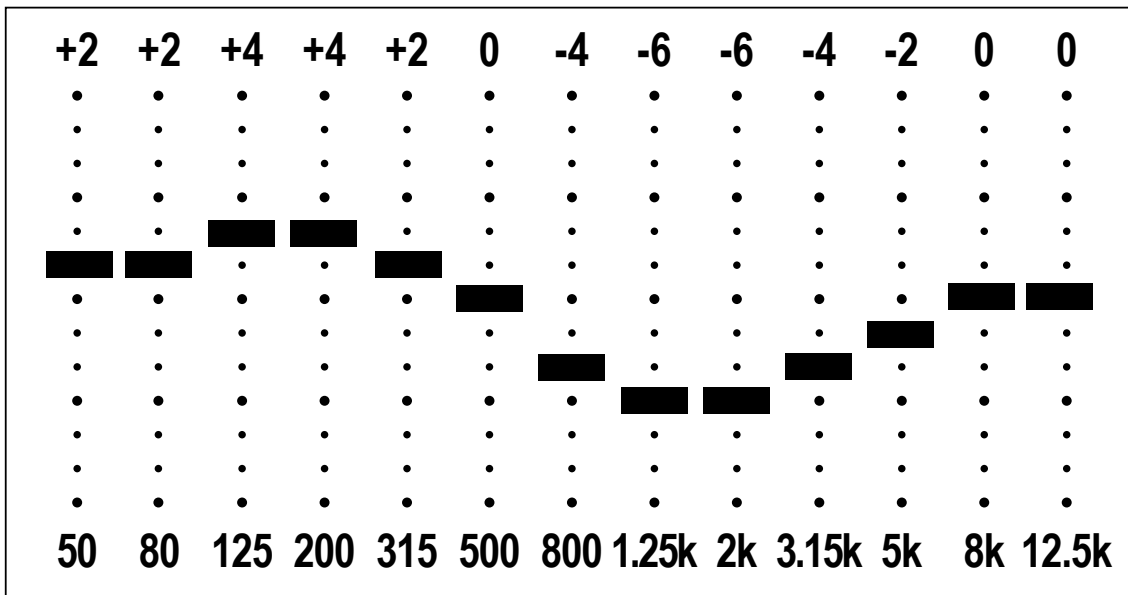

## FINISHING THE INSTALLATION

1

Reinstall fairing.

2

Reinstall seat if previously removed.

3

Enjoy your new system!

