

GO! Wading Pool Love Pillow

Finished Size: 24" x 24"



Fabrics provided by Maywood Studios.

Dies Needed:

GO! Qube Mix & Match 12" Block (55778)

- GO! Square—6-1/2" (6" finished) (Shape 1)
- GO! Square—3-1/2" (3" finished) (Shape 2)
- GO! Half Square Triangle (6" finished square) (Shape 3)
- GO! Rectangle—3-1/2" x 6-1/2" (3" x 6" finished) (Shape 8)

Additional Dies Needed

- GO! Flamingo (55216)
- GO! Strip Cutter—2-1/2" (2" finished) (55014 or 55017)

Fabric Requirements:

Fabric Color	Total Yardage
White	1/2yard
Gray	Fat Quarter (approximately 18" x 22")
Aqua	Fat Quarter
Black	1-1/2 yard
Pink #1	Fat Quarter
Pink #2	10" x 10" square
Muslin pillow top backing	26" x 26"
Batting	26" x 26"
Backing	Included in Black fabric
Fusible	1/4yard

NOTE: apply fusible web to wrong side of appliqué fabrics per manufactures' instructions before die cutting shapes.

Cutting Directions:

Fabric Color	Die	Number of Shapes to Cut
Gray	GO! Square 6-1/2" (6" finished) (Shape 1)	Cut 1—7" x 7" square. Sub cut into 1—6" finished square.
White and Black	GO! Square 3-1/2" (3" finished) (Shape 2)	Cut 2—4" x width of fabric (WOF) strips from EACH color. Fanfold into 4" widths. Sub cut into 14—3" finished squares from EACH color.
Gray and Aqua	GO! Half Square Triangle (6" finished) (Shape 3)	Cut 1—7-1/2" x 16" rectangle of EACH color. Fanfold into 7-1/2" widths. Sub cut into 4—6" finished half square triangles of EACH color.
White and Aqua	GO! Rectangle 3-1/2" X 6-1/2" (3" x 6" finished) (Shape 8)	Cut 1—7" x 16" rectangle from EACH color. Fanfold into 7-1/2" widths. Sub cut into 4—3" x 6" finished rectangles from EACH color.
Pink #1, Pink #2 and Black	GO! Flamingo (55216)	Cut 1 and 1 reversed body from pink #1. Cut 1 and 1 reversed wing from pink #2. Cut 1 and 1 reversed beak from black. Cut 2 eyes from black.
Black	GO! Strip Cutter 2-1/2" (2" finished) (55017 or 55014)	Cut 3—2-1/2" x WOF strips for binding.
Black	Rotary Cut	Cut 2—26" x 18"

Sewing Directions:

Press all seams open and use 1/4" seams, unless otherwise indicated.

Wading Pool

NOTE: Directions will be for one 18" finished block. Make 1 block.

1. Arrange one gray and one aqua 6" finished half square triangle (HST) (Shape 3) together as shown. Pin and sew. Make 4 HST units.
2. Arrange one white and one aqua 3" x 6" finished rectangle (Shape 8) as shown. Pin and sew. Make 4 rectangle units.
3. Arrange two HST units and one rectangle unit as shown. Pin and sew. Make 2 top/bottom rows.
4. Arrange two rectangle units and one gray 6" finished square (Shape 1) as shown. Pin and sew. Make 1 center row.
5. Arrange top/bottom and center row as shown. Pin and sew. Make 1 Wading Pool block.
6. Arrange appliqué shapes on Wading Pool block as shown. Fuse into place per manufactures' instructions. Secure shapes using stitch of choice—straight, narrow zig-zag or blanket stitch. Or use embroidery file [HERE](#).

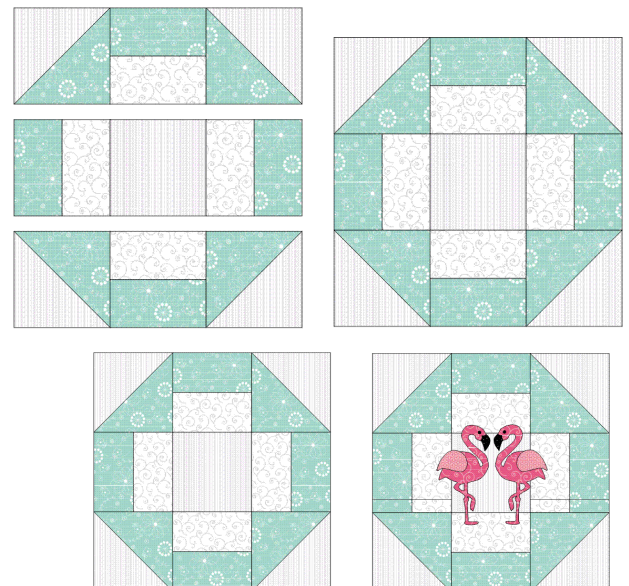
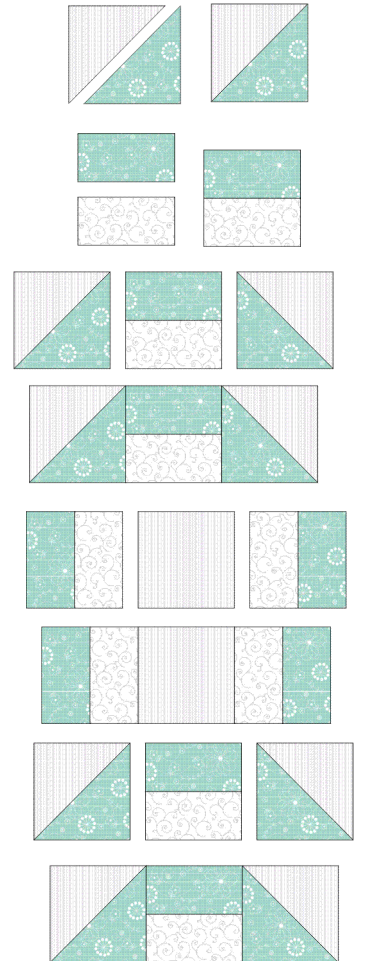

Assemble the Quilt Top

1. Arrange three white and three black 3" finished squares (Shape 2) as shown. Pin and sew. Press seams open. Make 2 side borders.
2. Pin and sew side borders to right and left side of quilt block. Press to borders. Pay attention to border orientation.
3. Arrange four white and four black 3" finished squares (Shape 2) as shown. Pin and sew. Press seams open. Make 2 top/bottom borders.
4. Pin and sew top/bottom borders to quilt center. Press to borders. Pay attention to border orientation. Make 1 pillow top quilt.

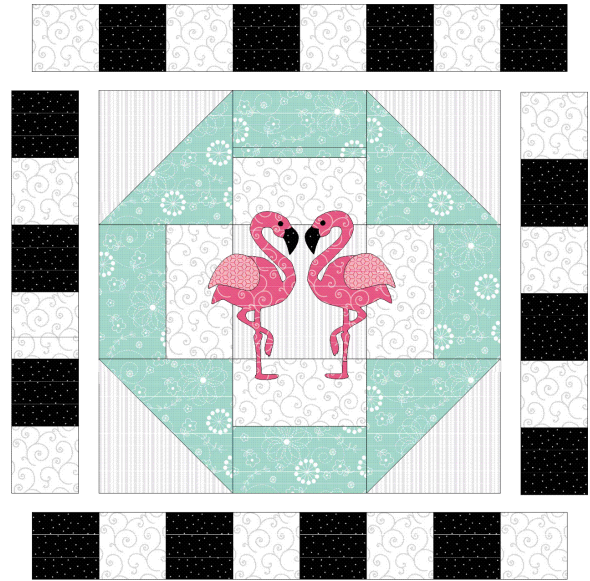

Quilting

1. Layer batting between pillow top and muslin.
2. Pin or baste layers together.
3. Quilt as desired.

Finishing

1. Press a double fold 1/2 hem along one 26" length of each pillow back rectangle.
2. Stitch along 26" length to secure hem.
3. Overlap rectangles to make 26" x 26" square. Baste overlap to secure.
4. Layer pillow top and pillow back wrong sides together and pin.
5. Baste 1/8" from pillow top outer edge to secure layers together.
6. Attach double fold binding to pillow top.
7. Trim pillow sandwich.
8. Fold double fold binding to back and stitch.
9. Insert pillow form and ENJOY!