

Let's Get Frosty!

Sew Along

Part Two

PLEASE READ THROUGH ALL INSTRUCTIONS BEFORE CUTTING

Piecing Tips:

- Use an accurate scant 1/4" seam allowance throughout this project unless specified.
- Starch or Best Press® fabrics before cutting for easier handling. I highly recommend to spray all fabrics and let them dry (to prevent size distortion) then press and cut as instructed.
- Stitch length should be small – 1.8 to 2.0.
- Use thread colour with minimal contrast especially when joining blocks together.
- Drawn diagrams may not show seam allowances – do not trim to match diagram. Refer to the sizes provided.



Step 1: Let's make some Geese!

The following will provide instructions for two methods of making Flying Geese (FG). Both methods will make four Flying Geese at the same time.

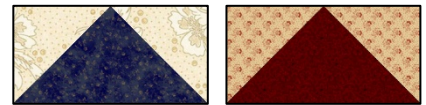

Please review each method and choose your preferred technique.

Follow the appropriate cutting directions for the technique of your choice.

- **Method A** uses the *Small Flying Geese Ruler* (1-1/2" x 3") from *Quilt in a Day™*. This is my preferred method.
- **Method B** is a more traditional one that does not use any special rulers. (Note: this technique is also similar to using the *Wing Clipper™* ruler from Studio 180 Designs. If you use this ruler, adjust cutting sizes as required and follow the instructions provided by the Studio 180 ruler.)

Using products such as these ensures the flying geese units are perfectly sized every time.



Method 1: *Small Flying Geese Ruler* (1-1/2" x 3") from *Quilt in a Day™*

Truthfully, this is my preferred method. They are pretty fast and perfectly sized every single time. This method makes 4 identical units - therefore less cutting and more time saved!

To make (36) <i>Flying Geese</i> units:	
From the Frosty Cream (light) fabric:	Use (1.5) strips 6" x 42" WOF. Subcut strips (9) 6" x 6" squares.
From the Background (dark) fabric:	Use (1) strip 4-1/2" x 42" WOF. Subcut strips (9) 4-1/2" x 4-1/2" squares.

Using the instructions provided with the *Quilt in a Day™* ruler and the following highlighted steps below, make the perfectly sized 2" x 3-1/2" unfinished size Flying Geese units.

1. With a pencil lightly mark on the wrong side of the **Dark Background fabric** squares **diagonally from corner to corner**. With right sides together, center and place marked **Dark Background fabric** square on top of the **Frosty Cream** square.



Border Creek Station Pattern Company

• www.bordercreekstation.com •

Stitch a scant 1/4" away on each side of the drawn line. Cut apart on the drawn line as shown. Open and press to the **large square** fabric.

- With right sides together and with opposite fabrics facing, mark diagonally from corner to corner and stitch 1/4" away from each side of this drawn line. Cut apart on the drawn line. At this cut edge, find center and make a snip into the seam allowance to allow this seam to be pressed in different directions. Press this unit by pressing seams away from the **Dark Background fabric** on opposite ends as shown below.

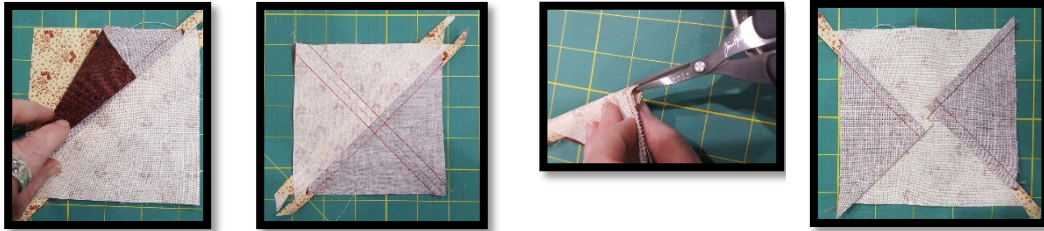

- Using the 1-1/2" x 3" end of the Quilt in a Day ruler, align the red markings just at the V seam allowance so the dotted line (showing the seam allowance) will be above the point. Trim the three sides. Rotate the unit, align markings again as instructed and trim the bottom of the unit. Perfectly sized 2" x 3-1/2" unfin. size Flying Geese.



This will make:	(36) 2" x 3-1/2" unfin. size Flying Geese units
------------------------	---



Method 2: Traditional Flying Geese - for 1-1/2" x 3" Finished Size (2" x 3-1/2" unfin.)

Note: These fabric pieces have been cut larger and the sewn pieces will be trimmed to size.

To make (36) Flying Geese units:	
From the Frosty Cream (light) fabric:	Use (2.5) strips 2-3/8" x 42" WOF. Subcut strips (36) 2-3/8" x 2-3/8" squares.
From the Background (dark) fabric:	Use (1) strip 4-1/4" x 42" WOF. Subcut strips (9) 4-1/4" x 4-1/4" squares.



- With a pencil lightly mark on the wrong side of the (4) 2-3/8" **Frosty Cream fabric** squares **diagonally from corner to corner** as shown by the **solid red lines** in the diagram.
- With right sides together, place (2) marked 2-3/8" **Frosty Cream fabric** squares on top (corners will overlap) of the (1) 4-1/4" **Background Dark fabric** square matching the drawn lines as shown. Pin to secure. Stitch 1/4" away on both sides of drawn line. There will be two small squares remaining.
- Cut apart along drawn line to separate. Open and press seam carefully toward the small triangles. You will have two partial units as shown.
- Place and pin (1) of the remaining 2-3/8" **Frosty Cream fabric** squares right sides together on each unit as shown. Stitch 1/4" away on both sides as before.

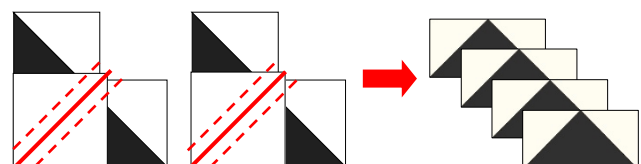
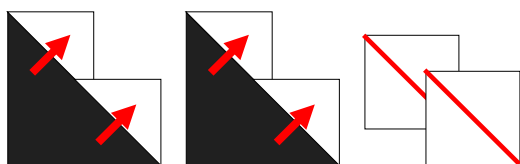
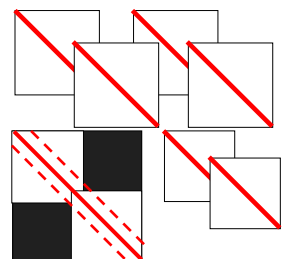

5. Cut apart on marked line and press seam towards the small triangles. This will make 4 identical Flying Geese units. Continue with the remaining squares to make these Flying Geese as required.
6. It may be necessary to trim each flying goose unit to tidy. Each FG unit should measure 2" x 3-1/2" unfinished. Repeat these steps to complete all of flying geese units.

This will make:	(36) 2" x 3-1/2" unfin. size Flying Geese units
------------------------	---



Step 2:

1. As shown in the diagram below, carefully lay out (3) flying geese units in the same orientation and join together. Press seams as indicated by the red arrows.



2. This sewn unit should now measure 3-1/2" x 5" unfinished. Trimming should not be necessary.
3. Continue making these 3 geese units with the remaining flying geese.

Make:	(12) 3-1/2" x 5" unfin. Flying Geese units
--------------	--

Stay tuned for Part 3 on November 8th!



Border Creek Station Pattern Company

• www.bordercreekstation.com •