



Silhouette Cameo

How to Scan a pattern with Silhouette Cameo Software

by Pearl P. Pereira

Copyright 2016

One easy way to import your patterns into the Silhouette program is to simply use the Scan function in the software. Silhouette software has the ability to scan in a design from any connected printer/scanner installed on your computer. You do not need to install these fonts into the program. I am using the Silhouette Designer Edition software.

1. Open the Silhouette program.
2. Click on File in the menu bar.
3. In the drop down window Click on Scan to open the Scanning window.
4. Verify that the software is seeing your scanner.

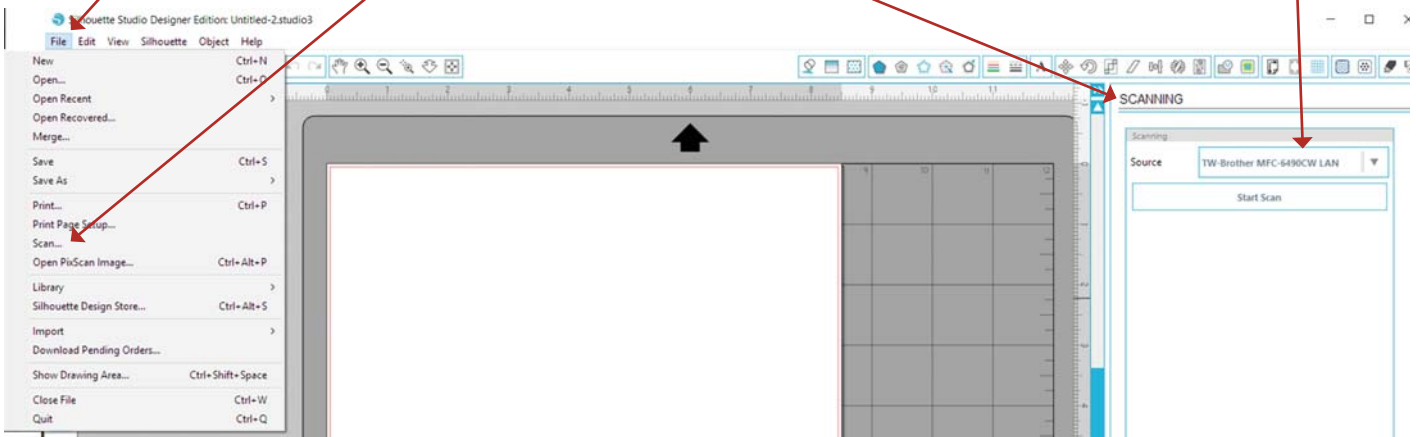

5. Click on Start Scan to open the second Scanning window.

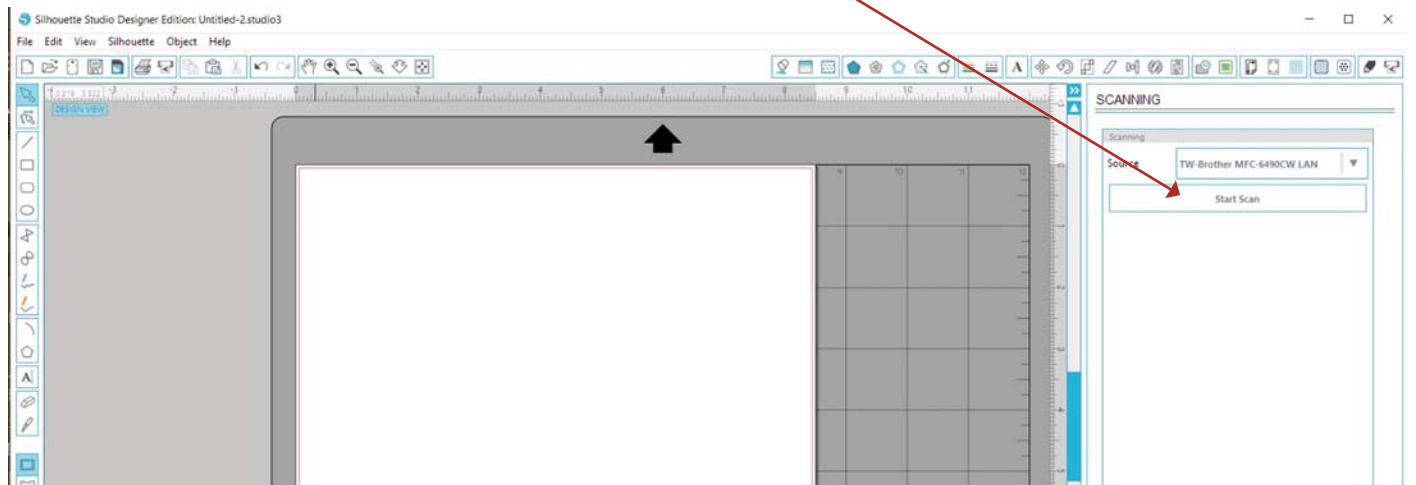

6. Check your settings:

Click Text for black and white drawing.

Select the DPI 300 is good.

Check the paper size you are scanning click the down arrow to see more sizes.

7. Click Start to start the scanner.

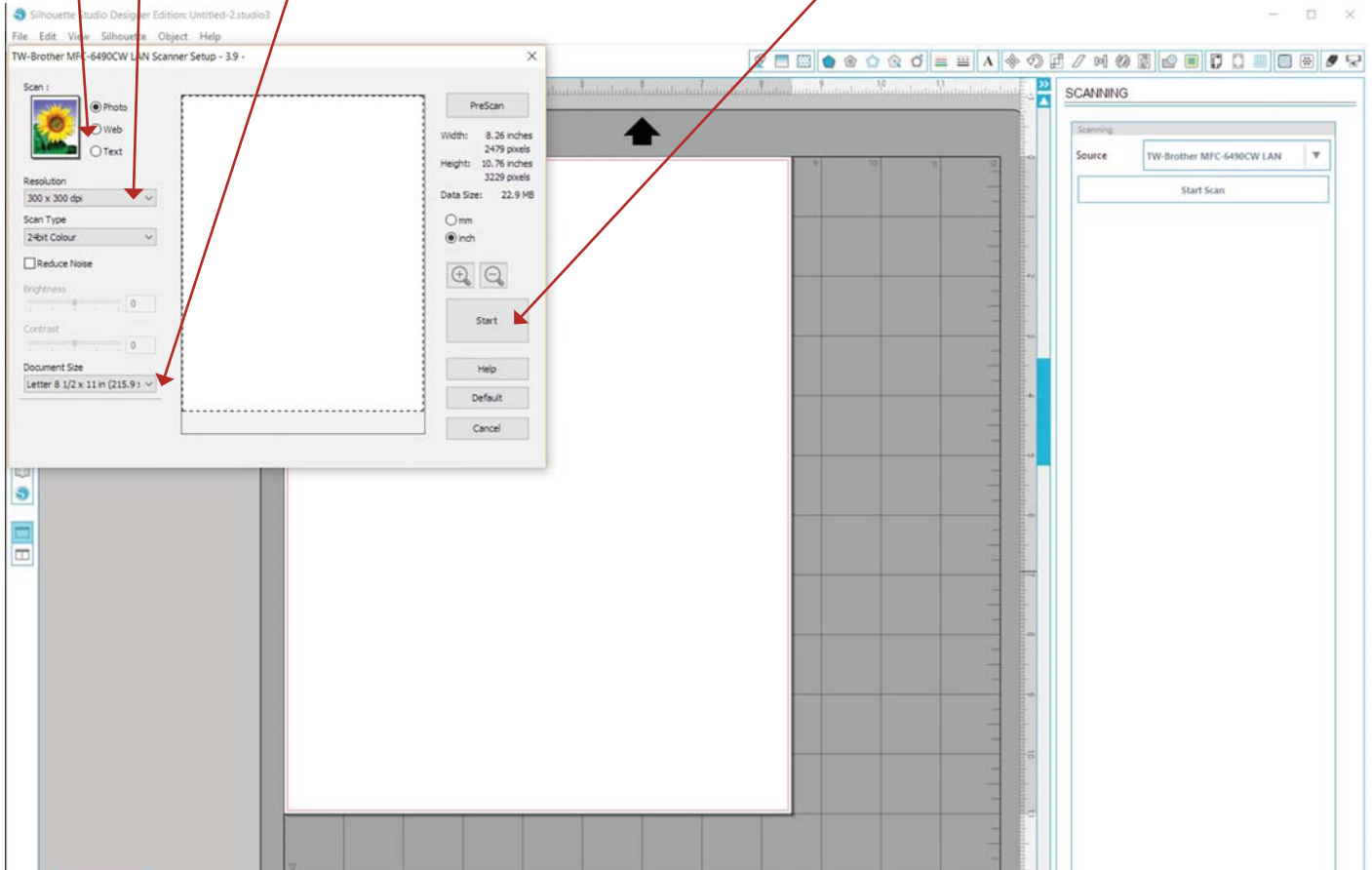

8. A small new window will appear and show the scanning process.

Your scanned design will open up automatically and should appear at 100% scaling.

Hope this will make your scanning easier.

Pearl P. Pereira
P3 Designs
www.p3designs.com