

# Jungle Snap Purse

Finished Project Size: 8" x 9" (20.32cm x 22.86cm)



## Supplies Needed

- 1 - Fat quarter 18" x 21" (45.72cm x 53.34) WMFQ20 – Jungle Animals\* (outer bag)
- 1 - Fat quarter 18" x 21" (45.72cm x 53.34) WMFQ20 – print (lining)
- 1 Metal 9" (22.86cm) coin purse frame with clasp
- Coordinating thread,
- Buttonhole or strong thread to match metal frame
- Removable marker, pencil
- Paper for making pattern
- Quick set glue (the Ultimate) or cool temp glue gun

## Before You Begin

Read all instructions before beginning project. \*For directional fabrics or to place an image centered on purse, purchase a second fat quarter. Press fabrics with a dry iron on cotton setting. Sew with ¼" (6.35mm) seam allowance unless otherwise instructed. RST = sew with right sides together.

# Cutting

1. Make the pattern: place purse frame on paper and trace (use pencil) around top of frame, down sides and mark at hinge as shown. This line will be the sewing line. Mark outside of this line  $\frac{1}{4}$ " (6.35mm) for the cutting line. Next, mark a parallel line 9" (22.86cm) from top of frame for the bottom of bag. From the hinges, mark out  $\frac{1}{2}$ " (12.7mm), then on both sides add 2" (5.08cm), draw line from the 2" (5.08cm) mark to the bottom marked line. Finally, draw a line from the  $\frac{1}{2}$ " (12.7mm) hinge marks out to bottom corners. Cut out the pattern (Dia. A).

Dia. A

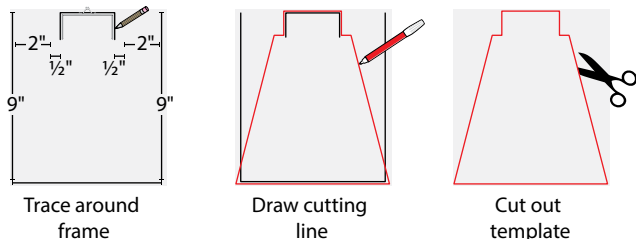

# Sewing

2. Place the fat quarters (outer bag and lining fabrics) right side together. Pin the pattern on top and with removable marker, trace shape. Reposition pattern and trace a second pair of bag shapes. Cut out to make 2 outer bags and 2 linings. Keep pinned together for step 3 (Dia. B).

Dia. B

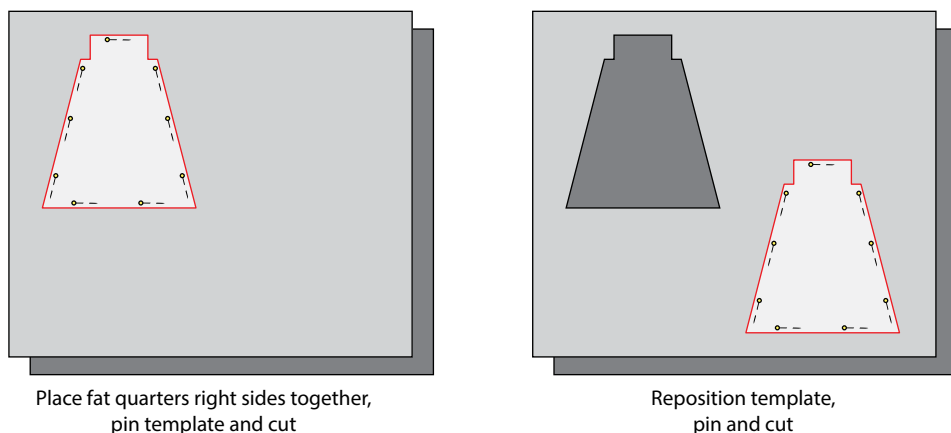

3. Pin around edges. Start sewing at bottom, leave a 4" (10.16cm) opening and sew around with  $\frac{1}{4}$ " (6.35mm) seam. Clip into corner at hinge up to, but not into seam line. Repeat to make two. Turn right sides out. Fold seam allowance at openings in and press (Dia. C).

Dia. C

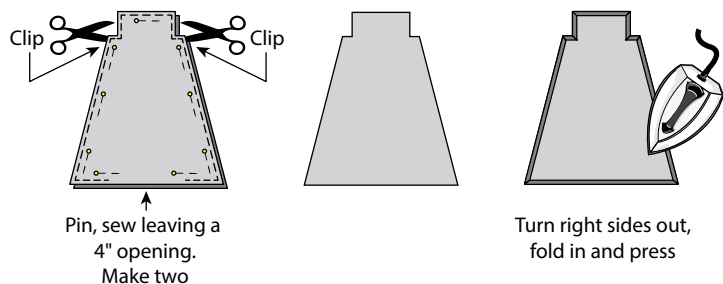

4. Place the outer bag right sides together, pin and sew from hinge seam around bottom to opposite hinge seam close to edge. Backstitch at beginning and end of stitching (Dia. D).

Dia. D

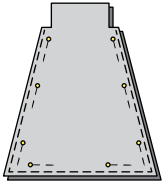

5. To shape (box) the corners, match the bottom seam with the side seam, pin and mark 1" (2.54cm) from point. Sew on the line. Trim 1/4" (6.35mm) from line and zigzag finish the raw edges. Turn bag right side out (Dia. E).

Dia. E

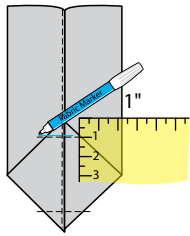

Match bottom seam with side seam, pin, and sew

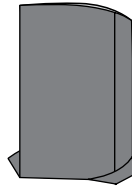

Turn right side out

6. To insert bag into frame, place a thin line of glue into the frame channel. Push top of bag into the channel using the skewer. Work with one half at a time and let set before finishing. **Note:** Use a thin line of glue so it does not drip and you can sew through it. Hot glue will heat frame so is not recommended (Dia. F).

Dia. F

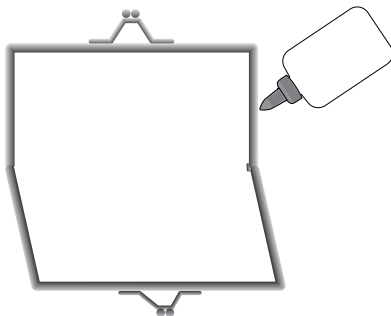

Add glue to frame

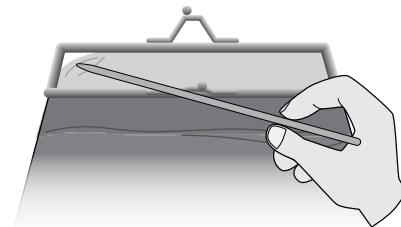

Work with one half at a time

7. Using double strand of buttonhole thread sew through frame holes to secure bag (Dia. G).

Dia. G



Sew through frame holes

## Finished Care Instructions

Hand wash and air dry flat.