

INTERMEDIATE  
SKILL

# Snowy Runners

Designed by Hilary Bobker of And It Was Sew  
featuring the *Winter Whisper* collection by *Whistler Studios*  
SIZE: 22-1/2" x 47-1/2"

FREE  
PROJECT

SNOWY DAY RUNNER

SNOWY NIGHT RUNNER



THIS IS A DIGITAL REPRESENTATION OF THE QUILT TOP, FABRIC MAY VARY.

**PLEASE NOTE:** BEFORE MAKING YOUR PROJECT, CHECK FOR ANY PATTERN UPDATES AT [WINDHAMFABRICS.COM](http://windhamfabrics.com)'S FREE PROJECTS SECTION.



# Snowy Runners

**PROJECT DISCLAIMER:** Every effort has been made to ensure that all projects are error free. All the information is presented in good faith, however, no warranty can be given nor results guaranteed. Therefore, we assume no responsibility nor damages that may occur when referring to this pattern. When errors are brought to our attention, we make every effort to correct and post a revision as soon as possible. We suggest you check [windhamfabrics.com](http://windhamfabrics.com) for pattern updates and to test the pattern prior to making the project. Test templates first, before cutting all the pieces. Free projects are not for resale.

WOF = WIDTH OF FABRIC



KEY	FABRIC	SKU	YD	CUTTING INSTRUCTIONS
A		54682-6 Sky	3/8	<b>SNOWY DAY RUNNER</b>  <b>Blocks:</b> (1) 2-1/2" x WOF strip; subcut (12) 2-1/2" squares. (1) 4-1/2" x WOF strip; subcut (12) 2-1/2" x 4-1/2" rectangles.  <b>Cornerstones:</b> (1) 1-1/2" x WOF strip; subcut (14) 1-1/2" squares.
B		54680-2 Day	1/2	<b>Background:</b> (1) 12-1/2" x WOF strip; subcut (1) 12-1/2" square and cut diagonally in half twice for setting triangles. (2) 6-1/2" squares and cut diagonally in half once for corner triangles.
C		54682-5 Ice	3/8	<b>Blocks:</b> (2) 2-1/2" x WOF strips; subcut (24) 2-1/2" squares. (2) 1-1/2" x WOF strips; subcut (12) 1-1/2" squares and (12) 1-1/2" x 2-1/2" rectangles.
D		54683-2 Day	1/4	<b>Blocks:</b> (1) 2-1/2" x WOF" strip; subcut (3) 2-1/2" squares. (1) 1-1/2" x WOF strip; subcut (24) 1-1/2" squares.
E		52782-2 Sand INCLUDES BINDING	5/8	<b>Inner Border:</b> (3) 1-1/2" x WOF strips. <b>Sashing:</b> (3) 1-1/2" x WOF strips; subcut (12) 1-1/2" x 8-1/2" strips. <b>Binding:</b> (4) 2-1/2" x WOF strips.
F		54679-1 Snow	5/8	<b>Outer Border:</b> (3) 4-1/2" x WOF strips.
		Backing	1-1/2	30" x 56" piece of batting.



# Snowy Runners

**PROJECT DISCLAIMER:** Every effort has been made to ensure that all projects are error free. All the information is presented in good faith, however, no warranty can be given nor results guaranteed. Therefore, we assume no responsibility nor damages that may occur when referring to this pattern. When errors are brought to our attention, we make every effort to correct and post a revision as soon as possible. We suggest you check [windhamfabrics.com](http://windhamfabrics.com) for pattern updates and to test the pattern prior to making the project. Test templates first, before cutting all the pieces. Free projects are not for resale.

WOF = WIDTH OF FABRIC

KEY	FABRIC	SKU	YD	CUTTING INSTRUCTIONS
A		54683-8 Midnight	3/8	<b>SNOWY NIGHT RUNNER</b>  <b>Blocks:</b> (1) 2-1/2" x WOF strip; subcut (12) 2-1/2" squares. (1) 4-1/2" x WOF strip; subcut (12) 2-1/2" x 4-1/2" rectangles.  <b>Cornerstones:</b> (1) 1-1/2" x WOF strip; subcut (14) 1-1/2" squares.
B		54680-3 Night	1/2	<b>Background:</b> (1) 12-1/2" x WOF strip; subcut (1) 12-1/2" square and cut diagonally in half twice for setting triangles. (2) 6-1/2" squares and cut diagonally in half once for corner triangles.
C		54683-2 Day	3/8	<b>Blocks:</b> (2) 2-1/2" x WOF strips; subcut (24) 2-1/2" squares. (2) 1-1/2" x WOF strips; subcut (12) 1-1/2" squares and (12) 1-1/2" x 2-1/2" rectangles.
D		54682-3 Night	1/4	<b>Blocks:</b> (1) 2-1/2" x WOF" strip; subcut (3) 2-1/2" squares. (1) 1-1/2" x WOF strip; subcut (24) 1-1/2" squares.
E		37098-12 Chalk INCLUDES BINDING	5/8	<b>Inner Border:</b> (3) 1-1/2" x WOF strips. <b>Sashing:</b> (3) 1-1/2" x WOF strips; subcut (12) 1-1/2" x 8-1/2" strips. <b>Binding:</b> (4) 2-1/2" x WOF strips.
F		54682-6 Sky	5/8	<b>Outer Border:</b> (3) 4-1/2" x WOF strips.
		Backing	1-1/2	30" x 56" piece of batting.



# Snowy Runners

THESE INSTRUCTIONS SHOW THE **SNOWY DAY RUNNER** VERSION OF THE PATTERN.

## INNER STAR BLOCK

1. **Flying Geese Units:** Draw a diagonal line on the wrong side of (1) **D** 1-1/2" square. Place square, right sides together, at a corner of (1) **C** 2-1/2" x 1-1/2" rectangle. Sew on drawn line. Trim 1/4" away from sewn line. Open and press to reveal **D** corner triangle. Repeat with another **D** square on the opposite corner of the same **C** rectangle. Make (12).

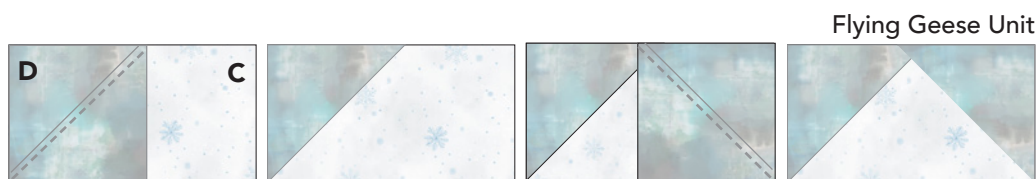

Sew on drawn line. Trim 1/4" and open to reveal **D** corner triangle.  
Repeat on opposite corner.

Make (12) of **D/C**.

2. **Rows 1 & 3:** Sew (2) **C** 1-1/2" squares to the opposite short sides of (1) Flying Geese Unit from Step 1. Make (2).
3. **Row 2:** Sew (2) Flying Geese Units **D/C** to the opposite sides of (1) **D** 2-1/2" square. Make (1).

NOTE ROTATION AND PLACEMENT OF UNITS.

4. Sew Rows 1 & 3 units to the opposite long sides of Row 2 unit to complete Inner Star Block, as shown. Make (3).

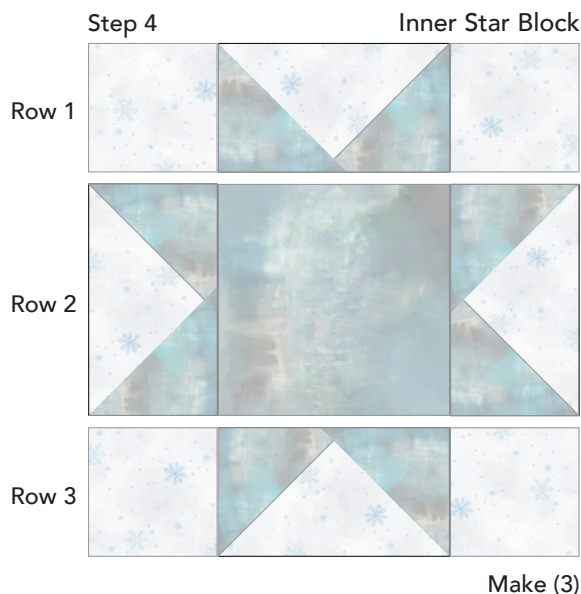
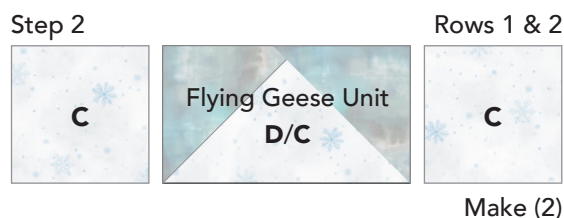





# Snowy Runners

## OUTER STAR BLOCK

5. Flying Geese Unit: Repeat Step 1 using (2) **C** 2-1/2" squares and (1) **A** 4-1/2" x 2-1/2" rectangle. Make (12).

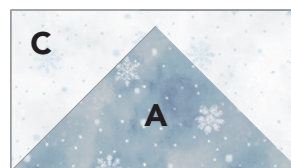

Make (12) of **C/A**.

6. Rows 1 & 3: Repeat Step 2 using (2) **A** 2-1/2" squares and (1) Flying Geese Unit **C/A**. Make (2).
7. Row 2: Repeat Step 3 using (2) Flying Geese Units **C/A** and (1) Inner Star Block. Make (1).
8. Sew Rows 1 & 3 units to the opposite long sides of Row 2 unit to complete Outer Star Block, measuring 8-1/2" square unfinished. Make (3).

Step 6



Make (2)

Step 7

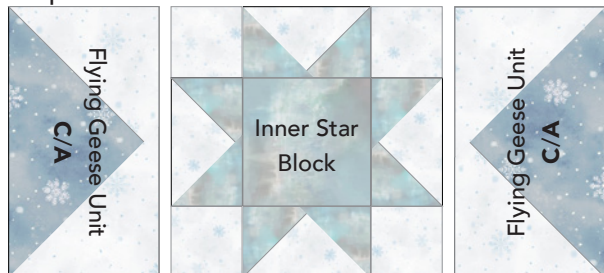

Make (1)

Step 8

Outer Star Block

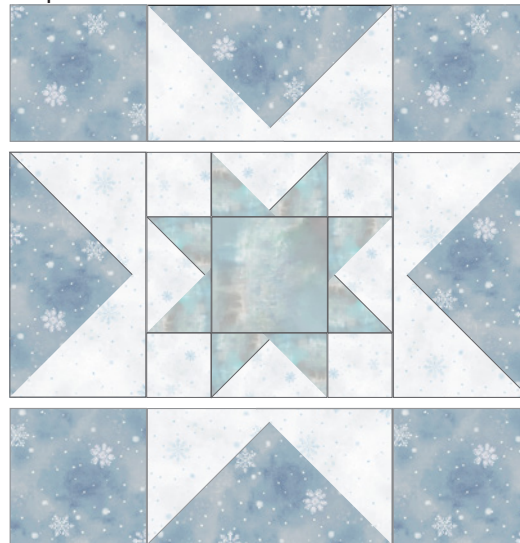

Make (3)

Measures: 8-1/2" square unfinished.

## CENTER ASSEMBLY

9. Sew (1) **E** 1-1/2" x 8-1/2" sashing strip on the left and right sides of (1) Outer Star Block. Make (3).

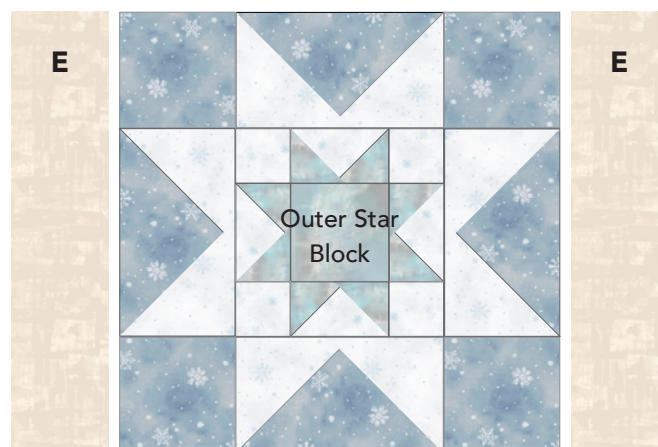



# Snowy Runners

## SASHING STRIP

10. Single: Sew (2) **A** 1-1/2" squares to the ends of (1) **E** 1-1/2" × 8-1/2" rectangle. Make (2).



11. Double: Alternating, sew together (3) **A** 1-1/2" squares and (2) **E** 1-1/2" × 8-1/2" rectangles. Make (2).



12. Mark the center of all **B** 6-1/2" Corner Triangles, Sashing Strips, and Star Blocks.

Step 13

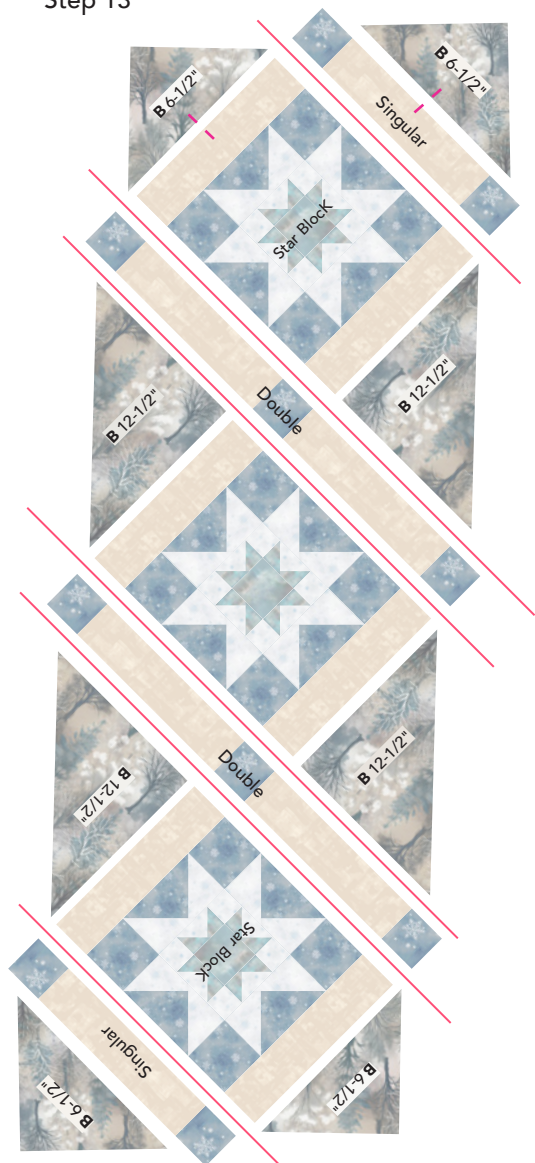

13. Noting rotation of units, lay out Setting Triangles, Corner Triangles, Sashing Strips and Star Blocks into diagonal rows. Sew into diagonal rows, aligning a short side of each Setting Triangle with the adjoining Star Block. Match center point of each Corner Triangle and Sashing Strip or Star Block as you join them. Sew diagonal rows together.

14. Trim 1/4" away from the center of the cornerstones while squaring up the center, as shown in diagram below. The dotted line is the sewing line and the solid line is the cutting line.

Step 14

1/4" trim





# Snowy Runners

## BORDERS

MEASURE DOWN AND ACROSS THE MIDDLE OF THE CENTER BLOCKS FOR EACH BORDER.

- 15. Inner Border:** Trim (2) **E** 1-1/2" x WOF strips to the long measurement and sew to each side of the runner. Trim (1) **E** 1-1/2" x WOF strip to the short measurement for the top and bottom. Add (1) **A** 1-1/2" cornerstone square to each end and sew to the top and bottom of the runner.
- 16. Outer Border:** Sew the (2) **F** 4-1/2" x WOF strips to each side of the runner. Trim excess. Measure across the middle on the center, including **Inner Borders**. Trim the remaining **F** 4-1/2" x WOF strip to this length and sew to the top and bottom.



**FINISHING:** Layer quilt top, batting and backing together to form quilt sandwich. Baste and quilt as desired. Bind using **E** 2-1/4" strips.