

Pins & Needles

Applique Quilt Block of the Month Completion of Quilt

Instructor: **Lynne Johngrass**

Location: Middleburg Heights

Phone Number: 440-243-6400

Project: Stitcher's Garden Completion

Supply List:

- See attached Finishing Directions for yardage
- Rotary cutter
- Rotating or 24" cutting mat
- Small ironing pad and iron
- Construction thread
- 1x6 inch ruler
- 12x6 inch or larger ruler
- * Basic Sewing Supplies

***Basic Sewing Supplies**

- Sewing Machine, Power Cord, & Foot Pedal
 - Sewing Bobbins
 - Scissors
- Pins / Wonder Clips / Frixion Marking Pen
 - Sewing Needles 90/14 Quilting
 - Sew Steady/Quilting Table
 - ¼ inch foot

Before Class:

Bring all your Finished Blocks and leftover fabrics you have used in your quilt to class. Make sure you have completed the blocks with the required sashing listed for each block. Before class, please cut fabrics for Frame, Lattice and Sawtooth Block according to attached sheet. Mark all pieces you cut. We will begin construction of the quilt in class.

Class will start and end promptly—please be set up and ready to begin class on time.



Your payment is your commitment to your class and to the instructor. The class may be postponed or refund issued IF a minimum enrollment is not met. You must give a 3-day notice to transfer the fee to another class. Student must have basic knowledge of their own sewing machine, including how to operate and thread your own machine. **Please note:** Neither your instructor or Pins & Needles can be responsible for forgotten supplies and/or equipment. Please be sure to have all of your supplies properly labeled.

Stitcher's Garden

FINISHING DIRECTIONS

© Copyright 2009
Lynda Howell

YARDAGE

Frame (center blocks):	¼ yd.	Frame inner border/binding:	1 ¼ yd.
Lattice:	½ yd.	OR one piece for length	2 yds.
Sawtooth block:	leftover from other blocks 2 greens - fat quarters	Inner border/outer pieced border:	1 yd. each of 2 colors
		Outer border:	1 yd.
		OR one piece for length	2¾ yds.

CUTTING

FRAME around 4 center blocks:

- cut - 2 - 1½" x 28½" strips
2 - 1½" x 30½" strips

LATTICE:

- A. cut 6 - 2½" x 16½"
B. cut 4 - 2½" x 6½"
C. cut 2 - 2½" x 8½"
D. cut 2 - 2½" x 14½"
E. cut 8 - 1¾" x 5½"

SAWTOOTH BLOCK:

1. Cut 1 - 3" square of 8 different prints and 8 - 3" squares of background.
2. Place a background and print together. Draw line down the center.
3. Stitch ¼" from each side of the line.

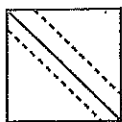

4. Cut on the drawn line. Press toward the print. Total of 16 squares.

7. Cut then sew to the blocks, 2 - 1½" x 16½" strips.

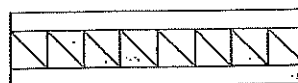

8. Repeat for second set of blocks.

