

## WASHINGTON POSTLITE DETAIL

HOLOPHANE CATALOG • SMA16F5J13P07LABBK S168A E 120A  
BAB24B4 EBB BK - WAUE1004KASB5B6HL25PCS

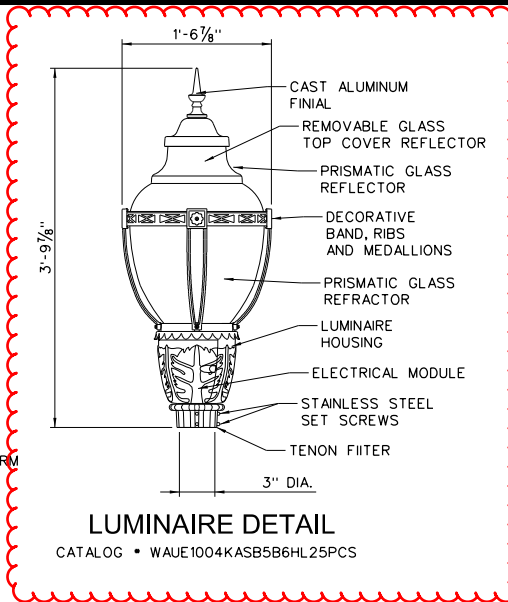

USE LUMINAIRE PER  
HOLOPHANE  
DRAWING #  
TSG008229  
(SEE ATTACHED)

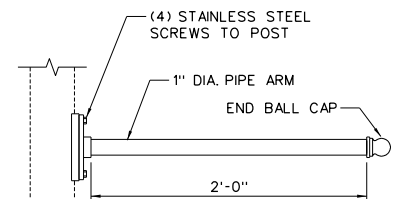

## 24" BANNER ARM

CATALOG • BAB24B4 EBB BK

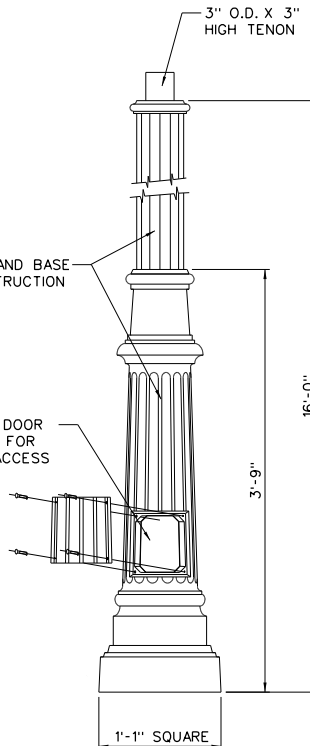

## POST DETAIL

CATALOG • SMA16F5J13P07LABBK

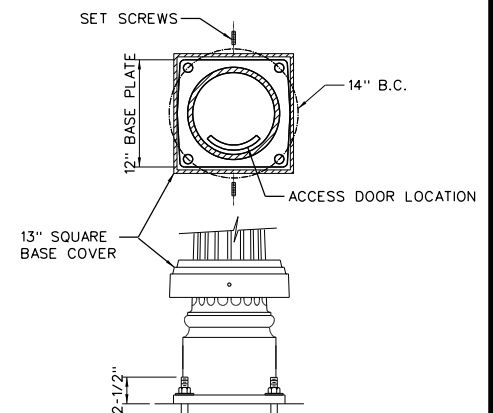

SEE CONCRETE OR SCREW FOUNDATION DETAILS ON STANDARD DRAWING • 23d

## ANCHORAGE DETAIL

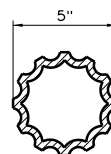

## 5" DIA. FLUTED SHAFT CROSS SECTION

APPROVED EQUAL PARTS MAY BE SUBSTITUTED FOR THE HOLOPHANE PRODUCTS SPECIFIED ON THIS STANDARD DRAWING.



### STATEMENT OF USE

THIS DOCUMENT AND ANY ILLUSTRATIONS HEREON ARE PROVIDED AS STANDARD CONSTRUCTION DETAILS WITHIN LONDON CITY. DEVIATION FROM THIS DOCUMENT REQUIRES APPROVAL OF LONDON CITY. LONDON CITY CORPORATION AND J-U-B ENGINEERS CAN NOT BE HELD LIABLE FOR MISUSE OR CHANGES REGARDING THIS DOCUMENT.

### REVISION

NO.	DESCRIPTION	BY	APR.	DATE
2	UPDATE CATALOG NUMBER	M.C.	M.C.	8/10/10
3	SPELLING REVISION	BTW	M.C.	12/06/11
4	UPDATE CATALOG NUMBERS	EEA	M.C.	11/03/14
5	REMOVED RECEPTACLE PER ROCKY MTH POWER REQUIREMENTS	NDG	NDG	08/24/20



## WASHINGTON POSTLITE LED STREET LIGHT

LONDON CITY  
100 NORTH STATE

STANDARD DRAWING NUMBER:	23a
CAD DWG: LC_StdDwg.dgn	
PLOT SCALE:	1:000
DRAWN BY:	CJC
DESIGN BY:	MLC
CHECKED BY:	MLC
ADOPTED DATE:	24 AUG 20

