

120' HAMMERHEAD DETAIL

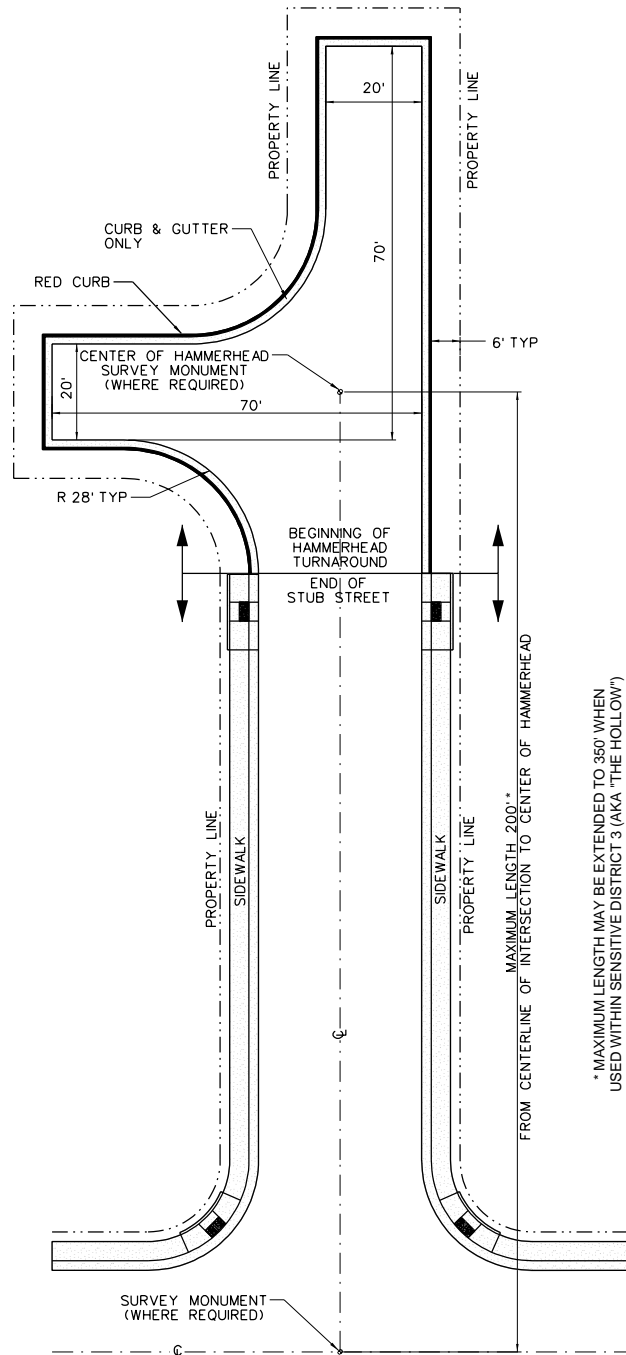

ACCEPTABLE ALTERNATIVE
TO 120' HAMMERHEAD DETAIL

HAMMERHEAD TURNAROUNDS ARE INTENDED TO BE USED ONLY IN EXCEPTIONAL CIRCUMSTANCES AND ONLY IN RESIDENTIAL LAND USE ZONES. THE FOLLOWING RESTRICTIONS APPLY TO THEIR USE:

1. HAMMERHEAD TURNAROUNDS MAY NOT BE USED IF A STANDARD CUL-DE-SAC IS FEASIBLE WHILE STILL PERMITTING CREATION OF AND ACCESS TO AT LEAST TWO LOTS THAT MEET ALL CODE CONDITIONS (LOT SIZE, FRONTAGE, ETC).
2. NO MORE THAN TWO LOTS MAY HAVE ACCESS FROM A HAMMERHEAD TURNAROUND (OR COUNT FRONTAGE FROM THE HAMMERHEAD TURNAROUND).
3. NO MORE THAN FOUR LOTS MAY ACCESS A STUB STREET WITH A HAMMERHEAD TURNAROUND (AS MEASURED FROM THE CENTER OF THE NEAREST INTERSECTION).
4. LOTS HAVING ACCESS TO THE HAMMERHEAD TURNAROUND MUST PROVIDE A MINIMUM OF 3 OFF-STREET PARKING SPACES PER DWELLING UNIT.
5. NO ON-STREET PARKING IS PERMITTED WITHIN A HAMMERHEAD TURNAROUND.
6. ONLY THOSE HAMMERHEAD TURNAROUNDS SHOWN IN THE LINDON STANDARD DETAILS MAY BE USED. THEY MUST ALSO MEET THE MINIMUM REQUIREMENTS OF THE A TURNAROUND IN APPENDIX A OF THE INTERNATIONAL FIRE CODE.
7. SIDEWALK IS OPTIONAL AROUND THE HAMMERHEAD TURNAROUND.



STATEMENT OF USE

THIS DOCUMENT AND ANY ILLUSTRATIONS HEREON ARE PROVIDED AS STANDARD CONSTRUCTION DETAILS WITHIN LINDON CITY. DEVIATION FROM THIS DOCUMENT REQUIRES APPROVAL OF LINDON CITY, LINDON CITY CORPORATION AND J-U-B ENGINEERS CAN NOT BE HELD LIABLE FOR MISUSE OR CHANGES REGARDING THIS DOCUMENT.

REVISION

NO.	DESCRIPTION	BY	APR	DATE
1	ADDED CURB RAMP AT END OF STUB ROAD & NOTE 7	SAC	MLC	09/18/08
2	ADDED NOTES REGARDING SENSITIVE AREA DISTRICT 3 (AKA "THE HOLLOW")	MDG	MDG	10/06/19

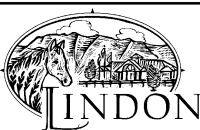

HAMMERHEAD
TURN AROUNDS

LINDON CITY
100 NORTH STATE

STANDARD
DRAWING
NUMBER:

8b

CAD DWG: LC StdDwg.dgn
PLOT SCALE: 1:000
DRAWN BY: SAC
DESIGN BY: MLC
CHECKED BY: MLC
ADOPTED DATE: 06/01/20