

Project: 14-305
 Title: Line Replacement
 Drawing: Overall Site Plan
 Date: 8/20/15
 Scale: 1" = 100'
 Sheet: 14-305-14

GENERAL NOTES

1. The CONTRACTOR shall contain his operations to permit traffic through and across construction of any existing roadways at all times. The CONTRACTOR shall erect warning signs, flashing lights, and barricades in compliance with the current version of the Manual on Uniform Traffic Control Devices to ensure safety. The CONTRACTOR shall limit the extent of trench to remain open overnight and on weekends to less than 50 feet.
2. The CONTRACTOR will be required to notify all of the utility companies prior to the beginning of construction and should request that any existing lines be flagged.
3. The utilities (water, gas, telephone, electrical, etc.) as located on the plans, are approximate locations only. The CONTRACTOR shall exercise extreme caution during trenching operations to avoid damaging these lines. The CONTRACTOR shall coordinate any trenching operations with utility companies to avoid any damage to the lines. If any lines are damaged, they shall be replaced at the CONTRACTOR'S expense.
4. The CONTRACTOR shall notify the utility companies 24 hours prior to the beginning of any construction work near buried utility lines.
5. The CONTRACTOR shall restore all ditches, swales, road shoulders, pavement entrances, and banks to their original slopes and grades. Where existing entrance pipe, drainage pipe, sidewalks, signs, mailboxes, fences, etc. conflict with the proposed work herein, they shall be removed and replaced or reset. The replacement of all the aforementioned items, including trees and shrubs shall be considered **SUBSIDIARY** to the work being performed.
6. Positive drainage shall be provided for all areas on or near spoil areas. Natural drainage ways shall be maintained.
7. Where removal of existing fences parallel to the construction is deemed necessary by the CONTRACTOR, the CONTRACTOR shall coordinate removal with adjacent property owners. All removal and resetting of fences will not be paid for separately and shall be considered **SUBSIDIARY** to the work being performed.
8. The CONTRACTOR shall avoid removal or trimming of any trees where possible. Where the CONTRACTOR believes the removal and trimming is unavoidable, he shall coordinate such work with the CITY prior to proceeding.
9. At all roadway and alley intersections where sidewalk is removed to facilitate construction, the new sidewalk will be installed with handicap ramps meeting current ADA requirements.
10. Construction Stakes: CONTRACTOR shall be required to set all construction stakes and locate any property pins required to allow for construction in the easements shown on the plans. All reference points and project stakes shall be the responsibility of the CONTRACTOR.
11. All valves abandoned in place shall be closed and capped where possible. Valve box risers on all abandoned valves shall be removed and void shall be filled with flowable fill to bottom of existing pavement. Flowable fill shall be **SUBSIDIARY** to abandonment. Removed pavement shall be replaced with pavement of similar type.

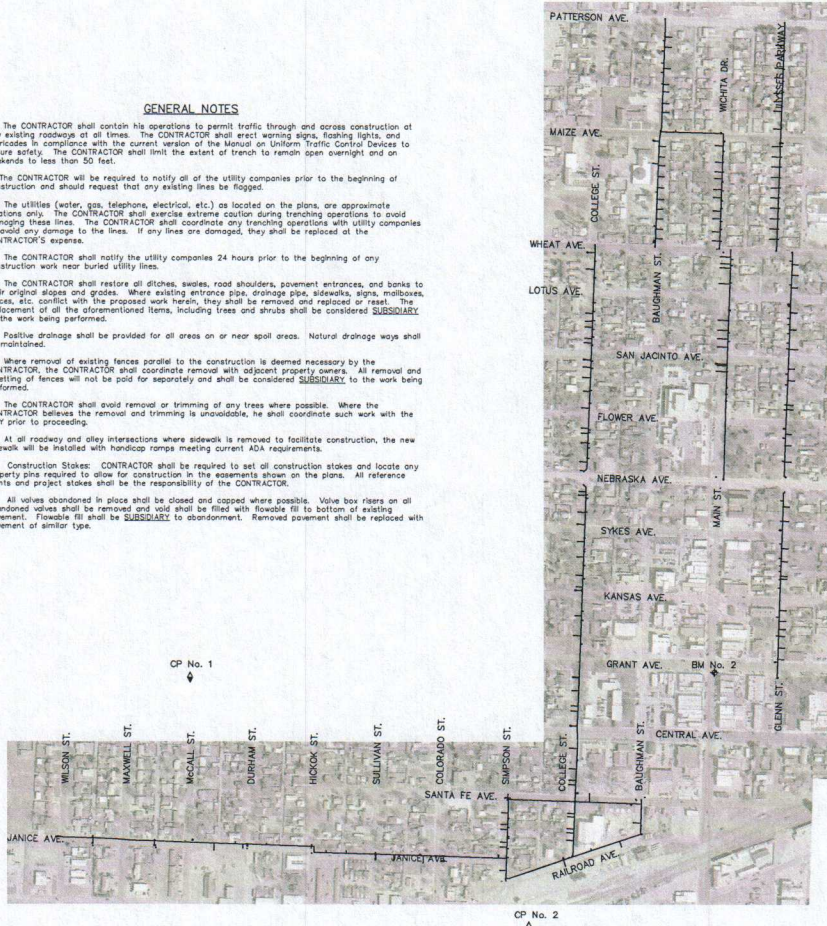

HORIZONTAL CONTROL DATA

- CP No. 1: Bar w/ Cap "E3 Control Point" Located at McCall and Grant N 10088.21 E 8996.73
- CP No. 2: Bar w/ Cap "E3 Control Point" Located S of RR, E of Simpson N 8423.06 E 1469.50
- BM No. 1: USGS Benchmark "14LS-07" located at the Ulysses Airport N 14984.50 E 8197.84
- BM No. 2: Local Benchmark located at the SE corner of Grant and Main N 10000.00 E 10000.00



EARLES ENGINEERING & INSPECTION, INC. Engineers - Surveyors - Construction Inspectors 115 S. 10th Smith Center, KS 67151 (785) 339-1267 Fax: (785) 339-1268		22463 8/20/15 Surveyor License No. 22463 License Expires 8/20/15
Date: JSM Drawn by: AMR Checked by: JSM Scale: 8-20-15 Title: 14-305 Sheet: 14	OVERALL SITE PLAN Ulysses, Kansas	