

Nine Patch Stars

Quilt is 48" x 63½".

Supplies

Blocks and Binding: 12 Fat Quarters*

Background and Border: 2¾ yards

Backing: 4 yards

*Fat Quarter = 18" x 22"

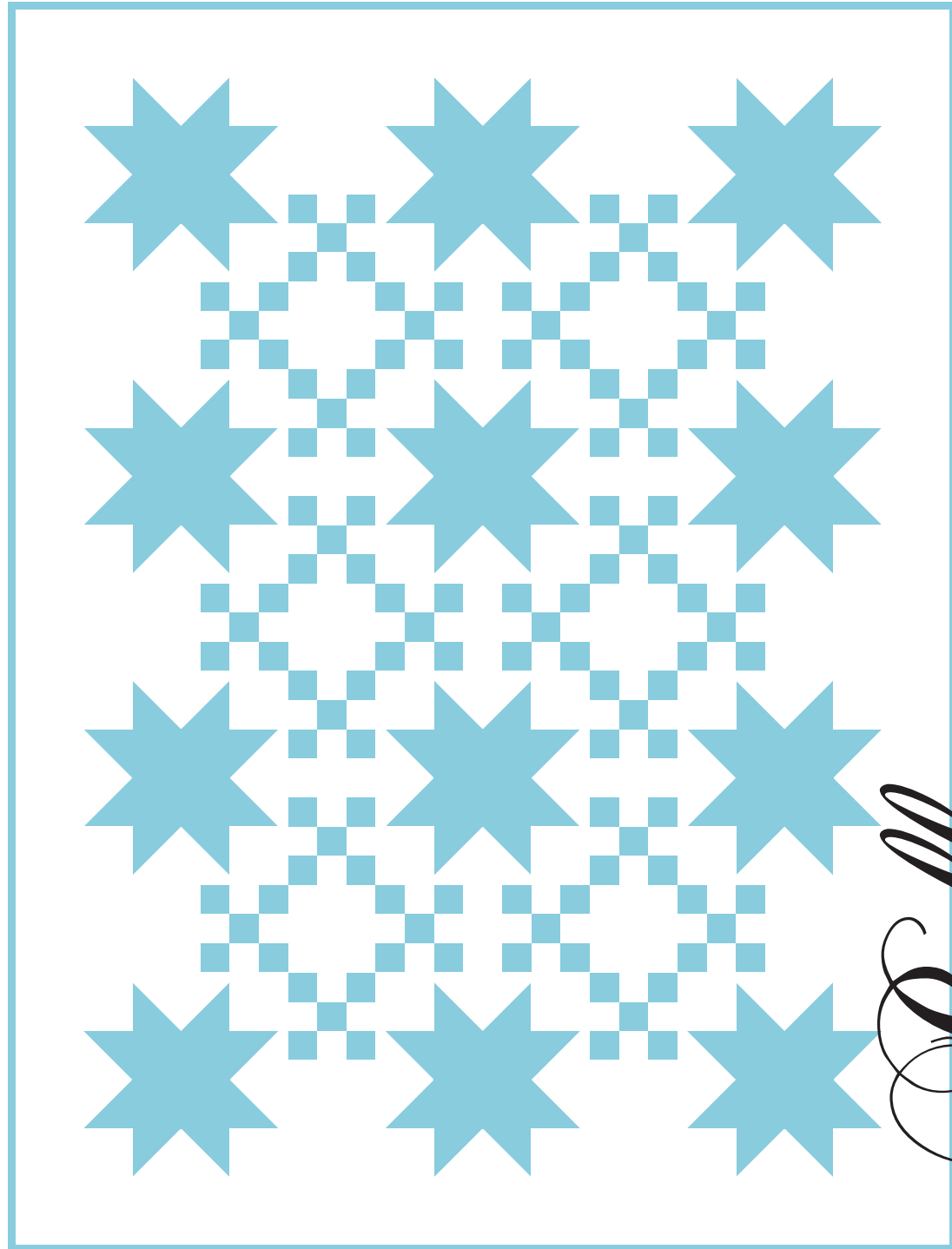

moda
Bella[™]
Solids

12 pack Nine Patch Stars
Quilt is 48" x 63½".
Which colors will you choose?



moda

MODAFABRICS.COM

BSPK1409 — SUGGESTED RETAIL \$6.00

- 3 Arrange and sew 3 stars and 2 block As as shown to make row A. Make 2. Arrange and sew 2 block As, 1 block B, and 2-5" background squares as shown to make row B. Make 3. Arrange and sew 3 stars and 2 block Bs as shown to make row C. Make 2. Join the rows.

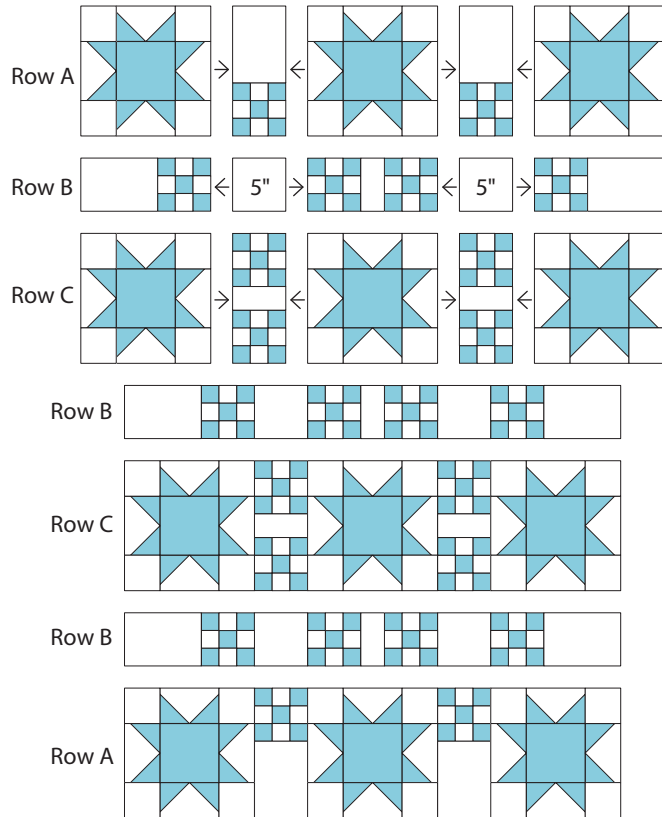

- 4 Sew the $3\frac{1}{2}$ " x 58" background strip to the quilt sides. Sew the $3\frac{1}{2}$ " x $48\frac{1}{2}$ " background strip to the top and bottom. Sew the binding strips end to end. Layer, quilt and bind.

moda

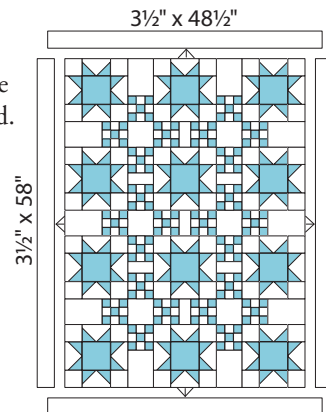

Nine Patch Stars

Quilt is 48" x $63\frac{1}{2}$ ".

Cutting

Blocks and Binding

From EACH of the 12 Fat Quarters cut

1- $5\frac{1}{2}$ " x 22" strip

From the strip, cut 1- $5\frac{1}{2}$ " square and 3-3" squares

1-3" x 22" strip

From the strip, cut 5-3" squares

1- $2\frac{1}{2}$ " x 22" strip for binding

2-2" x 22" strips (24 strips total, 11 are extra)

Background and Borders

3-5" x width of fabric strips

From the strips, cut 6-5" squares, 10-5" x 7", and 7-5" x $2\frac{1}{2}$ " rectangles

18- $3\frac{1}{2}$ " x width of fabric strips

From 12 strips, cut 48- $3\frac{1}{2}$ " squares and 48- $3\frac{1}{2}$ " x $5\frac{1}{2}$ " rectangles

Sew 6 strips end to end. From this long strip, cut 2- $3\frac{1}{2}$ " x 58" and

2- $3\frac{1}{2}$ " x $48\frac{1}{2}$ " borders.

moda

Construction Use $\frac{1}{4}$ " seams. Press in the direction of the arrows in the diagrams.

1 Stars

(A) Select 1-5½" and 8-3" matching squares for one star.

Draw a diagonal line from corner to corner on the wrong side of the 8-3" squares. Layer a marked square right sides together on one end of a 3½" x 5½" background rectangle as shown. Sew on the diagonal line. Trim the marked square ¼" from the sewn line. Press to the corner to form a triangle. Repeat on the other end of the rectangle. Repeat to make 4 star point units.

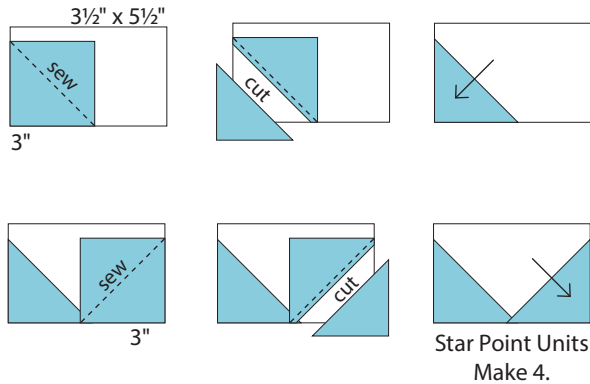

(B) Arrange and sew 4-3½" background squares, 4 star point units and 1-5½" matching star square to make one star as shown. Repeat to make 12 stars, 1 from each of the 12 Fat Quarters.

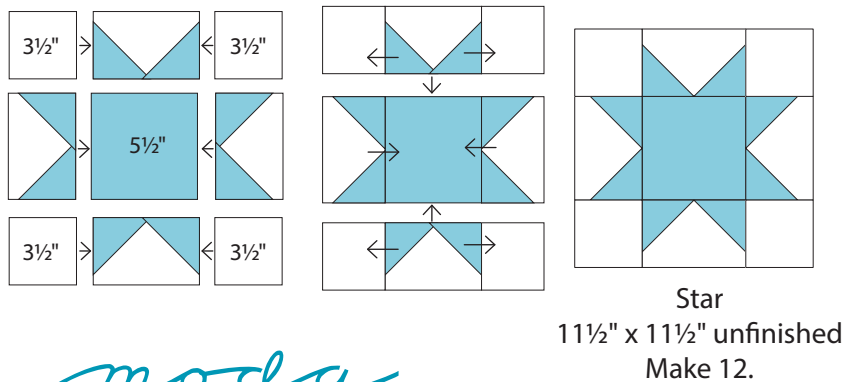

moda

2 Nine Patches (scrappy), Blocks A & B

(A) Join 2-2" x 22" star and 1-2" x 22" background strip as shown. Make 5 strip sets. Cut into 48-2" wide segments. Join 1-2" x 22" star and 2-2" x 22" background strips as shown. Make 3 strip sets. Cut into 24-2" wide segments. Join segments as shown units to make one nine patch. Repeat to make 24 nine patches.

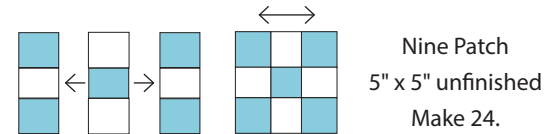
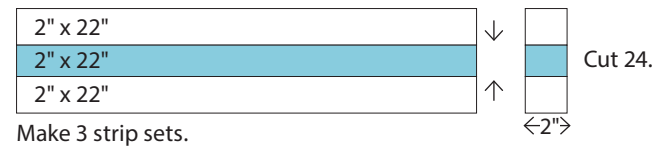
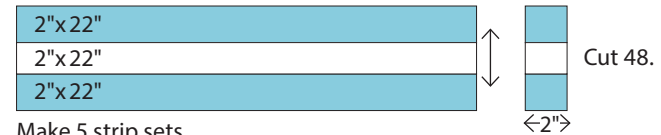

(B) Join one nine patch and 1-5" x 7" background rectangle as shown. Repeat to make 10 block As.

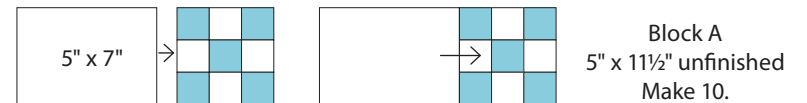

(C) Join 2 nine patches and 1-5" x 2½" background rectangle as shown. Repeat to make 7 block Bs.

