

Breezy Batiks

moda

Quilt is 66" x 66".

Fabric Requirements

Blocks:

- 1 Breezy Batiks Charm Pack™
(42-5" squares) (4323PP)
- 1 Breezy Batiks Jelly Roll™
(40-2½" x WOF strips) (4323JR)

Background:

1⅞ yards (4323 30)

Border and Binding:

1⅞ yards (4323 35)

Backing: 4 yards

Featuring Breezy Batiks from Moda.



Quilt is 66" x 66".

moda

MODAFABRICS.COM

PS4323 — SUGGESTED RETAIL \$6.00



Breezy Batiks *moda*
Quilt is 66" x 66".

3 Assemble the quilt

- Sew the chain, star A, and star B blocks in rows as shown. Press away from the star blocks. Sew the rows together.
- Add the $2\text{-}2\frac{1}{2}\text{''} \times 50\frac{1}{2}\text{''}$ inner border strips to the sides of the quilt. Add the $2\text{-}2\frac{1}{2}\text{''} \times 54\frac{1}{2}\text{''}$ inner border strips to the top and the bottom.
- Add the $2\text{-}6\frac{1}{2}\text{''} \times 54\frac{1}{2}\text{''}$ border strips to the sides of the quilt. Add the $2\text{-}6\frac{1}{2}\text{''} \times 66\frac{1}{2}\text{''}$ border strips to the top and the bottom.

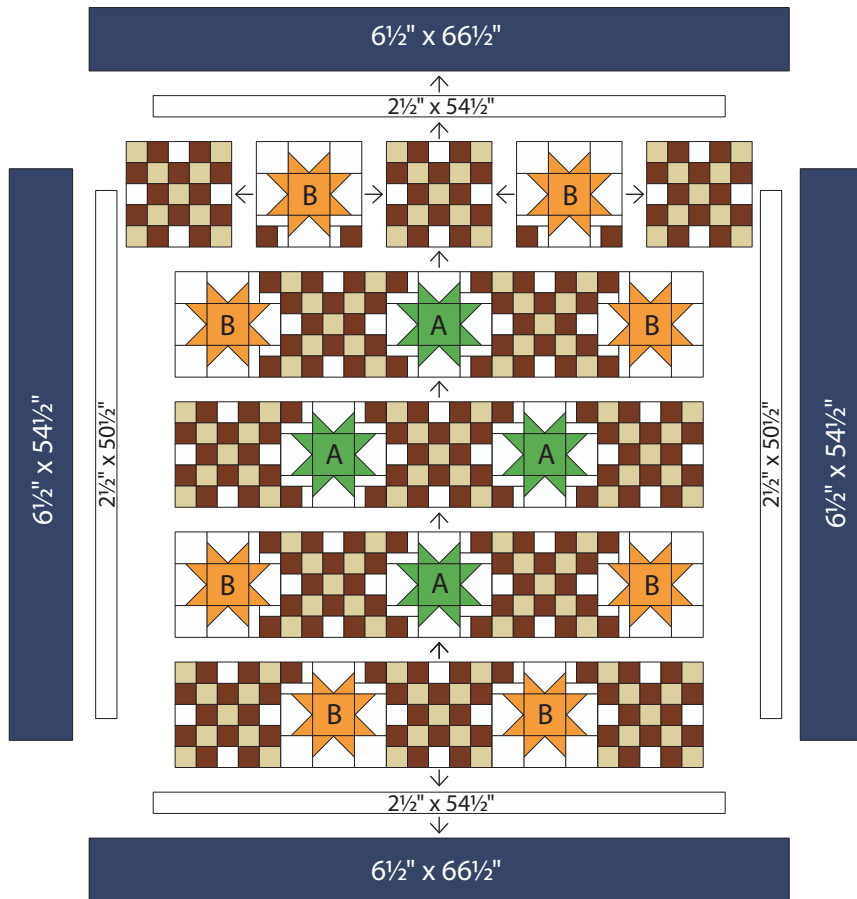

moda

4 Layer, quilt as desired and bind. ENJOY!

Breezy Batiks

Quilt is 66" x 66".
by Moda

Cutting

Breezy Batiks Charm Pack™: (You will have extra squares.)

Select 12-5" squares for the stars in the quilt.

Trim the squares to $4\frac{1}{2}\text{''} \times 4\frac{1}{2}\text{''}$. You now have 12- $4\frac{1}{2}\text{''}$ star centers.

From the remaining darker squares, cut a total of assorted 32- $2\frac{1}{2}\text{''}$ squares.

Breezy Batiks Jelly Roll™: (You will have extra strips.)

Cut $12\text{-}2\frac{1}{2}\text{''} \times 22\text{''}$ strips that match the $12\text{-}4\frac{1}{2}\text{''}$ star center prints.

Cut the $2\frac{1}{2}\text{''} \times 22\text{''}$ strips into 8- $2\frac{1}{2}\text{''}$ squares.

You now have 8 *star sets* (1- $4\frac{1}{2}\text{''}$ star center and matching 8- $2\frac{1}{2}\text{''}$ squares).

Cut the $18\text{-}2\frac{1}{2}\text{''} \times 22\text{''}$ strips from the lightest prints. (18-light strips)

Cut the $24\text{-}2\frac{1}{2}\text{''} \times 22\text{''}$ strips from the darker prints. (24-dark strips)

Background and Inner Border:

$9\text{-}3\frac{1}{2}\text{''}$ x width of fabric strips

From the strips, cut 16- $3\frac{1}{2}\text{''}$ squares, 48- $3\frac{1}{2}\text{''} \times 4\frac{1}{2}\text{''}$, 32- $3\frac{1}{2}\text{''} \times 1\frac{1}{2}\text{''}$

$12\text{-}2\frac{1}{2}\text{''}$ x width of fabric strips

Cut 4 strips in half to make 8- $2\frac{1}{2}\text{''} \times 22\text{''}$ strips (8-background strips)

From 2 strips, cut 32- $2\frac{1}{2}\text{''} \times 1\frac{1}{2}\text{''}$ rectangles.

Sew 6 strips together end to end.

From this long strip, cut $2\text{-}2\frac{1}{2}\text{''} \times 54\frac{1}{2}\text{''}$ and $2\text{-}2\frac{1}{2}\text{''} \times 50\frac{1}{2}\text{''}$ inner border strips

Border and Binding:

$7\text{-}2\frac{1}{2}\text{''}$ x width of fabric strips

Sew the 7 strips end to end using a diagonal seam to make the binding.

$7\text{-}6\frac{1}{2}\text{''}$ x width of fabric strips

Sew 3 strips end to end. From this strip cut $2\text{-}6\frac{1}{2}\text{''} \times 54\frac{1}{2}\text{''}$ strips.

Sew 4 strips end to end. From this strip cut $2\text{-}6\frac{1}{2}\text{''} \times 66\frac{1}{2}\text{''}$ strips.

moda

Construction

Use $\frac{1}{4}$ " seams and press in the direction of the arrows.

You will make 2 types of star blocks, 4 of block A and 8 of block B. See the diagrams in C and D. Decide which star sets will be the A stars and the B stars.

1 Star Blocks A and B

- (A) **Star Points:** Select one star set. Draw a diagonal line, from corner to corner, on the wrong side of the 8 matching $2\frac{1}{2}$ " squares. Layer one marked square, right sides together, on $1-4\frac{1}{2}$ " x $3\frac{1}{2}$ " background rectangle. Sew on the diagonal line. (Press the square to the corner to make sure that it aligns with the edges of the rectangle.) Trim $\frac{1}{4}$ " from the sewn line. Press toward the corner to form a triangle.

Repeat on the opposite end of the rectangle. Make 4.

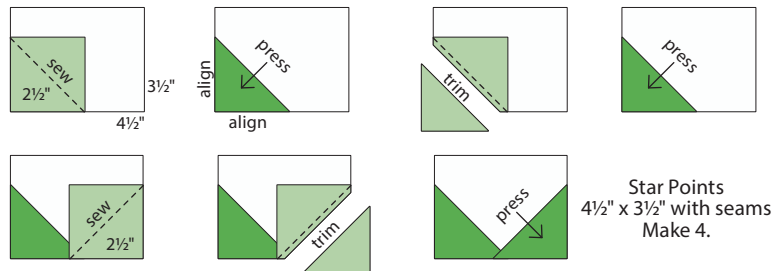

Repeat to make a total of 12 sets of 4 matching star points.

- (B) **Pieced Star Corners:** (Use the $3-2\frac{1}{2}$ " squares cut from the Charm Squares.) Sew $1-1\frac{1}{2}$ " x $2\frac{1}{2}$ " background rectangle to one side of a $2\frac{1}{2}$ " square. Add $1-1\frac{1}{2}$ " x $3\frac{1}{2}$ " background rectangle as shown. Make 32 total.

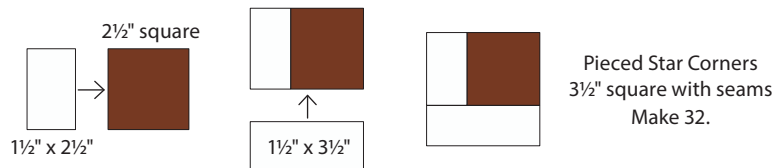

- (C) **Star Block A:** Select 4 matching star points, the matching $4\frac{1}{2}$ " square, and 4 pieced star corners. Sew together in 3 rows as shown. Sew the rows together. Make 4.

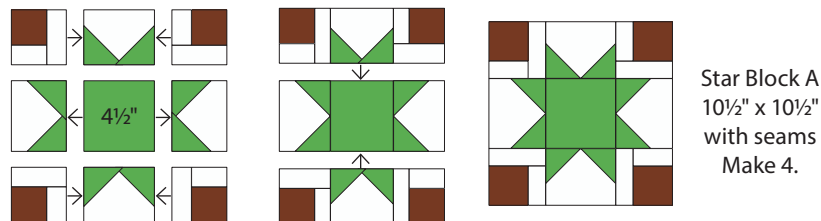

Step 1 continued.

- (D) **Star Block B:** Select 4 matching star points, the matching $4\frac{1}{2}$ " square, 2 pieced star corners, and $2-3\frac{1}{2}$ " background squares. Sew together in 3 rows as shown. Sew the rows together. Make 8.

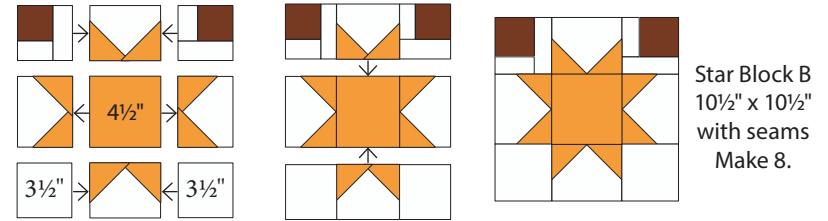

2 Chain Blocks

- (A) **Strip set A:** Sew 2 light, and 2 dark $2\frac{1}{2}$ " x 22" Jelly Roll™ strips, and $1-2\frac{1}{2}$ " x 22" background strip together as shown. Make 4 strip sets. Press toward the dark strips. Cut 26 units, $2\frac{1}{2}$ " wide.

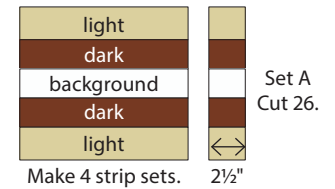

- (B) **Strip set B:** Sew 2 light and 3 dark- $2\frac{1}{2}$ " x 22" Jelly Roll™ strips, together as shown. Press toward the dark strips. Make 4 strip sets. Cut 26 units, $2\frac{1}{2}$ " wide.

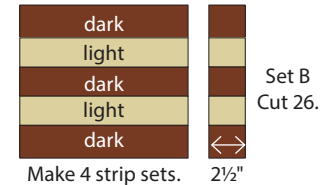

- (C) **Strip set C:** Sew 1 light and 2 dark $2\frac{1}{2}$ " x 22" Jelly Roll™ strips, and $2-2\frac{1}{2}$ " x 22" background strips together as shown. Press toward the dark strips. Make 2 strip sets. Cut 13 units, $2\frac{1}{2}$ " wide.

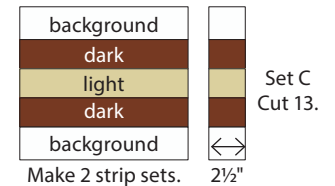

- (D) **Chain Block:** Sew 2-Set A, 2-Set B, and 1-Set C units together as shown to make one chain block. Press toward Set B. Make 13.

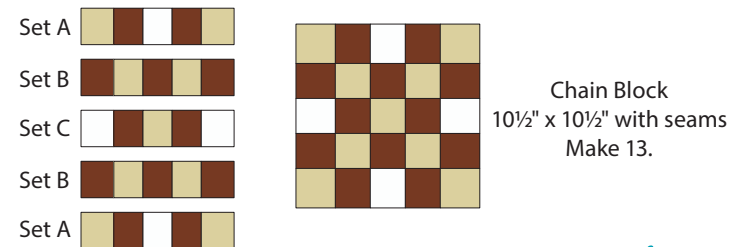

moda