

# Day 2: 12 Days of Christmas with RBD

12" x 12" Finished

rileyblakedesigns.com @rileyblakedesigns

## FABRIC REQUIREMENTS

C440-80 RED (*Fabric 1*)

C120-CLOVER (*Fabric 2*)

C120-TIMBERLINE  
(*Fabric 3*)

C120-RILEYRED (*Fabric 4*)

C120-SAGE (*Fabric 5*)

## CUTTING INSTRUCTIONS

**Fabric 1:**

- A – (2)  $3\frac{1}{2}" \times 3\frac{1}{2}"$  squares

**Fabric 2:**

- B – (4)  $3\frac{1}{2}" \times 3\frac{1}{2}"$  squares

**Fabric 3:**

- C – (4)  $1\frac{1}{2}" \times 6"$  rectangles

**Fabric 4:**

- D – (1)  $1\frac{1}{2}" \times 1\frac{1}{2}"$  square

**Fabric 5:**

- E – (6)  $3\frac{1}{2}" \times 3\frac{1}{2}"$  squares
- F – (4)  $3" \times 3"$  squares
- G – (4)  $1" \times 6"$  rectangles
- H – (4)  $1" \times 5\frac{1}{2}"$  rectangles

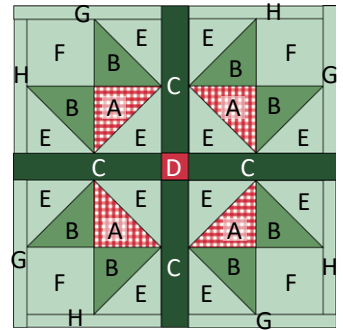

RST = RIGHT SIDES TOGETHER

HST = HALF SQUARE TRIANGLE

Sew all seams RST and with a  $\frac{1}{4}"$  seam allowance. Press seams as desired unless stated otherwise. Dimensions listed in steps are unfinished sizes. Refer to the following general sewing technique as this method is referenced throughout the pattern in its abbreviated form.

## 2-AT-A-TIME HALF SQUARE TRIANGLE METHOD

### INSTRUCTIONS (HST)

Place (2) squares RST. Draw a diagonal line on the wrong side of (1) square. Sew  $\frac{1}{4}"$  on each side of the drawn line. Cut on the drawn line to create (2) HSTs. Press toward the darker fabric. Trim HSTs to the indicated size.

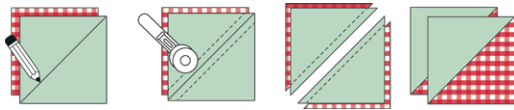

## SEWING INSTRUCTIONS

1. Gather the required pieces and use the 2-at-a-time HST method to make the units shown below, referencing the diagrams for quantity, proper placement, and orientation. Trim each unit to the size indicated.

Make (4)

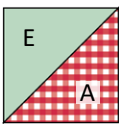

$3" \times 3"$

Make (8)

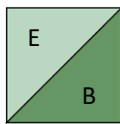

$3" \times 3"$

2. Arrange (1) F-square, (2) E/B HST units, and (1) E/A HST unit as shown below. Sew the square and units together into pairs. Next, sew the pairs together to make (1) Star Point Unit. Repeat to make (4) total units.

Make (4)

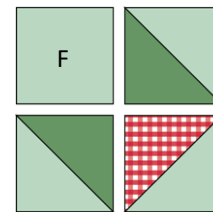

$5\frac{1}{2}" \times 5\frac{1}{2}"$

3. Sew (1) H-rectangle to the left side of (1) Star Point Unit as shown below. Next, sew (1) G-rectangle to the top to make (1) Corner Unit. Repeat to make (4) total units.

Make (4)

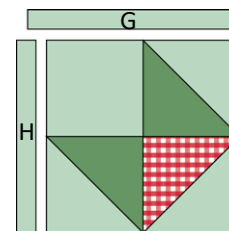

$6" \times 6"$

# Day 2: 12 Days of Christmas with RBD

12" x 12" Finished

rileyblakedesigns.com @rileyblakedesigns

4. Arrange (4) Corner Units, (4) **C**-rectangles, and (1) **D**-square as shown below. Sew the units and pieces together into rows. Next, sew the rows together to make the Day 2 block. The block should measure 12 ½" x 12 ½" unfinished.

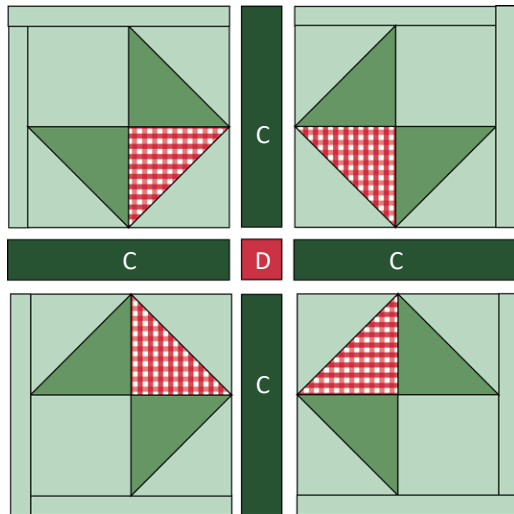

12 ½" x 12 ½"

*Your block is complete!*

