

Improved Options

Quick Easy Editing Options

- The file, NA869 will continue to be used for this exercise.
- Hold the Alt key and **right** click on one of the leaves.
- A list of pop-up options appears.
- This makes it easy to perform some basic functions in the software without opening menus or needing to know the short-cut keys.

Notes:

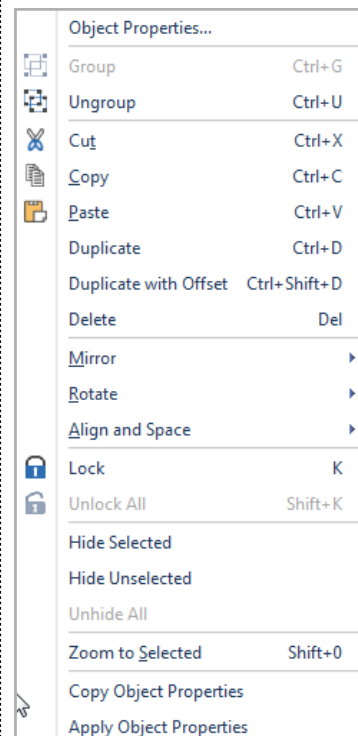

Background Fabric Textures & Colors

- Go to Design> Background. This menu has been expanded.
- Place a dot in front of Factory Fabric.
- Click on the drop-down arrow and choose Fleecy.
- Choose a Fabric color and press OK.

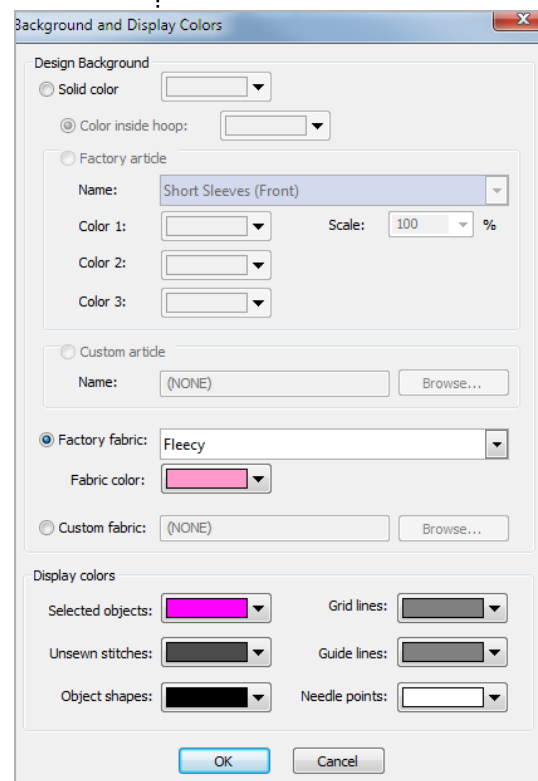



Hoops

- Right click on the Show Hoop icon.
- The hoop dialog box has been streamlined so users can now isolate the machine type and the foot.
- No more long lists to scroll through!
- E16 hoops are also included!
- Click OK.

Notes:

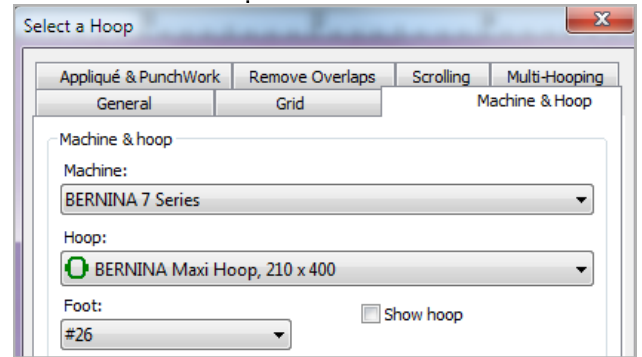

Templates

- Click on Show Hoop Template.
- Hoop templates are now included for each type of BERNINA hoop.
- Click on Show Grid.
- If you choose the grid, the template turns off and vice versa.
- Click it again to hide the grid.

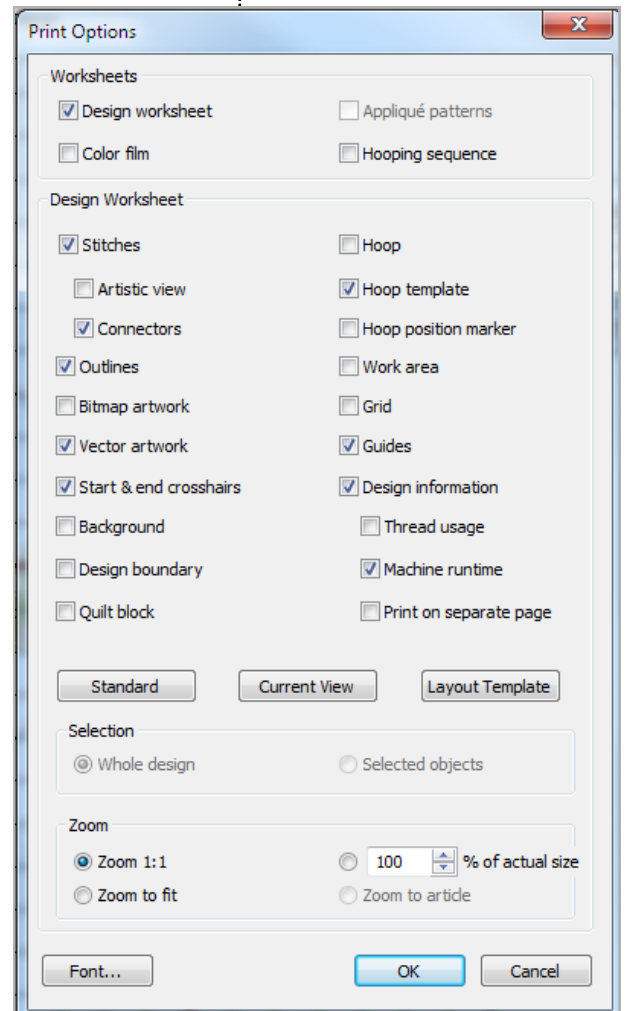

Printed Templates

- Click on Print Preview.
- Click on Options.
- There are many options to choose from so you can customize exactly what you wish to see on the printed template.
- Choose a few options and click OK.
- Close Print Preview and save the file as Improved Options.

Options...

made to create **BERNINA**