



SCALE: 1" = 800'

ANNEXATION TO GARDEN CITY

SECTIONS 5, 6, 8, 16, 17
TOWNSHIP 14 NORTH, RANGE 5 EAST
&
SECTIONS 31 & 32
TOWNSHIP 15 NORTH, RANGE 5 EAST
SALT LAKE BASE & MERIDIAN

DATE: 2/08/12
DRAWN BY: JSH
JOB NUMBER: 12-009
SCALE: 1" = 200'

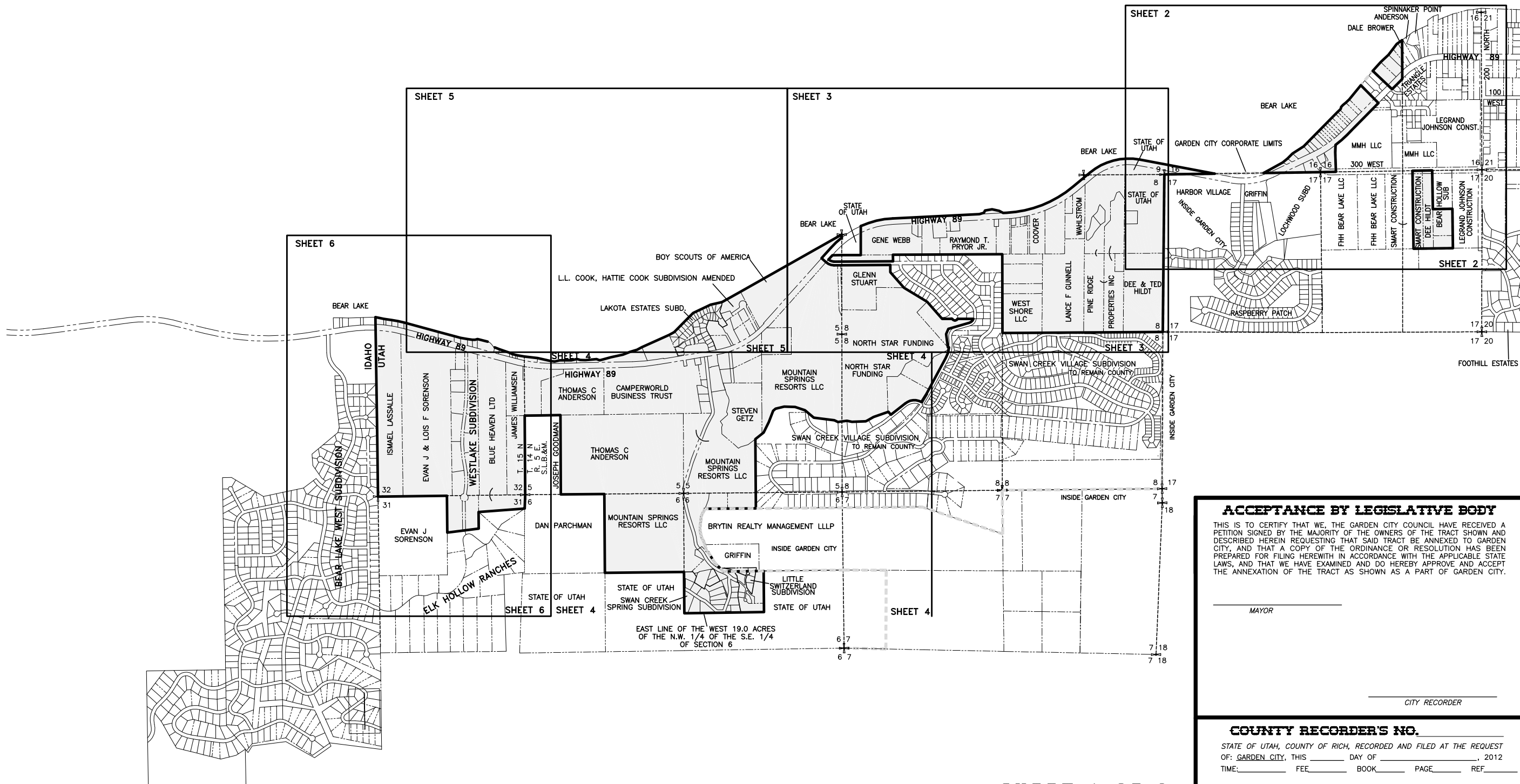

ANNEXATION PLAT
FOR
GARDEN CITY

ACCEPTANCE BY LEGISLATIVE BODY

THIS IS TO CERTIFY THAT WE, THE GARDEN CITY COUNCIL HAVE RECEIVED A PETITION SIGNED BY THE MAJORITY OF THE OWNERS OF THE TRACT SHOWN AND DESCRIBED HEREIN REQUESTING THAT SAID TRACT BE ANNEXED TO GARDEN CITY, AND THAT A COPY OF THE ORDINANCE OR RESOLUTION HAS BEEN PREPARED FOR FILING HERewith IN ACCORDANCE WITH THE APPLICABLE STATE LAWS, AND THAT WE HAVE EXAMINED AND DO HEREBY APPROVE AND ACCEPT THE ANNEXATION OF THE TRACT AS SHOWN AS A PART OF GARDEN CITY.

MAYOR

CITY RECORDER

COUNTY RECORDER'S NO.

STATE OF UTAH, COUNTY OF RICH, RECORDED AND FILED AT THE REQUEST OF: GARDEN CITY, THIS _____ DAY OF _____, 2012
TIME: _____ FEE: _____ BOOK: _____ PAGE: _____ REF: _____

COUNTY RECORDER

JSH
SURVEYING & DRAFTING INC.
P.O. BOX 300 • WELLSVILLE, UTAH 84339
(435) 245-9090 * TOLL FREE 1-888-420-0268