

# City of Douglass

January, 2016

Postal Patron  
Douglass, KS 67039

**The City's Sewer Rehabilitation project is scheduled to begin on Monday, January 11, 2016.** A map with area and schedule of work, along with a sample notice to residents is included in this newsletter. If you have questions, please call City Hall at 316-747-2109.

## INSIDE THIS ISSUE:

<u>Utility Payment Options</u>	2
<u>Free Pet Tag Information</u>	2
<u>Street Addresses</u>	2
<u>Ice &amp; Snow Removal</u>	2
<u>Sewer Project Info</u>	3-4
<u>Library Information</u>	5
<u>Sr. Center Information</u>	6-8

## Lifeguards needed!

The City is preparing to interview and hire lifeguards for the 2016 summer season—interviewing will begin during the first two weeks of January. Employment applications are available at City Hall and the Douglass High School Office. If you have questions, please call City Hall at 747 -2109.

## Congratulations to 2015 Light Up Douglass Winners!

Kenneth Phillips—Most Unusual Display  
Glenda Gulick - Most Traditional Display

## City Council:

Larry Ramsey - Mayor  
Jo Jennings - President  
Sheri Cagle  
Johna Carr  
Judy Hatfield  
Jenni O'Crowley



## Utility Billing Payment Options

*Did you know.....*

- The City offers ACH withdrawal option for automated utility bill pay?
- Utility bills can be paid by phone with a debit or credit card?
- A debit or credit card can be kept on file to be processed on the day of your choosing for utility bill payment?

Call 747-2109 or come by City Hall today to establish one of these services to avoid any service interruption or reconnection fees!

**Free pet tags through February—**  
Please register your pets! Registration helps to make sure that your pet can be returned to you in a timely manner if it gets out.

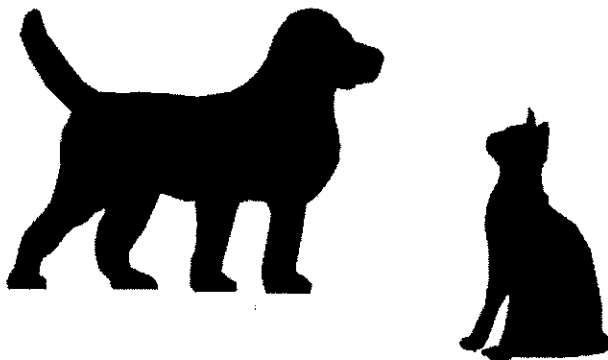

**PLEASE IDENTIFY YOUR  
HOME OR BUSINESS**

**WITH A VISIBLE  
STREET ADDRESS NUMBER!**

Is your home or business clearly numbered and identified? Please check! In order for deliveries and more importantly, emergency personnel, to be able to locate and respond to your needs, appropriate numbering of homes and businesses is absolutely critical. For a complete copy of Ordinance 598, which addresses numbering all buildings including duplexes and apartments and trailer courts, please call or come by City Hall.

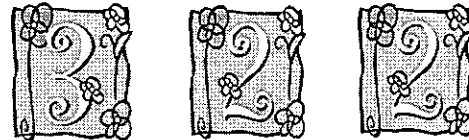

**Ice and Snow Removal:** It won't be long until winter arrives, bringing with it all the beauty and headaches of ice and snow. As a reminder, the City's policy for ice and snow removal is listed below.

The City's snow removal policy is to remove snow and treat for ice on all streets in the City. The intent is to make the streets as safe as possible during winter storm events. The top priorities are commercial areas, followed by residential streets. Please park cars off the streets where possible so snow can be plowed to the curb and edge of pavement. The City is not responsible for removing snow that has been plowed into driveway areas. Cul-de-sacs are difficult in terms of snow removal and may not receive the same treatment as other streets. First Street through town is maintained by Butler County. Highway 77 going through town is maintained by the Kansas Department of Transportation.

**NORTH**



# PROJECT VICINITY MAP

CITY OF DOUGLASS - PHASE 2, SANITARY SEWER RECONSTRUCTION

**LOCATION 1**

**LOCATION 2**  
January 20th  
- 27th

January 4th - 19th

**LOCATION 5**  
February 27th  
- March 23rd

**LOCATION 4**  
February 17th  
- 26th

**LOCATION 3**  
January 28th - February 16th

**LOCATION 7**  
April 1st - 15th

**LOCATION 6**  
March 24th - 31st

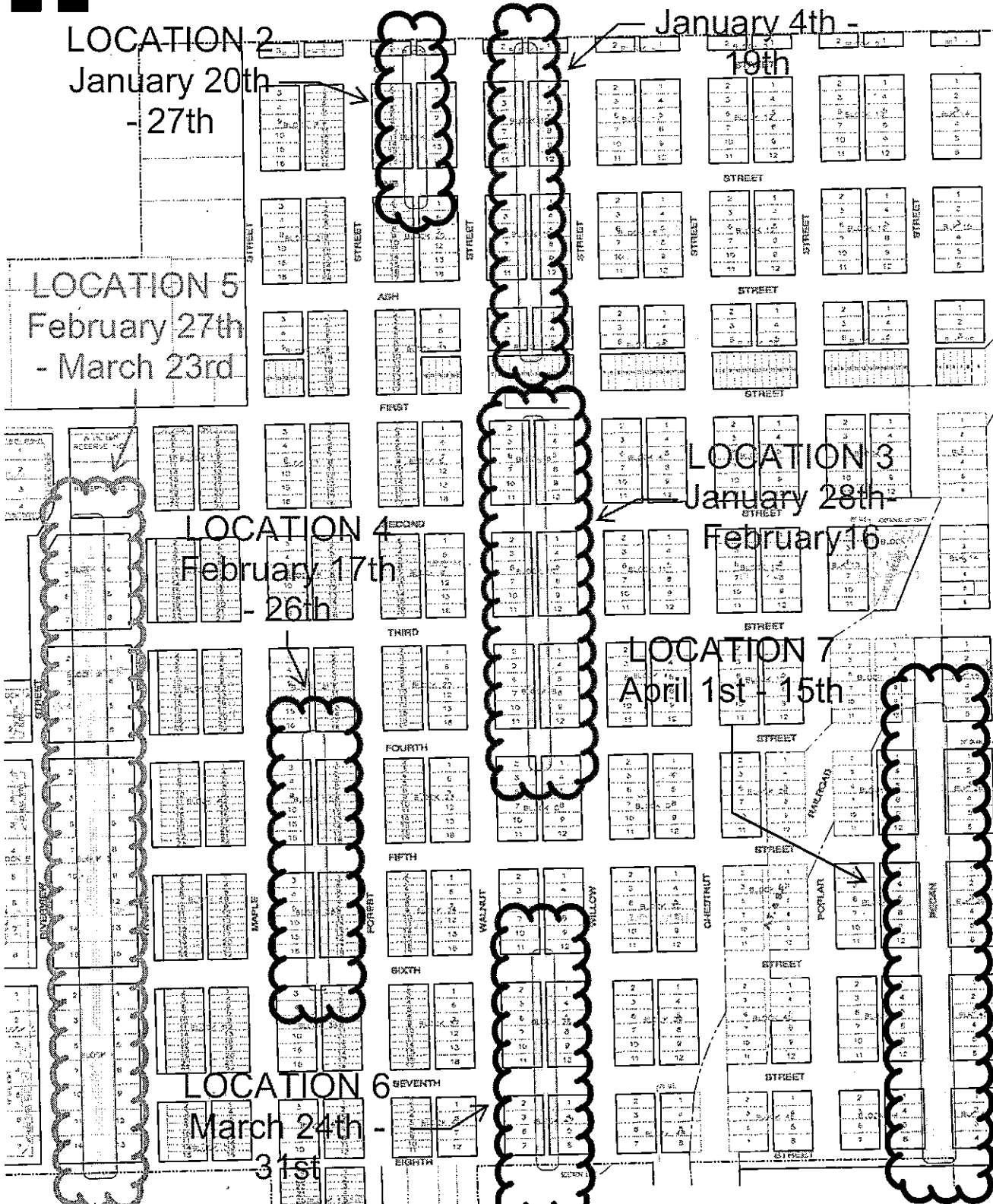

Date Prepared: 12/30/10

Prepared By:  
**YOUNG & ASSOCIATES, P.A.**  
Professional Civil Engineering Consultants  
100 South Georgia, Derby, Kansas 67037  
tele: (316) 788-2552, fax: (316) 788-4408, email: engineering@yopa.com

**LEGEND:**

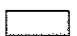
 PROJECT AREAS



**ALAN'S EXCAVATING, INC.**  
420 LUNGER ROAD  
AUGUSTA, KANSAS 67010  
PHONE: 316-775-5970  
FAX: 316-775-5096



## **NOTICE TO RESIDENTS**

*(Sample)*

ALAN'S EXCAVATING, INC. WILL BE RECONSTRUCTING THE SANITARY SEWER LINE THAT SERVICES YOUR PROPERTY FROM XX/XX/XXXX TO XX/XX/XXXX. WORK WILL BE TAKING PLACE DURING THE DAY AND ALL CONNECTIONS WILL BE RESTORED AT THE END OF EACH WORKING DAY. THROUGHOUT THE DAY, WE ASK THAT YOU MINIMIZE SEWER USAGE AS MUCH AS POSSIBLE IN ORDER TO REDUCE THE CHANCES OF SEWER BACKUP. SHOULD YOU HAVE ANY QUESTIONS, PLEASE FEEL FREE TO CONTACT OUR OFFICE AT THE TELEPHONE NUMBER AT THE TOP OF THIS PAGE. THANK YOU IN ADVANCE FOR YOUR PATIENCE DURING THE DURATION OF THIS PROJECT.

## Exciting news for the Douglass Public Library

We are excited to announce that the library will be getting a new automation system in the early part of 2016. We will need all patrons to update their information after the first of the year because we will have the capability to e-mail or text you reminders and overdue notices.



### Story Time at the Douglass Public Library

Join us at 10:00 on the second Wednesday of every month for Story Time. Children ages 1-5 welcome with adult supervision. We will listen to stories, sing, and do crafts. Call the library at 746-2600 with any questions.

## Legó Club

**Have you heard that we started a Lego club? It meets the fourth Monday of each month from 5-6 PM. The club is for Pre-K through 5<sup>th</sup> grade. Any child under the age of 7 must be accompanied and assisted by an adult over the age of 21. No sign-ups are necessary.**

### Come see the wonderful new things!

We have had some wonderful additions to the library thanks to memorials in honor of loved ones. We have added a new conference table and chairs, three pictures above the patron computers, and many new books. Thank you to those who made the memorial to the library in honor of your loved one.

If you have not been in new to see our new checkout counter and work area please stop by, it's beautiful! Thank you to Friends of the Library for contributing toward the purchase of the counter.

# The Douglass Senior Center

December 17, 2015

This past year, or two, we have tried different things to get other members of the community involved. Of course we have our daily noon meals and our meals on wheels' program along with two nights a month with covered dishes and cards. However, these numbers are slowly decreasing. We have our exercise program two days a week which is doing very well. Our supper fundraisers on the five Monday months have done very well. For 2016 we are planning, thanks to Mary Lou Mauk, to have a supper time fundraiser on the last Monday of every month. It's just that our normal daily and monthly activities could use something more that might bring more people to be a part of our wonderful facility. I sat one day looking over the crowd and thought, if we took away everyone that was over eighty years of age there wouldn't be very many left... The dilemma is how do we get some of the younger seniors to come? We have great food for a great price... We have lowered the membership age to 50, so please consider getting involved if you can... Speaking of memberships, in years past we gave out lifetime memberships. However, according to the Department of Aging regulations they must be renewed every year. Therefore, we must renew your membership each year. We are asking for a one-dollar donation for yearly memberships. However, if you do not want to donate a dollar because of having a lifetime membership in the past, that's okay, we will just give you a new membership card each year for free.

We have constantly been trying to cut cost where we can so as to break even. However, the last eight years or so we always seem to be in the red at the years' end. One reason is the high increase of the cost of groceries and utilities. Another is the low interest rate on an endowment fund we have. We have a great facility along with some wonderful people that make it function so well and we, as a board, will do all that we can to keep it going for the next generations that follow. We appreciate the donations we received this past year. We are grateful for those that rented our facility the past year. The cost to rent it is seventy-five dollars plus a fifty-dollar cleaning deposit. We also appreciate the help of the City of Douglass. They pay the first one hundred dollars of our water bill each month, as well as keeping the parking lot clear of snow in the winter. The levy money we receive on a quarterly basis, is also vital to the operation of the center and we are very grateful for that.

We could always use more volunteers. If you are able to volunteer in any given area, working in the kitchen, serving, doing office or computer work, whether in the day time or during our evening fundraisers, please call Peggy Bannon, our director, and let her know so she can schedule you...

Our thanks go out to all that make up this great community and we wish you all a Merry Christmas and a Happy New Year.

On Behalf of the Board of Directors,  
Keith Cross

# Douglass Senior Center Menu Calendar

Jan 2016

Sunday Monday Tuesday Wednesday Thursday Friday Saturday

Meals are \$5.00, Dine in, Carry out or Delivery.  
Please call 316-746-3227 by 9:00 AM to reserve your meal. Noon meal only, Mon. – Fri.

Sunday	Monday	Tuesday	Wednesday	Thursday	Friday	Saturday
3	4 <b>BBQ Ribs</b> Baked Pots Salad, Veggies Dessert	5 <b>Pork &amp; Scallop Potatoes</b> Salad, Veggies Dessert Rolls	6 <b>Fish Sandwich</b> Tater Tots Coleslaw, Veggies Ice Cream	7 <b>Fried Chicken</b> Potatoes & Gravy Veggie Salad Rolls & Dessert	8 <b>Buffet</b>	9
10	11 <b>Hamb. Stew</b> Salad, Rolls Dessert	12 <b>Chicken Fritters</b> Pots & gravy Salad, Veggies Dessert	13 <b>Breakfast</b> Cinnamon Rolls OJ	14 <b>Beef &amp; Noodles</b> Salad, Veggies Dessert	15 <b>Buffet</b>	16 <b>Breakfast</b> 7:00-9:30 \$4.00
17	18 <b>Chili with</b> All the fixing's Dessert	19 <b>Smothered Pork Chops</b> Potatoes & Gravy Veggies, Dessert	20 <b>Hamburger's</b> Fries Salad, Veggies Dessert	21 <b>Fried Chicken</b> Potatoes & Gravy Veggies Salad Rolls & Dessert	22 <b>Buffet</b>	23
24	25 <b>Taco's</b> Refried Beans, Mexican Rice Dessert	26 <b>Beef Veg. Soup</b> Grilled Ham & Cheese Jello Dessert	27 <b>Turkey</b> Potatoes & Gravy Salad, Veggies Dessert	28 <b>Ham</b> Potatoes & Gravy Veggies, Salad Dessert & Rolls	29 <b>Buffet</b>	30
31			Menu subject to change		Stop in for coffee any morning after 8:00	

## Douglass Senior Center Activities Calendar Jan 2016

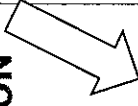
Sunday	Monday	Tuesday	Wednesday	Thursday	Friday	Saturday
					<b>1</b>	<b>2</b>
All are welcome! We would invite you to come join us any time you can...						
<b>3</b>	<b>4</b> <b>Finger Food &amp; Cards</b> 6:00 PM	<b>5</b> <b>Exercise</b> At 9:00 AM <b>Quilting</b> At 1:00 PM	<b>6</b>	<b>7</b> <b>Cards</b>	<b>8</b> <b>Exercise</b> At 9:00 AM	<b>9</b>
<b>10</b>	<b>11</b>	<b>12</b> <b>Exercise</b> At 9:00 AM <b>Quilting</b> At 1:00 PM	<b>13</b> <b>ELECTION DAY</b> 	<b>14</b> <b>Cards</b>	<b>15</b> <b>Exercise</b> At 9:00 AM	<b>16</b> <b>Breakfast</b> 7:00-9:30 \$4.00
<b>17</b>	<b>18</b> <b>Covered Dish &amp; Cards</b> 6:00 PM	<b>19</b> <b>Exercise</b> At 9:00 AM <b>Quilting</b> At 1:00 PM	<b>20</b> <b>BOARD Meeting</b> 1:00 PM	<b>21</b> <b>Cards</b>	<b>22</b> <b>Exercise</b> At 9:00 AM	<b>23</b>
<b>24</b>	<b>25</b>	<b>26</b> <b>Exercise</b> At 9:00 AM <b>Quilting</b> At 1:00 PM	<b>27</b>	<b>28</b> <b>Cards</b>	<b>29</b> <b>Exercise</b> At 9:00 AM	<b>30</b>
					Stop in for coffee any morning after 8:00	